

HFKS-2G

UNIVERSAL

High precise chuck

PRECISE

Centrifugal force compensation
for highest speed
Maximum precision

FLEXIBLE

Large through hole
Best accessibility



HFKS-2G

INCH
SERRATION

High precision power chucks Ø 210 mm

- Large through hole
- Centrifugal force compensation
- 3 jaws



Application/customer benefits

- Universal use for turning
- Flats on the chuck body for best accessibility with live tools and to reduce the weight
- Wedge hook drive combined with a multi-jaw guide guarantee maximum precision and sensitivity for the workpiece clamping
- Also suitable for large batch production, with heavy duty cutting or clamping of easy deformed workpieces
- Centrifugal force compensation for high speed applications
- Maximum durability due to case hardened chuck components

Technical features

- Wedge hook drive
- Centrifugal force compensation
- Multi-jaw guide
- Large through hole

Standard equipment

3-jaw chuck

Product features

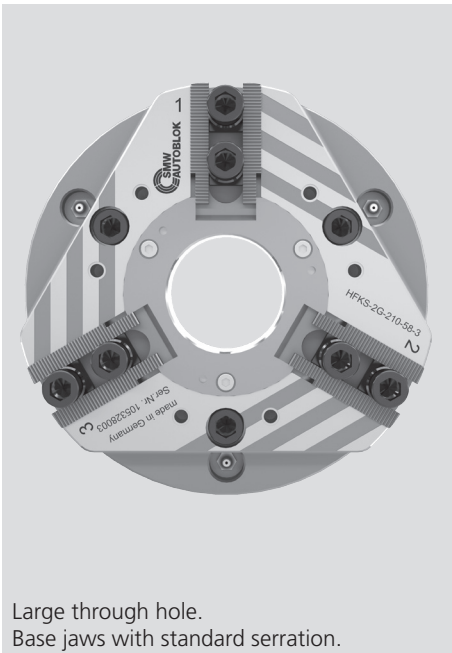

Large through hole.
Base jaws with standard serration.



Flats on the chuck body for best accessibility with live tools and to reduce the weight



Wedge hook drive combined with a multi-jaw guide and centrifugal force compensation for maximum precision and sensitivity for the workpiece clamping. (also for easy deformed workpieces)

HFKS-2G

INCH
SERRATION

Main dimensions and technical data

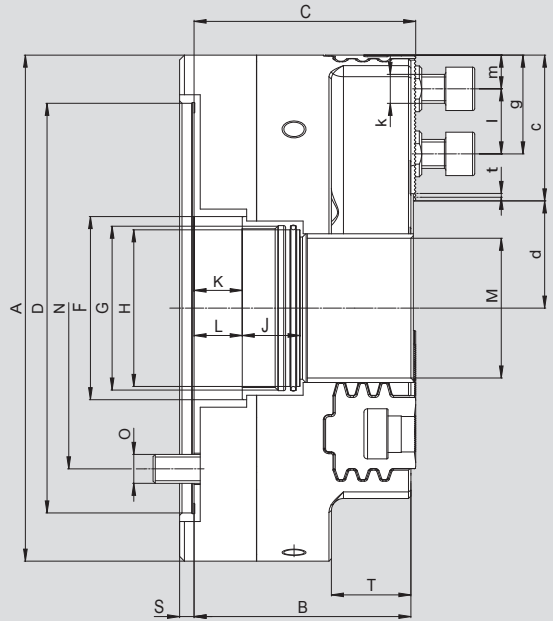
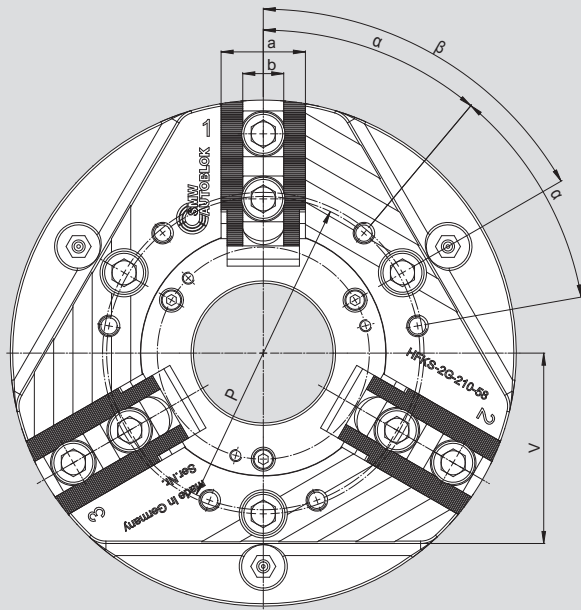

Subject to technical changes.
For more detailed information please ask our customer service.

SMW-AUTOBLOK Type HFKS-2G		210-58
Mounting		Z170
	A	210
	B	90
	C	92
	D H6	170
	F	76
Piston thread/depth	G	M68 x 2 / 18
	H H6	65
Piston stroke	J	24
Max.	K	20
	L	20
Fixing bolt circle	M	58
Fixing bolt	N	133.4
	O	M12
	P	130
Thread/thread depth	R	M8 / 15
	S	6
	T	33
	V	79
	a	35
	b H7	17
	c	60.5
Max.	d	44.5
Max./Min.	g	46.5 / 25
Bolt ISO 4762 12.9	k	M12
Min.	l	19
Min.	m	6
HFKS-2G inch serration	t	1/16" x 90°
	α°	40
	β°	60
Stroke per jaw	mm	5.3
Max. actuating force	kN	40
Max. total gripping force	kN	100
Max. speed	r.p.m.	6300
Weight (without jaws)	kg	18
Moment of inertia	kg·m ²	0.12
Rec. closed center cylinder	Type	SIN-S 125/150
Rec. open center cylinder	Type	VNK-T2 170-77

Further sizes on request.

**SMW-AUTOBLOK Spannsysteme GmbH**

Postfach 1151 • D-88070 Meckenbeuren
 Wiesentalstraße 28 • D-88074 Meckenbeuren
 Tel.: +49 (0) 7542 - 405 - 0

Vertrieb Inland > vertrieb@smw-autoblok.de
 Fax: +49 (0) 7542 - 3886
 Sales International > sales@smw-autoblok.de
 Fax: +49 (0) 7542 - 405 - 181

**U.S.A.**

SMW-AUTOBLOK Corporation
 285 Egidi Drive - Wheeling, IL 60090
 Tel. +1 847 - 215 - 0591
 Fax +1 847 - 215 - 0594
 E-mail > autoblok@smwautoblok.com

**Japan**

SMW-AUTOBLOK Japan Inc.
 1-56 Hira, Nishi-Ku
 461-Nagoya
 Tel. +81 (0) 52 - 504 - 0203
 Fax +81 (0) 52 - 504 - 0205
 E-mail > japan@smwautoblok.co.jp

**China**

SMW-AUTOBLOK (Shanghai) Work Holding Co.,Ltd.
 Building 6, No.72, JinWen Road, KongGang
 Industrial Zone, ZhuQiao Town, Pudong District
 201323, Shanghai P.R. China
 Tel. +86 21 - 5810 - 6396
 Fax +86 21 - 5810 - 6395
 E-mail > china@smwautoblok.cn

**Mexico**

SMW-AUTOBLOK Mexico, S.A. de C.V.
 Pirineos No. 515-B, Nave 16
 Col. Industrial Benito Juarez
 Micro Parque Industrial Santiago
 Queretaro, Qro. C.P. 76130
 Tel. +52 (442) 209 - 5118
 Fax +52 (442) 209 - 5121
 E-mail > smwmex@smwautoblok.mx

**India**

SMW-AUTOBLOK Workholding Pvt. Ltd.,
 Plot No. 4, Weikfield Industrial Estate,
 Gat No. 1251, Sanaswadi, Tal - Shirur,
 Dist - Pune. 412 208
 Tel. +91 2137 - 616 974
 Fax +91 2137 - 616 972
 E-mail > info@smwautoblok.in

**Brazil**

SYSTEC METALÚRGICA LTDA
 R. Luiz Brisque, 980
 13280-000 - Vinhedo - SP
 Tel. +55 (0) 193 886 - 6900
 Fax +55 (0) 193 886 - 6970
 E-mail > systec@systecmetal.com.br

**Argentina**

SMW-AUTOBLOK Argentina
 Rio Pilcomay 1121 - Bella Vista
 RA - 1661 Bella Vista Buenos Aires
 Tel. +54 (0) 1146 - 660 603
 Fax +54 (0) 1146 - 660 603
 E-mail > autoblok@ciudad.com.ar

**AUTOBLOK s.p.a.**

Via Duca D'Aosta n.24
 Fraz. Novaretto
 I-10040 Caprie - Torino
 Tel. +39 011 - 9638411
 Tel. +39 011 - 9632020
 Fax +39 011 - 9632288
 E-mail > info@smwautoblok.it

**France**

SMW-AUTOBLOK
 17, Avenue des Frères Montgolfier - Z.I. Mi-Plaine
 F-69680 Chassieu
 Tel. +33 (0) 4 - 727 - 918 18
 Fax +33 (0) 4 - 727 - 918 19
 E-mail > autoblok@smwautoblok.fr

**Great Britain**

SMW-AUTOBLOK Telbrook Ltd.
 7 Wilford Industrial Estate
 Ruddington Lane, Wilford
 GB-Nottingham, NG11 7EP
 Tel. +44 (0) 115 - 982 1133
 E-mail > info@smw-autoblok-telbrook.co.uk

**Spain**

SMW-AUTOBLOK IBERICA, S.L.
 Ursalto 10 - Nave 2, Pol. 27 - Mateo Gaina
 20014 San Sebastián (Guipúzcoa) (Spain)
 Tel.: +34 943 - 225 079
 Fax: +34 943 - 225 074
 E-mail > info@smwautoblok.es

**Russia**

SMW-AUTOBLOK Russia
 B.Tulskaya str., 10, bld.3, off. 323,
 115191 Moscow (Russia)
 Tel. +7 495 -231-1011
 Fax +7 495 -231-1011
 E-mail > info@smw-autoblok.ru

**Taiwan**

AUTOBLOK Company Ltd.
 NO.6, SHUYI RD., SOUTH DIST.,
 TAICHUNG, TAIWAN
 Tel. +886 4-226 10826
 Fax +886 4-226 12109
 E-mail > taiwan@smwautoblok.tw

**Czech Republic / Slovakia**

SMW-AUTOBLOK s.r.o.
 Merhautova 20
 CZ - 613 00 BRNO
 Tel. +420 513 034 157
 Fax +420 513 034 158
 E-mail > info@smw-autoblok.cz

**Sweden / Norway**

SMW-AUTOBLOK Scandinavia AB
 Kasernvägen 2
 SE - 281 35 Hässleholm
 Tel. +46 (0) 761 420 111
 E-mail > info@smw-autoblok.se

**Korea**

SMW-AUTOBLOK KOREA CO., LTD.
 1108 ho, Baeksang Startower 1st,
 65, Digital-ro 9-gil, Geumcheon-gu
 Seoul, ROK-08511, Korea
 Tel. +82 2 6267 9505
 Fax +82 2 6267 9507
 E-mail > info-korea@smw-autoblok.net