

Dial indicators / Dial test indicators / Center instruments
Edge finders / Probes / MF measuring fixture system

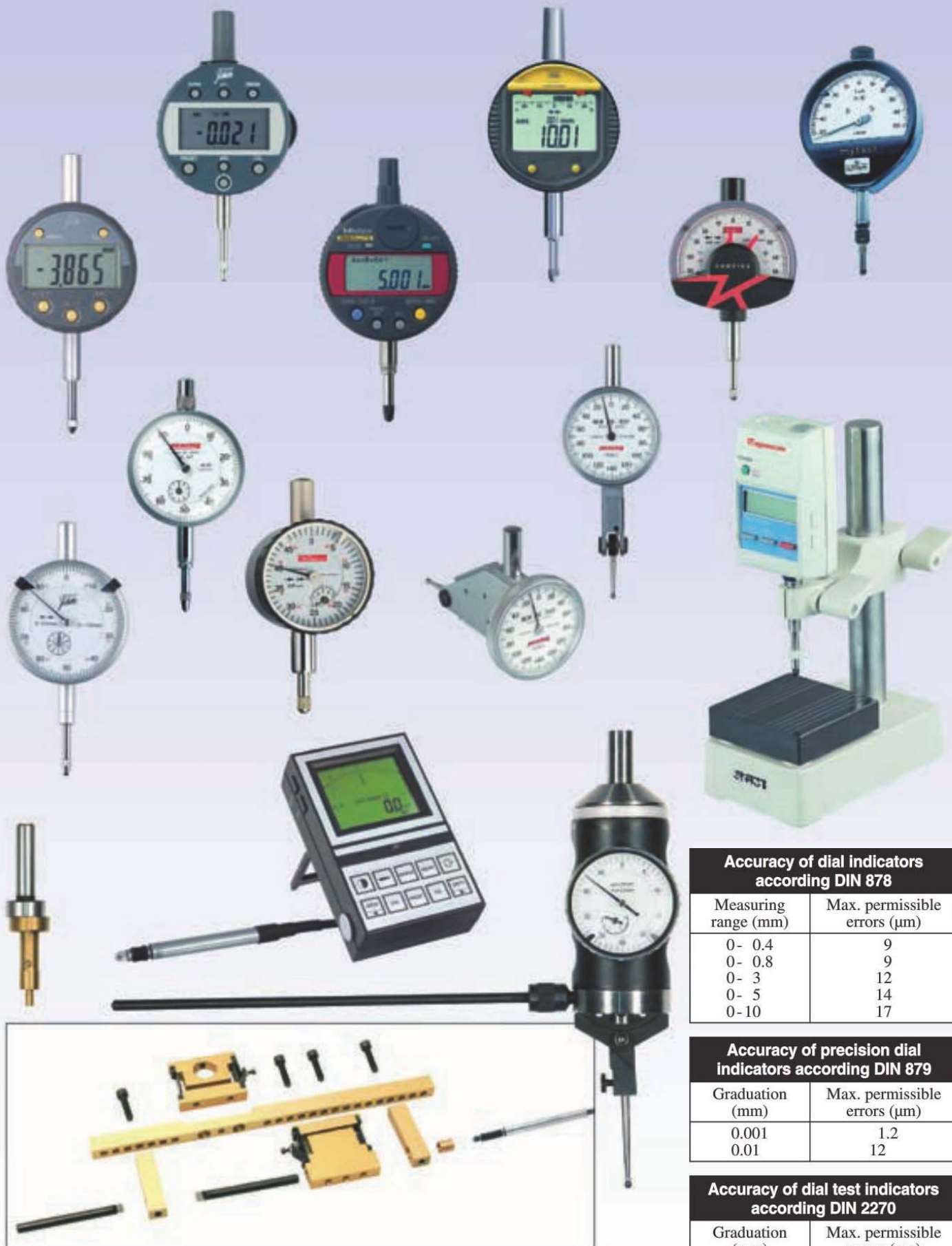

Accuracy of dial indicators according DIN 878	
Measuring range (mm)	Max. permissible errors (µm)
0 - 0.4	9
0 - 0.8	9
0 - 3	12
0 - 5	14
0 - 10	17

Accuracy of precision dial indicators according DIN 879	
Graduation (mm)	Max. permissible errors (µm)
0.001	1.2
0.01	12

Accuracy of dial test indicators according DIN 2270	
Graduation (mm)	Max. permissible errors (µm)
0.002	4
0.01	13

C05.001-EN-20170116

Digital dial indicators 0.01 and 0.001 mm

Digital dial indicators for a favourable price.

- Measuring range: 0 - 50 mm.
- Resolution: 0.01 or 0.001 mm.
- mm/inch conversion.
- ABS/INC switchable.
- On/off switch.
- Reset.
- Clamping stem: \varnothing 8 mm.
- Dial diameter: 57 mm.
- Adjustable tolerance limits.
- Flat back and additional back with lug.
- Delivery with an inspection report.
- Power supply: 1 battery type CR2025.



907.646

907.649



Item No.	Measuring range/mm	Accuracy mm	Price EUR
With resolution 0.01 mm:			
907.634	0 - 12.5	± 0.02	50.00
907.649	0 - 25	± 0.03	72.00
907.652	0 - 50	± 0.04	134.00
With resolution 0.001 mm:			
907.646	0 - 12.5	± 0.015	62.00
Options:			
495.214	Spare battery		0.70
909.446	USB interface		120.00
937.179	Foot switch		43.00



909.446

USB interface:

- For data transfer to PC (e.g. Excel, Word).
- Operating system: Windows 2000/XP/Vista/7.
- PC connection: USB data output (cable length 2 m).
- No software or driver to install.
- Foot switch (optional).

Absolute digital dial indicators

- Measuring range: 0 - 50.8 mm.
- Resolution: 0.01 mm or 0.001 mm.
- mm/inch conversion.
- ABS/INC switchable.
- LCD display 330° rotatable.
- Digimatic data output.
- On/off switch.
- Reset/preset.
- Max. measuring speed: any.
- Measuring force: ≤ 2 N.
- Clamping stem: $\varnothing 8$ mm.
- Dial diameter: 60 mm.
- Reversible measuring direction.
- With determination of the reversal point (only 910.004).
- Adjustable tolerance limits (except 910.004).
- Flat back and additional back with lug.
- Protection: IP54.
- Delivery in a case with an inspection report.
- Power supply: 1 battery type CR2032.



NEW



909.998



910.004



909.686



909.687



909.611

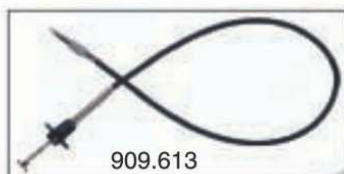

909.613

909.614

Item No.	Measuring range/mm	Resolution mm	Accuracy mm	Price EUR
909.998	0 - 12.7	0.001	± 0.004	140.00
909.999	0 - 25.4	0.001	± 0.005	183.00
910.000	0 - 50.8	0.001	± 0.006	253.00
910.001	0 - 12.7	0.01	± 0.01	78.00
910.002	0 - 25.4	0.01	± 0.01	100.00
910.003	0 - 50.8	0.01	± 0.015	140.00
For internal measurements:				
910.004	0 - 12.7	0.001	± 0.004	153.00
Options:				
495.157	Spare battery			0.50
909.686	USB interface			101.00
909.687	Footswitch			17.30
909.611	Retraction lever			1.00
909.613	Cable retraction device (1 m) (maximum travel 10 mm)			13.60
909.614	Retraction lever (maximum travel 12.7 mm)			6.00

Digital dial indicators

Digital dial indicators with digital and digital-analog read-out.

- Measuring range: 0- 12.5 mm.
- Resolution: 0.002 or 0.001 mm.
- mm/inch conversion.
- ABS/INC switchable.
- On/off switch.
- Automatic switch-off.
- Reset/preset.
- Clamping stem: \varnothing 8 mm.
- Dial diameter: 62 mm.
- Dial 360° rotatable.
- Reversible measuring direction.
- With determination of the reversal point.
- Adjustable tolerance limits.
- Power supply: 1 battery type CR2032.



Item No.	Measuring range/mm	Resolution mm	Accuracy mm	Measuring force/N	Price EUR
909.250	0-12.5	0.002	± 0.015	1.8-3.0	92.00
909.251	0-12.5	0.001	± 0.006	2.2-3.5	206.00
Option:					
495.157	Spare battery				0.50



909.251

Digital dial indicators

Universal digital indicators with both digital and digital-analog display of the measuring value, and can also be rotated over 340° to ensure easy read-out in all positions.

- Measuring range: 0- 12.7 mm.
- Resolution: 0.001 mm.
- Analog resolution: 0.001/0.002/0.01/0.02/0.05 mm.
- mm/inch conversion.
- ABS/INC switchable.
- On/off switch.
- Automatic switch-off.
- Reset/preset.
- Clamping stem: \varnothing 8 mm.
- Dial diameter: 61 mm.
- Dial 340° rotatable.
- Reversible measuring direction.
- With determination of the reversal point.
- Adjustable tolerance limits.
- Protection: IP54.
- Power supply: 1 battery type CR2032.



Item No.	Measuring range/mm	Accuracy mm	Price EUR
907.879	0-12.7	± 0.01	106.00
907.878	0-12.7	± 0.005	163.00
Option:			
495.157	Spare battery		0.50



907.879

Dial indicators 0.01 mm

Indicators with an excellent price-performance ratio.

- Measuring range: 0 - 10 mm.
- Graduation: 0.01 mm.
- Clamping stem: \varnothing 8 mm.
- Dial diameter: 55 mm.
- Rotatable dial.
- Shockproof.
- Adjustable tolerance markers.
- Flat back.
- Delivery with an inspection report.



Item No.	Measuring range/mm	Price EUR
907.928	0 - 3	14.00
907.929	0 - 5	14.40
907.930	0 - 10	15.10
Option:		
908.799	Back with lug	1.90



Dial indicators 0.01 mm

Indicators with a large dial and a locking screw. Shockproof design.

- Measuring range: 0 - 10 mm.
- Graduation: 0.01 mm.
- Clamping stem: \varnothing 8 mm.
- Dial diameter: 60 mm.
- Rotatable dial.
- Shockproof.
- Adjustable tolerance markers.
- Locking screw.
- Flat back.
- Delivery with an inspection report.



Item No.	Measuring range/mm	Price EUR
907.931	0 - 3	14.40
907.932	0 - 5	15.10
907.933	0 - 10	15.70
Option:		
908.987	Back with lug	1.90



Dial indicators 0.01 mm

Indicators with a large measuring range. Shockproof design.

- Measuring range: 0 - 100 mm.
- Graduation: 0.01 mm.
- Clamping stem: \varnothing 8 mm.
- Rotatable dial.
- Shockproof.
- Adjustable tolerance markers (except 907.916).
- Locking screw.
- Flat back.
- Delivery with an inspection report.



907.934



907.936



907.935



907.916

Item No.	Measuring range/mm	Dial \varnothing /mm	Price EUR
907.934	0 - 25	60	27.10
907.935	0 - 30	60	28.20
907.936	0 - 50	76	63.00
907.916	0 - 100	80	119.00
Options:			
908.987 ¹	Back with lug		1.90
908.988 ²	Back with lug		2.70

¹ For 907.934/935.

² For 907.936/916.



Splashproof dial indicators 0.01 mm

Indicators with splashproof design.

- Measuring range: 0 - 10 mm.
- Graduation: 0.01 mm.
- Clamping stem: \varnothing 8 mm.
- Dial diameter: 55 mm.
- Rotatable dial.
- Shockproof.
- Adjustable tolerance markers.
- Locking screw.
- Back with lug.
- Protection: IP54.
- Conforms to factory standard.



908.779



Item No.	Measuring range/mm	Price EUR
908.777	0 - 3	37.40
908.778	0 - 5	39.10
908.779	0 - 10	41.00



Peacock dial indicators 0.1 and 0.01 mm

- Measuring range: 0-80 mm.
- Graduation: 0.1 or 0.01 mm.
- Clamping stem: \varnothing 8, 10 or 14 mm.
- Rotatable dial.
- Adjustable tolerance markers.
- Flat back or back with lug*.
- DIN 878.
- Delivery in a case.



855.547



855.517



855.507/8



855.527



855.537



855.589

Item No.	Measuring range/mm	Clamping stem \varnothing /mm	Dial \varnothing /mm	Price EUR
Graduation 0.01 mm:				
855.547	0- 4	8	36	50.00
855.536	0- 3	8	40	94.00
855.517	0- 5	8	53	35.30
855.507	0-10	8	53	32.10
855.508*	0-10	8	53	32.10
855.527*	0-20	8	66.5	63.00
855.537*	0-30	8	76	109.00
855.557*	0-50	10	83	163.00
Graduation 0.1 mm:				
855.589*	0-80	14	112	384.00

* Back with lug.



Peacock dial indicators 0.005 and 0.001 mm

- Measuring range: 0-5 mm.
- Graduation: 0.005 or 0.001 mm.
- Clamping stem: $\varnothing 8$ mm.
- Rotatable dial.
- Flat back or back with lug*.
- DIN 878.
- Delivery in a case.

Item No.	Measuring range/mm	Dial \varnothing /mm	Price EUR
Graduation 0.005 mm:			
855.535*	0-3	47	100.00
Graduation 0.001 mm:			
855.509	0-1	53	65.00
855.525*	0-2	66.5	128.00
855.555*	0-5	66.5	129.00

* Back with lug.



Peacock dial indicators with back plunger

The back plunger dial indicator is characterized with easy handling since the spindle with the contact point is moving in the direction perpendicular to the dial face and the gauge is more compact. The dial indicator of this type is convenient for use in achieving a parallelism of the table of the machine tool, with measuring jigs, in restricted areas and on locations where scale reading is difficult.

- Measuring range: 0-5 mm.
- Graduation: 0.01 mm.
- Repeatability: 0.005 mm.
- Hysteresis: ± 0.006 mm.
- Measuring force: 1.4 N.
- Rotatable dial.
- Scale numbering: 0-100.
- DIN 878.
- Delivery in a case.

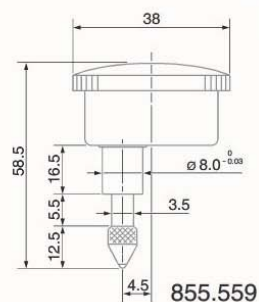
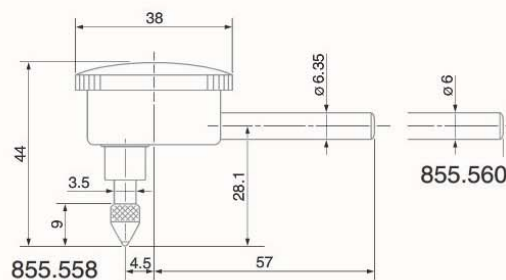

Item No.	Measuring range/mm	Clamping stem \varnothing /mm	Accuracy mm	Price EUR
855.558	0-5	6.35	± 0.02	65.00
855.560	0-5	6	± 0.02	69.00
Clamping stem on back side:				
855.559	0-5	8	± 0.02	65.00

 Schut

Käfer dial indicators 0.01 mm

These recently developed Käfer dial indicators are very stable and have a very good price-performance ratio. Also available in a shockproof design, where blows against the plunger can not damage the mechanics.

- Measuring range: 0- 10 mm.
 - Graduation: 0.01 mm.
 - Clamping stem: \varnothing 8 mm.
 - Dial diameter: 40 mm.
 - Scale numbering: 0- 50 (852.291: 0- 100).
 - Adjustable tolerance markers.
 - Flat back.
 - Clamping stem and measuring pin out of hardened stainless steel.
- DIN 878.
 - Delivery in a case.

Item No.	Measuring range/mm	Graduation mm	Price EUR
852.350	0- 3	0.01	38.40
852.352	0- 5	0.01	49.00
Shockproof design:			
852.351	0- 3	0.01	47.00
852.353	0- 5	0.01	61.00
852.291	0- 10	0.01	68.00



Käfer dial indicators 0.01 mm

These dial indicators have an almost constant measuring force of 1 N over the total measuring range. This is achieved through a built-in lever construction. The shockproof design protects the mechanics against harsh blows and reduces the possibility of damage. The shockproof design has an unbreakable cover glass.

- Measuring range: 0- 10 mm.
- Graduation: 0.01 mm.
- Measuring force: approx. 1 N.
- Clamping stem: \varnothing 8 mm.
- Dial diameter: 58 mm.
- Scale numbering: 0- 100.
- Adjustable tolerance markers.
- Flat back.
- DIN 878.
- Delivery in a case.

Item No.	Measuring range/mm	Graduation mm	Price EUR
852.354	0- 10	0.01	39.70
Shockproof design:			
852.355	0- 10	0.01	39.50



Käfer dial indicators 0.01 mm

These Käfer dial indicators combine a large measuring range with a high accuracy. The clear dials ensure an easy read-out. Thanks to the special construction, these dial indicators have an almost constant measuring force on the whole measuring range.

- Measuring range: 0 - 100 mm.
- Graduation: 0.01 mm.
- Measuring force: approx. 1 N
(852.290 approx. 1.5 N, 852.289 approx. 1.2 N).
- Clamping stem: \varnothing 8 mm.
- Dial diameter: 58 mm.
- Rotatable dial.
- Adjustable tolerance markers.
- Flat back.
- Clamping stem and measuring pin out of hardened stainless steel.
- Conforms to factory standard.
- Delivery in a case.

Item No.	Measuring range/mm	Accuracy mm	Scale numbering	Price EUR
852.356	0 - 30	± 0.02	0 - 100	87.00
852.357	0 - 50	± 0.025	0 - 100	125.00
852.290	0 - 80	± 0.030	0 - 100	257.00
852.289	0 - 100	± 0.050	0 - 100	326.00



Käfer Feinika dial indicators 0.001 mm

The Käfer Feinika dial indicators have a special construction without gear wheels, comparable to the precision dial indicators. A special lever construction enlarges the measuring range up to 1 mm. This lever construction gives the Feinika a very low hysteresis of maximal 1.5 μ m, making it very suitable for very accurate comparative measurements where a large measuring range is necessary. Just like the precision dial indicators the Feinika has a resolution of 0.001 mm.

- Measuring range: 0 - 1 mm.
- Graduation: 0.001 mm.
- Hysteresis: ≤ 0.0015 mm.
- Clamping stem: \varnothing 8 mm.
- Shockproof.
- Adjustable tolerance markers.
- Conforms to factory standard.
- Delivery in a case.



Item No.	Measuring range/mm	Accuracy mm	Dial \varnothing /mm	Scale numbering	Price EUR
852.358	0 - 1	± 0.004	40	0 - 100	159.00
852.359	0 - 1	± 0.004	58	0 - 100	159.00

Precision dial indicator

Highly accurate shockproof dial indicator for measurements from a fixed reference point. Very suitable for internal measuring instruments and dial indicator stands for example.

- Measuring range: 0.1 mm.
- Graduation: 0.001 mm.
- Measuring force: <2 N.
- Clamping stem: $\varnothing 8$ mm.
- Travel: 3 mm.
- Adjustable tolerance markers.
- Fine adjustment.
- Conforms to factory standard.



NEW

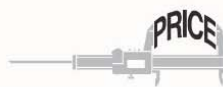

Item No.	Measuring range/mm	Dial \varnothing /mm	Price EUR
907.939	0.1	63.5	138.00



Käfer Compika precision dial indicators

Accurate precision dial indicators with stable, multiple ball-bearing mechanics. Because of that the Compika has a very low hysteresis. Easy to set by the fine adjustment on top of the dial indicator, that has a protective knob to prevent unintentional displacement of the pointer.

- Measuring range: 0.1 mm.
- Graduation: 0.001 mm.
- Measuring force: approx. 1 N.
- Clamping stem: $\varnothing 8$ mm.
- Max. probe travel: 3 mm.
- Ball bearing probe rod.
- Protective knob.
- Shockproof.
- Waterproof (only 852.386).
- Adjustable tolerance markers.
- Fine adjustment.
- Clamping stem and measuring pin out of hardened stainless steel.
- DIN 879.
- Delivery in a case.

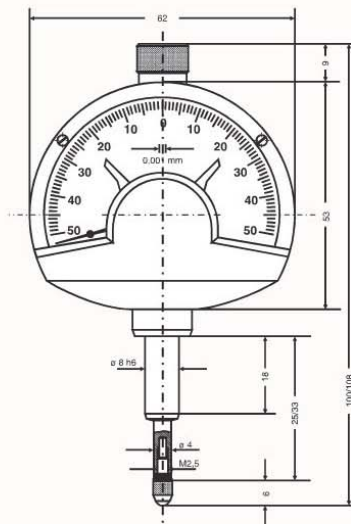

852.360



852.386

Item No.	Measuring range/mm	Waterproof	Dial \varnothing /mm	Scale numbering	Price EUR
852.360	0.1	no	62	50-0-50	151.00
852.386	0.1	yes	62	50-0-50	193.00

Schwenk precision dial indicators

Highly accurate shockproof dial indicators for measurements from a fixed reference point. Very suitable for internal measuring instruments and dial indicator stands for example.

- Measuring range: up to 0.5 mm.
- Graduation: 0.01 or 0.001 mm.
- Measuring force: approx. 1 N.
- Clamping stem: $\varnothing 8$ mm.
- Max. probe travel: 3 mm.
- Ball bearing probe rod.
- Adjustable tolerance markers.
- DIN 879.
- Delivery in a case.



852.640



852.641

Item No.	Type	Measuring range/mm	Graduation mm	Price EUR
852.640	Mytast	0.1	0.001	171.00
852.641	Centitast	0.5	0.01	136.00

Etalon precision dial indicators

- Measuring range: 0.1 mm.
- Graduation: 0.001 mm.
- Measuring force: approx. 1 N.
- Clamping stem: $\varnothing 8$ mm.
- Max. probe travel: 3 mm.
- Shockproof.
- Waterproof (only 781.700).
- Adjustable tolerance markers.
- Fine adjustment.
- Clamping stem and measuring pin out of hardened stainless steel.
- DIN 879.
- Delivery in a case with a lifting cable.



781.699



781.700

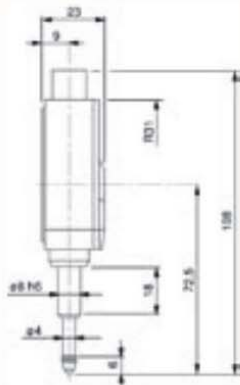

Item No.	Measuring range/mm	Waterproof	Dial \varnothing /mm	Price EUR
781.699	0.1	no	62	283.00
781.700	0.1	yes	62	321.00

Lever-type digital test indicator

Lever-type digital test indicator with tolerance judgement. Suitable for measurements in both directions. Equipped with three dovetail mountings.

- Measuring range: up to 0.5 mm.
- Resolution: 0.001 mm.
- Accuracy: ± 0.02 mm.
- mm/inch conversion.
- On/off switch.
- Reset.
- Measuring force: ≤ 0.6 N.
- With dovetail joint and clamping stems $\varnothing 6$ and $\varnothing 8$ mm.
- Ruby stylus tip: $\varnothing 2$ mm.
- 230° adjustable measuring insert.
- Adjustable tolerance limits.
- Power supply: 1 battery type V357.



Item No.	Measuring range/mm	Resolution mm	Insert length/mm	Price EUR
907.574	0.5	0.001	20	166.00
Option:				
836.535	Spare battery			1.60



Lever-type test indicators

- Measuring range: up to 0.8 mm.
- Graduation: 0.01 or 0.002 mm.
- With dovetail joint and clamping stems $\varnothing 6$ and $\varnothing 8$ mm.
- Dial diameter: 40 mm.
- Rotatable dial.
- Stylus tip: $\varnothing 2$ mm.
- Conforms to factory standard.



Item No.	Measuring range/mm	Graduation mm	Scale numbering	Insert length/mm	Price EUR
907.941	0.8	0.01	0-40-0	19	31.70
907.942	0.2	0.002	0-100-0	12	57.00
Options:					
909.114	Spare stylus tip for 907.941				7.60
909.115	Spare stylus tip for 907.942				7.60



907.941

Peacock lever-type dial test indicators

- Measuring range: up to 1 mm.
- Graduation: 0.01, 0.002 or 0.001 mm.
- With dovetail joint and clamping stem $\varnothing 6$ mm.
- Measuring force: < 0.3 N.
- Tungsten carbide stylus tip: $\varnothing 2$ mm.
- Insert thread: M1.7.

Inserts for lever-type dial test indicators

Item No.	Effective length (EL)/mm	Ball \varnothing /mm	Price EUR
For 855.601:			
859.016	17.74	2	5.80
859.152	17.74	1	11.60
859.151	17.74	0.8	11.60
859.290	17.74	0.5	58.00
For 855.602:			
859.126	39.00	2	9.30
859.291	39.00	1	13.90
859.292	39.00	0.8	13.90
859.293	39.00	0.5	58.00
For 855.603, 855.605 and 855.606:			
859.200	14.18	2	7.00
859.294	14.18	1	11.60
859.295	14.18	0.8	11.60
859.296	14.18	0.5	58.00
For 855.604:			
859.259	8.13	2	7.00
859.297	8.13	1	11.60
859.298	8.13	0.8	11.60
859.299	8.13	0.5	58.00
For 855.611:			
859.464	19.24	2	5.80
859.465	19.24	1	11.60
859.466	19.24	0.8	11.60
859.467	19.24	0.5	58.00



Item No.	Measuring range/mm	Graduation mm	Dial \varnothing /mm	Scale numbering	Insert	Total insert length (TL)/mm	Price EUR
Horizontal:							
855.601	0.5	0.01	35	0-25-0	859.016	21.3	80.00
855.602	1	0.01	35	0-50-0	859.126	42.8	86.00
855.603	0.28	0.002	35	0-140-0	859.200	17.8	86.00
855.604	0.14	0.001	30	0-70-0	859.259	11.7	101.00
855.605	0.5	0.01	35	0-25-0	859.200	17.8	87.00
Perpendicular:							
855.606	0.28	0.002	35	0-140-0	859.200	17.8	91.00
855.611	0.8	0.01	35	0-40-0	859.464	21.8	136.00

Käfer lever-type dial test indicators

Käfer lever-type dial test indicators have a very high accuracy because of the ruby ball bearing. The direction of the rotation is independent of the measuring direction. Equipped with three dovetail mountings. Are standard delivered with a clamping stem $\varnothing 8$ mm.

- Measuring range: up to 0.8 mm.
- Graduation: 0.01 or 0.002 mm.
- With dovetail joint and clamping stem $\varnothing 8$ mm.
- Rotatable dial.
- Tungsten carbide stylus tip: $\varnothing 2$ mm.
- Insert thread: M1.6
(optional inserts on request).
- 240° adjustable measuring insert.
- Ruby ball bearing.
- DIN 2270.
- Delivery in a case incl. key.
- Various different models available.



Item No.	Measuring range/mm	Graduation mm	Dial \varnothing /mm	Scale numbering	Insert length/mm	Price EUR
852.361	0.8	0.01	32	0-40-0	12	71.00
852.362	0.5	0.01	32	0-25-0	35	95.00
852.363	0.2	0.002	40	0-100-0	12	88.00

Käfer saw tooth indicator

By placing the indicator on the saw blade you can easily measure the flatness of the blade, enabling you to saw very precisely. With the indicator you can also measure the height difference between the saw blade and the tooth. This principal of differential measuring of thickness or heights is not only suited for saw blades, but has many other applications.

Because the indicator has a two-sided read-out, it is usable for left- as well as right-handers.

- Measuring range: 0-2 mm.
- Graduation: 0.05 mm.
- Rotatable dial.
- Adjustable tolerance marker.

Item No.	Description	Price EUR
852.364	Saw tooth indicator	60.00



3D probes for centering and measuring

For easy and with high accurate setting the reference point of workpiece in all three axes (X, Y and Z), vertically and horizontally.

- Measuring range: max. ± 2 mm (rupture point in probe).
- Analog: graduation 0.01 mm, digital: resolution 0.001 mm.
- Clamping stem: $\varnothing 20$ mm.
- Insert length 25 mm, stylus tip $\varnothing 4$ mm (insert length 65 mm and diameter 8 mm optional).
- mm/inch conversion (only 853.822).
- Digit height: 8.5 mm (only 853.822).
- Isolation between insert and insert thread; for use on all machining centres and EDM machines.
- Insert thread: M3.
- Protection: analog: IP67, digital: IP64.



Item No.	Description	Accuracy mm	Repeatability mm	Price EUR
853.821	Analog 3D probe	± 0.01	0.01	279.00
853.822	Digital 3D probe	± 0.005	0.001	496.00
Options:				
495.157	Spare battery			0.50
853.823	Spare insert 25 mm, tip diameter 4 mm			25.20
853.824	Spare insert 65 mm, tip diameter 8 mm			42.00

Edge finders

Edge finders for both stationary and rotating use. As soon as the workpiece is touched by the ballprobe the all around visible LED will light up due to galvanic contact. The ballprobe is held in place by a spring. When the pressure on the tip becomes too large the ball will flip away sideways. The edge finders are also available with additional sound signal for extra working comfort.

- Concentricity: < 0.01 mm.
- Diameter ballprobe: 10 mm.
- Delivery in a case.
- Power supply:
907.456/460: 2 batteries type V357,
907.454/458: 1 battery type 23A.



907.456



907.458

Item No.	Clamping stem \varnothing /mm	Length mm	Price EUR
907.454	20	162	49.00
907.456	20	100	44.00
With sound signal:			
907.458	20	162	63.00
907.460	20	100	54.00
Options:			
836.535	Spare battery (2 needed)		1.60
497.931	Spare battery		1.00

PRICE

Edge finders

Rotating edge finders for accurate edge location.

- Resolution: 0.005 mm.
- Repeatability: 0.005 mm.
- Range of use: approx. 600 rpm.
- Hardness TiN measuring face: 2200 HV.



Item No.	Clamping stem ϕ /mm	Probe ϕ /mm	Material (measuring face)	Price EUR
909.360	8	10	steel	17.50
909.361	10	10	steel	17.50
909.362	8	4 and 10	steel	18.90
909.363	10	4 and 10	steel	18.90
909.364	6	6	steel	18.90
909.365	10	10	steel + ceramic	54.00
909.366	10	10	steel + TiN	31.60
909.367	10	4 and 10	steel + TiN	31.60
Options:				
909.368	Spring for 909.360/362			2.10
909.369	Spring for 909.364			3.00
909.359	Spring for 909.365			3.00
909.349	Spring for 909.361/363/366/367			3.00

Z-axis setting gauge

For easy presetting the Z-axis with a tool, with or without in combination with parallel blocks to set a specific height. As soon as the tool touches the setting gauge (with floating top) the built-in red LED illumination will light up. After this the axis will move in opposite direction until the lamp turns off, this is the turning point, and so the setting gauge, to determine the accuracy.

- Repeatability: 0.01 mm.
- With magnetic base.
- Galvanic contact principle.

Item No.	Description	Price EUR
908.804	Z-axis setting gauge	161.00
Option:		
498.823	Spare battery (2 needed)	1.40

- Dimensions: $\phi 54 \times 50$ mm (precise height to determine with external measuring instrument).
- Weight: 450 g.
- Power supply: 2 batteries type V389.



Z-axis setting gauge

For easy presetting the Z-axis with a tool, with or without in combination with parallel blocks to set a specific height.

- Graduation: 0.01 mm.
- Repeatability: 0.02 mm.
- Diameter dial indicator: $\phi 35$ mm.



- Dimensions: $\phi 50 \times 50$ mm (precise height to determine with external measuring instrument).
- Weight: 654 g.
- Delivery with protective cover and reference pin (length 60 mm, $\phi 15$ mm) for insert in tool holder.



Item No.	Description	Price EUR
909.460	Z-axis setting gauge	148.00