



MODULAR CLAMPING SYSTEMS

5-Axis Workholding



GENIU5[®]
OML[®]
PAVIA ITALY
www.omlspa.it

5-Axis Machine Tools from OML - SMW AUTOBLOK



5-Axis Machine Tools ensures the following advantages:

- GT5 ideal suitable for OP 10 use
- ST5-2G also suitable for OP 20 use
- ST5-HD Line for heavy duty applications
- Jaws with SinterGrip clamping inserts for clamping of workpieces with lowest depth and without pre-marking
- Compact design with best accessibility of the machine spindle
- High adjustable clamping forces
- Interfaces for all well known zero point clamping systems
- Wide range of standard accessories

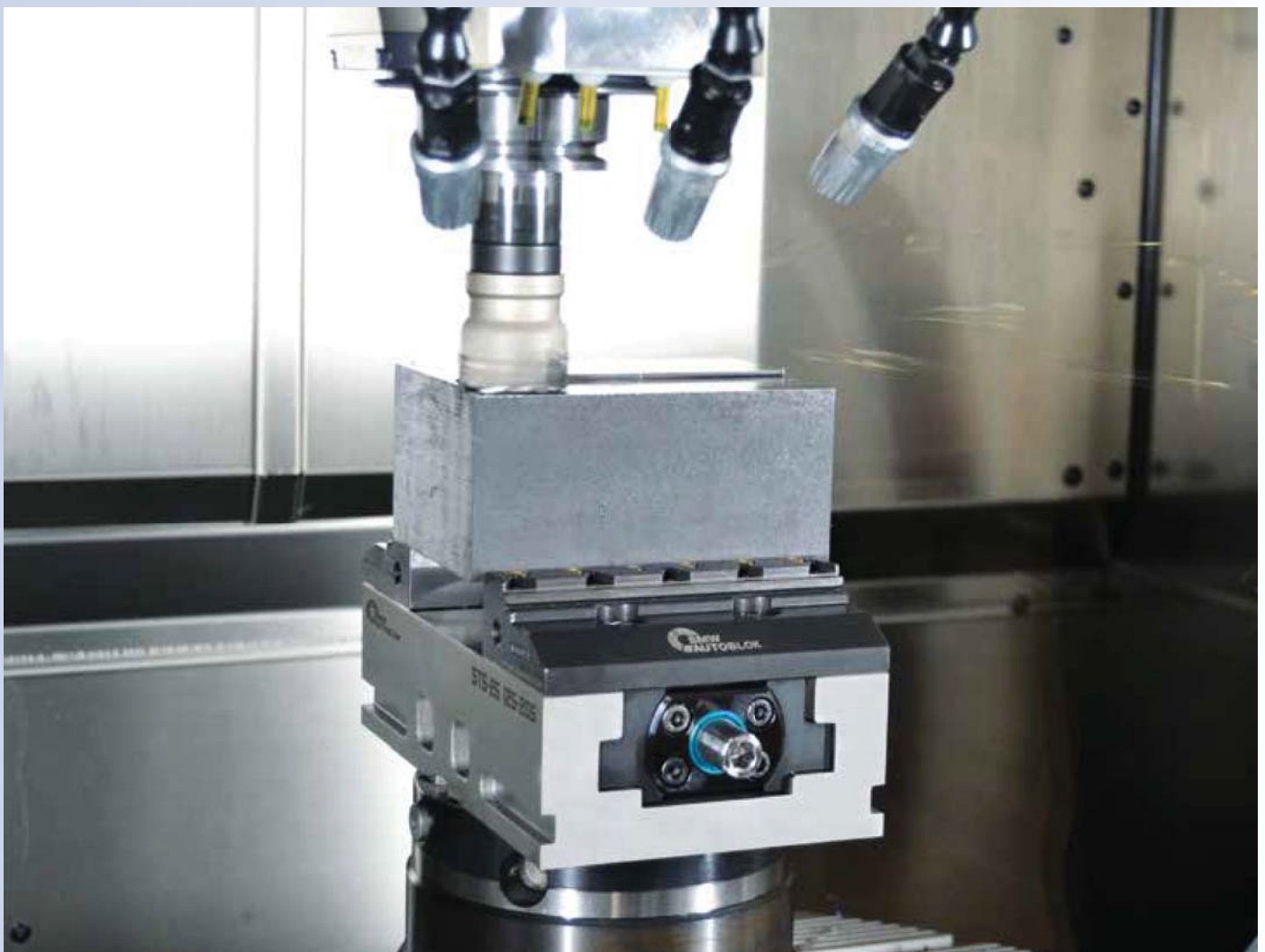



5-Axis Machine Tools from OML - SMW AUTOBLOK



ST5-2G

5-Axis Machine Tools ST5-2G 080 and ST5-2G 125

- Sealing for protection against contamination
- Central clamping
- Very compact design
- Large clamping range
- With SinterGrip clamping insert jaws
- Interfaces for zero point clamping systems

Page 6



ST5-HD

5-Axis Machine Tools ST5-HD Heavy Duty Version

- Sealing for protection against contamination
- Central clamping
- Very compact design
- Large clamping range
- With SinterGrip clamping insert jaws
- Interfaces for zero point clamping systems

Page 18



ST5-2G S

5-Axis Machine Tools ST5-2G S 125 Short Version

- Sealing for protection against contamination
- Central clamping
- Very compact design
- Shorter clamping range
- With SinterGrip clamping insert jaws
- Interfaces for zero point clamping systems

Page 8



ST5-HDD

5-Axis Machine Tools ST5-HDD Heavy Duty Version

- Sealing for protection against contamination
- Double clamping with 3rd hand function
- Very compact design
- Extra large clamping range
- With SinterGrip clamping insert jaws
- Interfaces for zero point clamping systems

Page 19



ST5-2G L

5-Axis Machine Tools ST5-2G L 125 Long Version

- Sealing for protection against contamination
- Central clamping
- Very compact design
- Extra large clamping range
- With SinterGrip clamping insert jaws
- Interfaces for zero point clamping systems

Page 9



ST5-HDF

5-Axis Machine Tools ST5-HDF Heavy Duty Version

- Sealing for protection against contamination
- Clamping against 1 fixed jaw
- Very compact design
- Extra large clamping range
- With SinterGrip clamping insert jaws
- Interfaces for zero point clamping systems

Page 20



ST5-2G

Jaws and Accessories

- Top jaws
- Pull-down jaws
- Pendulum jaws
- Mounting devices
- Clamps and positioning keys

Page 10



ST5-HD

Jaws and Accessories

- Top jaws
- Adapter for ST5-2G top jaws

Page 21

ST5-2G

Sealed Centric Clamp

2 Top Jaw Versions:

BASIC - with Gripper top jaws

PREMIUM - with SinterGrip top jaws

Reversible jaws for lowest clamping depth of workpieces and without pre-marking

Extra large clamping range

maximum flexibility
for OD and ID clamping



Premium SinterGrip Top jaws

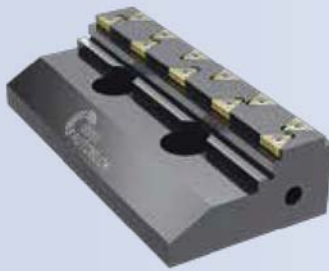

Manual actuation

Sealed from both sides with highest transmission offers highest clamping forces for maximum hold of the workpiece and highest process reliability



Interfaces

for zero point clamping
systems and mounting holes
as a standard



ing Vice

- **Sealing**
- for protection against contamination

- **Ideal usable**
- for automation and pallet systems

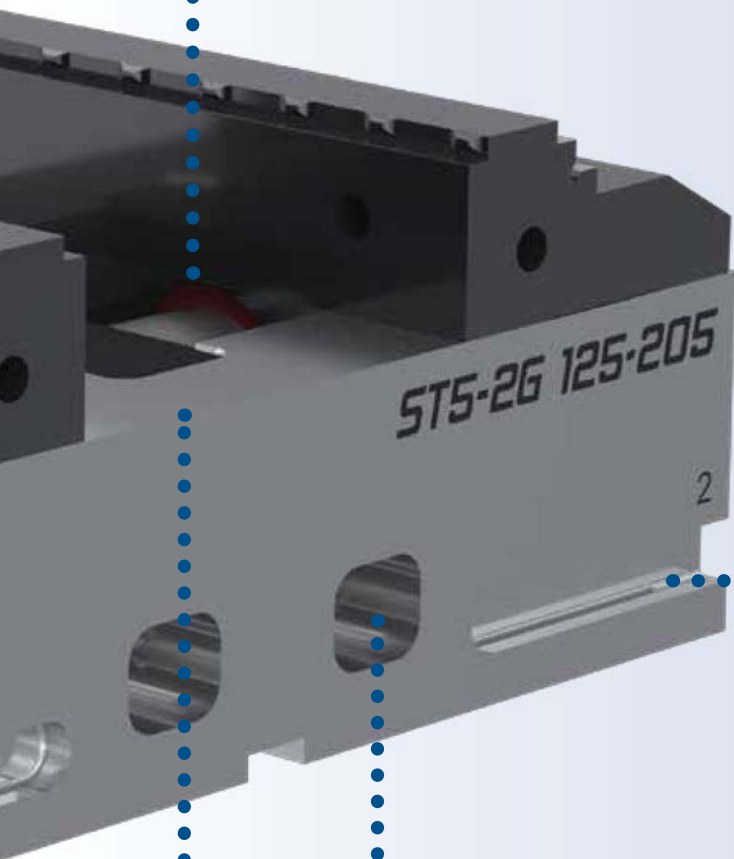

- **Flexible mounting**
- on the machine table
- optional via clamps

- **Extra large chip ejection windows**
- guarantees optimized chip flow

- **Guideway hardened and precision-ground**
- for highest precision and repeatability

ST5-2G 080

Self-centering vice

- Sealed – safed spindle
- Central clamping

Application/customer benefits

- High precise 5-axis centric clamping vice with highest repeatability
- Sealing for protection against contamination
- Compact design for best accessibility and with large chip ejection windows
- PREMIUM: Jaws with SinterGrip clamping inserts for lowest clamping depth of the workpiece without pre-marking
- Large clamping range
- Ideal for OP 10 and OP 20

Technical features

- Central clamping
- Manual actuation on both sides
- Clamping range 0 until 127 mm
- Clamping force up to 18 kN (35 Nm)
- Jaw width 80 mm
- Interface for zero point clamping systems APS / WPS and Lang 52 mm as a standard

Standard equipment

5-axis machine tool with wrench, BASIC: 1 pair top jaws Gripper

PREMIUM: SinterGrip top jaws with 8 pieces SinterGrip clamping inserts for steel and 8 pieces protective cover and mounting screws

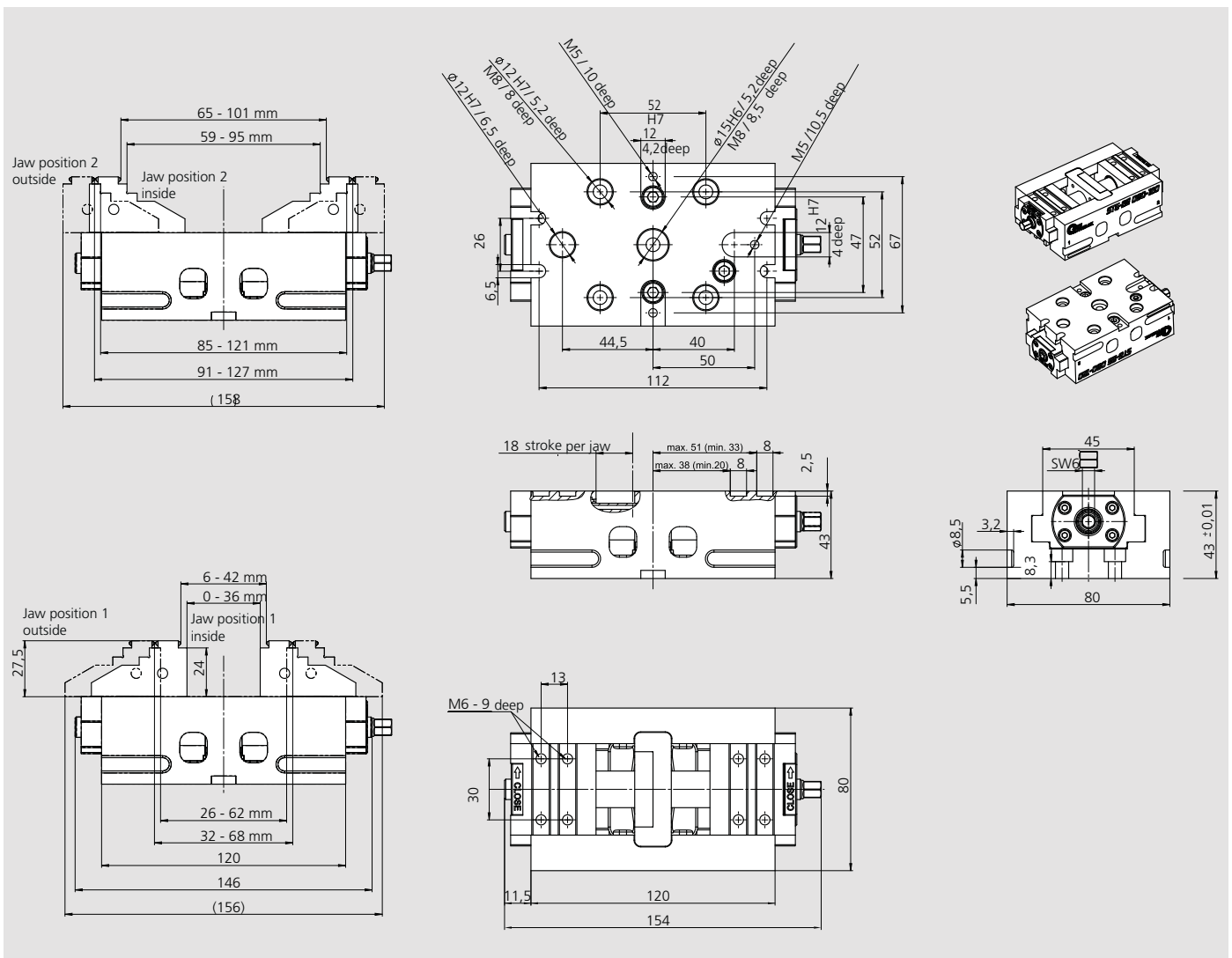

Type	Clamping range in mm	Id. No.
ST5-2G 080 BASIC with Gripper jaws	0 - 127	466110
ST5-2G 080 PREMIUM with SinterGrip jaws STD	0 - 127	466111
ST5-2G 080 PREMIUM with SinterGrip jaws ALU	0 - 127	466111A
ST5-2G 080 PREMIUM with SinterGrip jaws HRC	0 - 127	466111H
ST5-2G 080 without top jaws	0 - 127	466065

- Sealed – safed spindle
- Central clamping



Application/customer benefits

- High precise 5-axis centric clamping vice with highest repeatability
- Sealing for protection against contamination
- Compact design for best accessibility and with large chip ejection windows
- PREMIUM: Jaws with SinterGrip clamping inserts for lowest clamping depth of the workpiece without pre-marking
- Large clamping range
- Ideal for OP 10 and OP 20

Technical features

- Central clamping
- Manual actuation on both sides
- Clamping range 0 until 208 mm
- Clamping force up to 35 kN (70 Nm)
- Jaw width 125 mm
- Interface for zero point clamping systems APS / WPS and Lang 96 mm as a standard

Standard equipment

5-axis machine tool with wrench, BASIC: 1 pair top jaws Gripper
 PREMIUM: SinterGrip top jaws with 12 pieces SinterGrip clamping inserts for steel and 12 pieces protective cover and mounting bolts

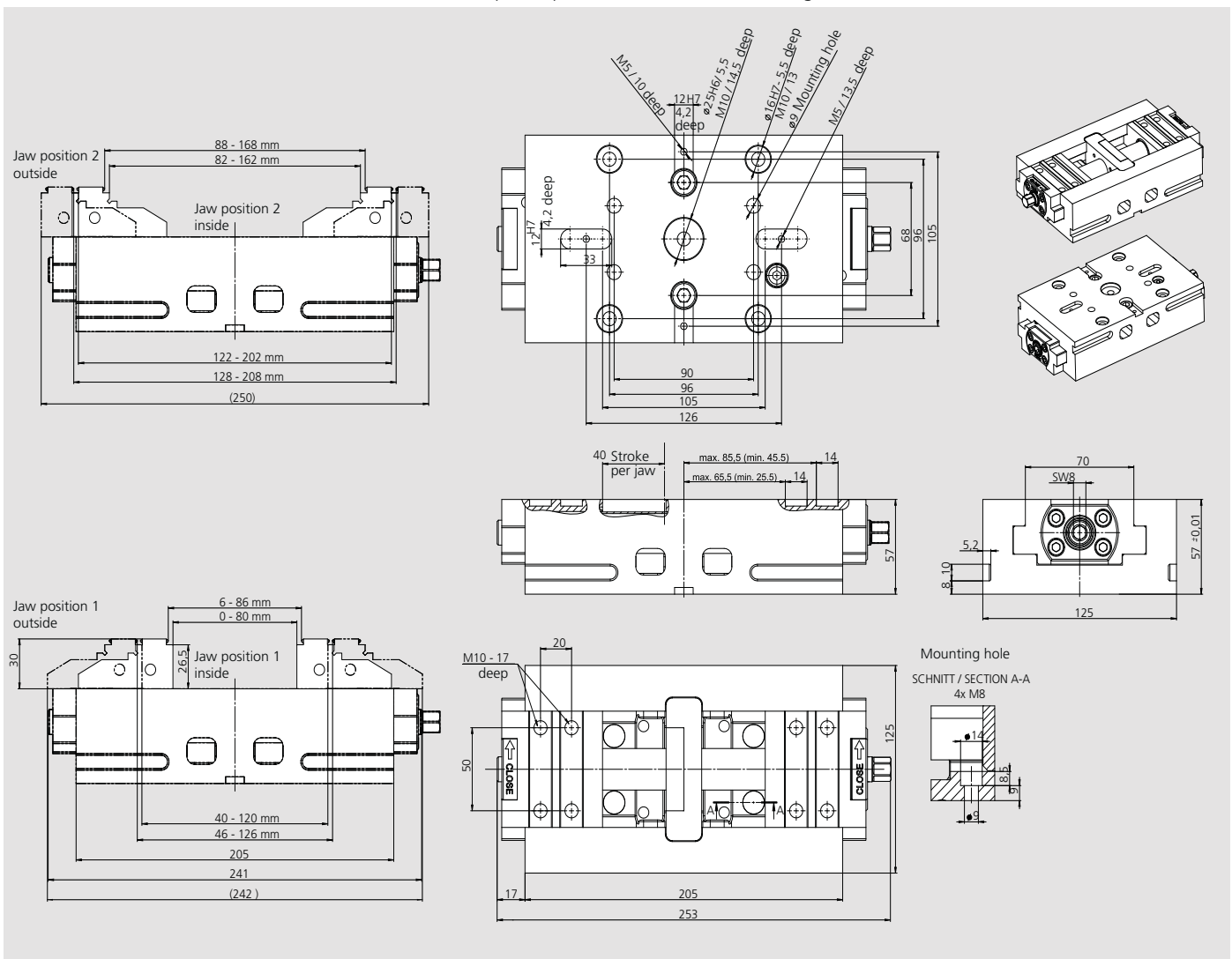

Type	Clamping range in mm	Id. No.
ST5-2G 125 BASIC with Gripper jaws	0-208	466120
ST5-2G 125 PREMIUM with SinterGrip jaws STD	0-208	466121
ST5-2G 125 PREMIUM with SinterGrip jaws ALU	0-208	466121A
ST5-2G 125 PREMIUM with SinterGrip jaws HRC	0-208	466121H
ST5-2G 125 without top jaws	0-208	466056

ST5-2G S 125

Self-centering vice short version

- Sealed – safed spindle
- Central clamping



Application/customer benefits

- High precise 5-axis centric clamping vice with highest repeatability
- Sealing for protection against contamination
- Compact design for best accessibility and with large chip ejection windows
- PREMIUM: Jaws with SinterGrip clamping inserts for lowest clamping depth of the workpiece without pre-marking
- Shorter version
- Ideal for OP 10 and OP 20

Technical features

- Central clamping
- Manual actuation on both sides (SW13/SW 8)
- Clamping range 0 until 168 mm
- Clamping force up to 35 kN (70 Nm)
- Jaw width 125 mm
- Interface for zero point clamping systems APS / WPS and Lang 96 mm as a standard

Standard equipment

5-axis machine tool with wrench, BASIC: 1 pair top jaws Gripper
 PREMIUM: SinterGrip top jaws with 12 pieces SinterGrip clamping inserts for steel and 12 pieces protective cover and mounting bolts

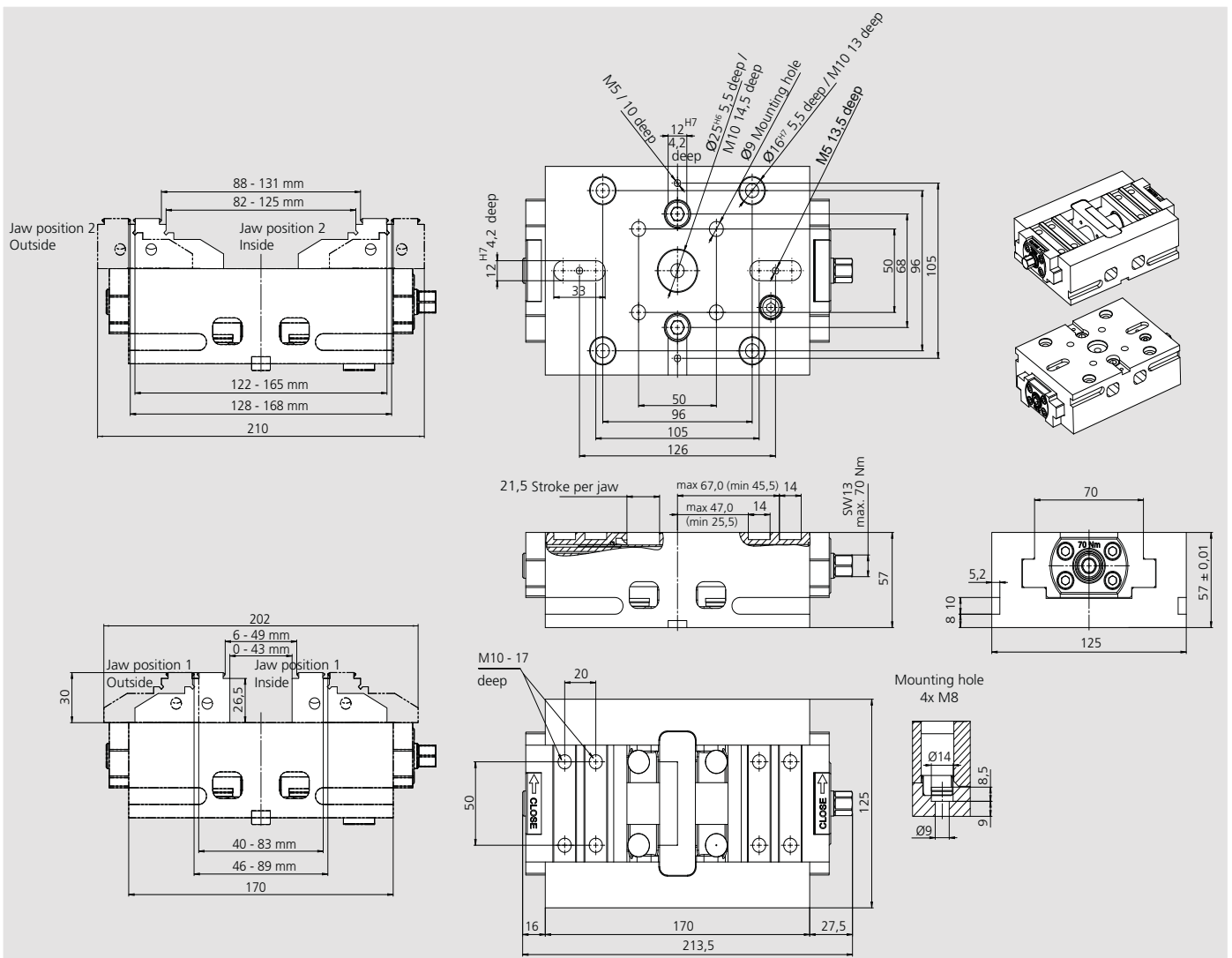

Type	Clamping range in mm	Id. No.
ST5-2G S 125 BASIC with Gripper jaws	0-168	466058
ST5-2G S 125 PREMIUM with SinterGrip jaws STD	0-168	466059
ST5-2G S 125 PREMIUM with SinterGrip jaws ALU	0-168	466059A
ST5-2G S 125 PREMIUM with SinterGrip jaws HRC	0-168	466059H
ST5-2G S 125 without top jaws	0-168	466057

ST5-2G Top jaw BASIC Gripper



1 set = 2 pieces; incl. 4 pcs. mounting screws

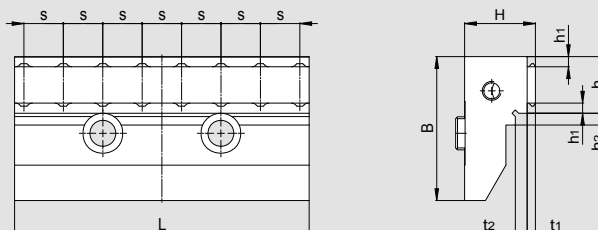

Type	Id. No.	L	B	H	s	h	h1	h2	t1	t2
ST5-2G 080	466107	79.8	47	27.5	10.5 (7x)	18.5	3	4.5	3.5	4.5
ST5-2G 125	466094	124.8	61	30	16.7 (7x)	24	3	5	3.5	5

ST5-2G Top jaw PREMIUM SinterGrip



1 set = 2 pieces, without SinterGrip clamping inserts
incl. 4 pcs. mounting screws

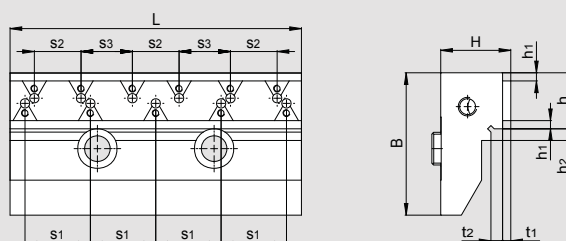

Type	Id. No.	L	B	H	s1	s2	s3	h	h1	h2	t1	t2	SinterGrip per jaw
ST5-2G 080	466108	79.8	47	27.5	22 (3x)	27 (2x)	-	18.5	3.5	5	3.5	4.5	4+3
ST5-2G 125	466095	124.8	61	30	28 (4x)	20 (3x)	22 (2x)	24	3.5	5	3.5	5	6+5

ST5-2G Top jaws BASIC Gripper, extended clamping depth



1 set = 2 pieces; incl. 4 pcs. mounting screws

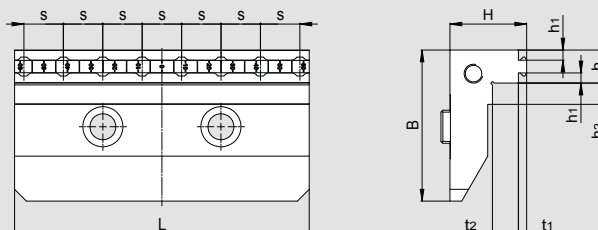

Type	Id. No.	L	B	H	s	h	h1	h2	t1	t2
ST5-2G 080	466187	77	47	26.5	10.5 (7x)	12	3	8	3.5	11
ST5-2G 125	466185	124.8	64	32.5	16.7 (7x)	14	3	9	3.5	11

ST5-2G Top jaws PREMIUM SinterGrip, extended clamping depth



1 set = 2 pieces, without SinterGrip clamping inserts
incl. 4 pcs. mounting screws

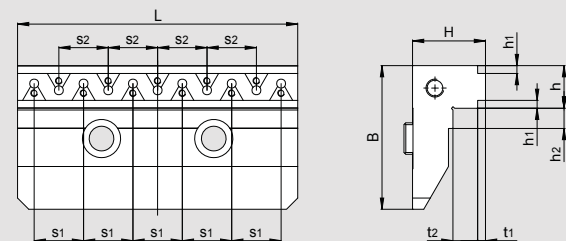

Type	Id. No.	L	B	H	s1	s2	h	h1	h2	t1	t2	SinterGrip per jaw
ST5-2G 080	466188	77	47	26.5	21 (3x)	21 (2x)	19	3.5	8	3.5	11	4+3
ST5-2G 125	466186	124.8	64	32.5	22 (5x)	22 (4x)	19	3.5	9	3.5	11	6+5

ST5-2G Top jaw BASIC Gripper, narrow design



1 set = 2 pieces; incl. 4 pcs. mounting screws

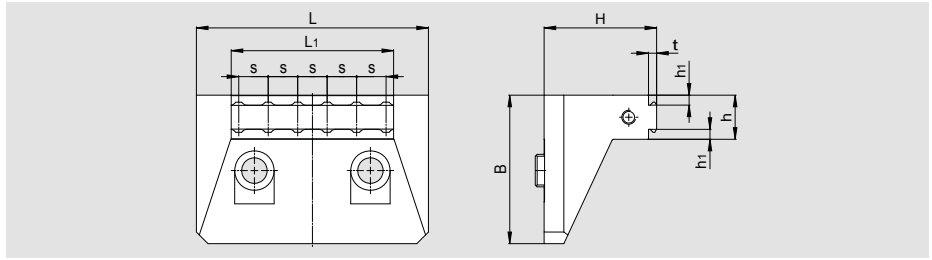

Type	Id. No.	L	B	H	L1	s	t	h	h1
ST5-2G 080	466164	60	47	35.5	45	12.7	3.5	19	3
ST5-2G 125	466166	100	64	48.5	70	12.7	3.5	19	3

ST5-2G Top jaw PREMIUM SinterGrip, narrow design



1 set = 2 pieces, without SinterGrip clamping inserts
incl. 4 pcs. mounting screws

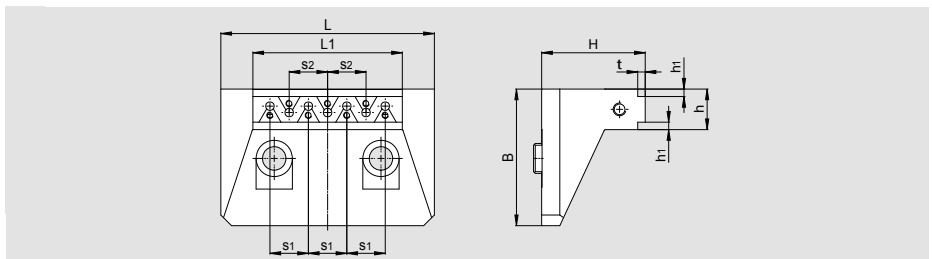

Type	Id. No.	L	B	H	L1	s1	s2	h	h1	t	SinterGrip per jaw
ST5-2G 080	466165	60	47	35.5	45	16	16	19	3.5	3.5	3+2
ST5-2G 125	466167	100	64	48.5	70	18	18	19	3.5	3.5	4+3

ST5-2G Top jaw, 5-axis smooth



1 set = 2 pieces; incl. 4 pcs. mounting screws

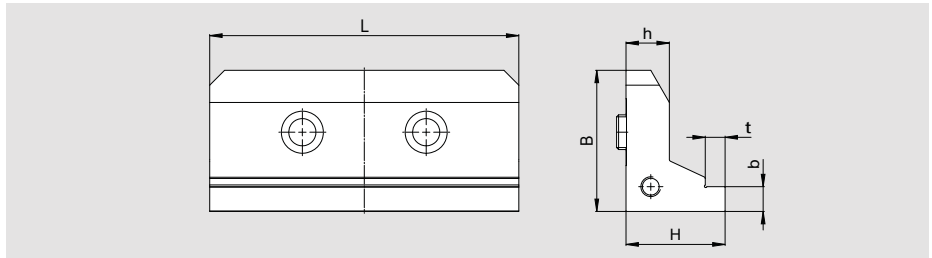

Type	Id. No.	L	B	H	h	b	t
ST5-2G 080	466200	79.8	38.5	30	15.5	8	6
ST5-2G 125	466199	124.8	57	40	17.5	10	8

ST5-2G Soft top jaw, low design, material: 1.0503



1 set = 2 pieces; incl. 4 pcs. mounting screws

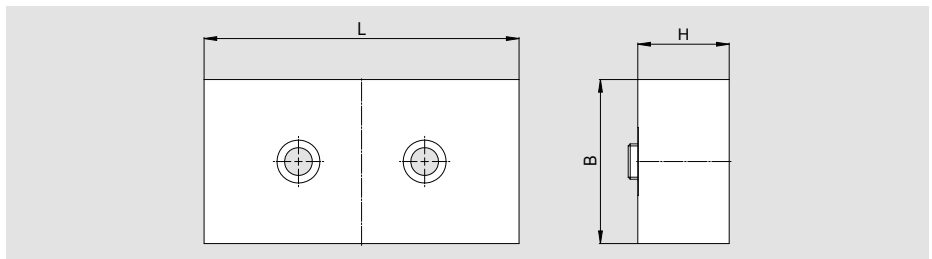

Type	Id. No.	L	B	H
ST5-2G 080	466157-1	79.8	50	29.7
ST5-2G 125	466158-1	124.8	65	36.2

ST5-2G Soft top jaw, high design, material 1.0503



1 set = 2 pieces; incl. 4 pcs. mounting screws

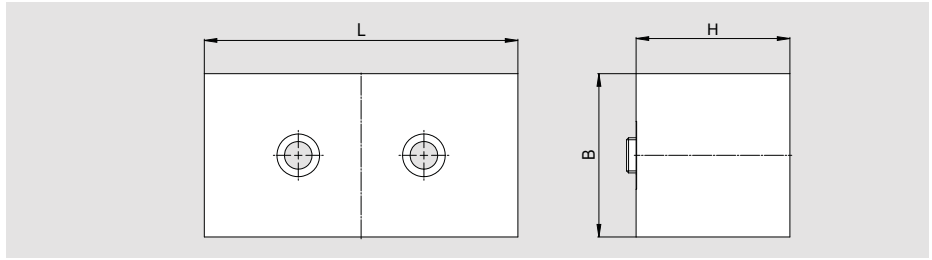

Type	Id. No.	L	B	H
ST5-2G 080	466157-2	79.8	55	52.7
ST5-2G 125	466158-2	124.8	61.2	61.2

ST5-2G Top jaw BASIC Gripper



1 set = 2 pieces; incl. 4 pcs. mounting screws

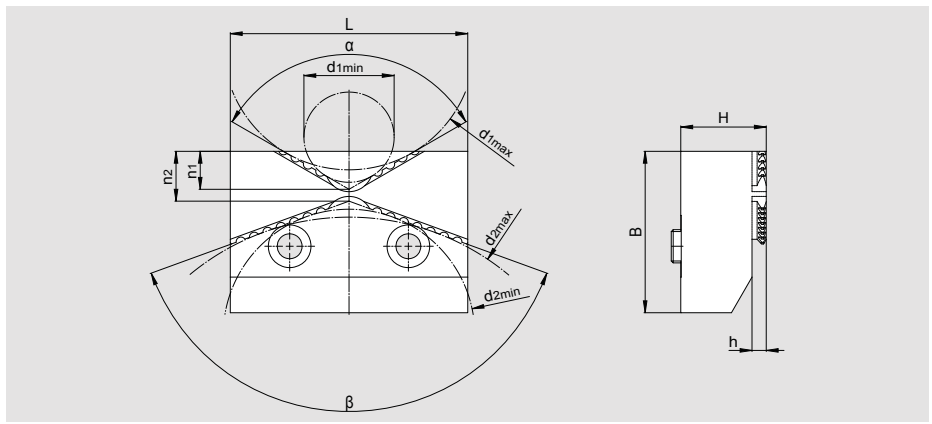

Type	Id. No.	L	B	H	h	d1min	d1max	d2min	d2max	n1	n2	α	β	Clamping range
ST5-2G 080	on request													
ST5-2G 125	466201	100	68	36	6	38	106	106	210	16	21	120°	140°	Ø038-210

ST5-2G Top jaw, smooth, prism jaw



1 set = 2 pieces; incl. 4 pcs. mounting screws

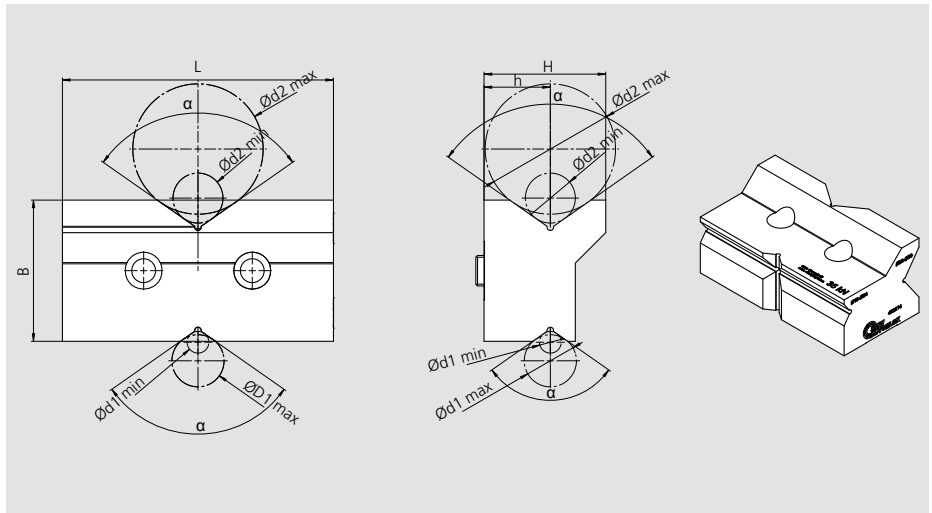

Type	Id. No.	L	B	H	h	d1min	d1max	d2min	d2max	α	Clamping range
ST5-2G 080	466215	79.8	48	38	22	5	13	13	36	110°	Ø5-36
ST5-2G 125	466214	124.8	65	56	30.5	10	24	23	60	110°	Ø10-60

ST5-2G Pull-down jaw



1 set = 2 pull-down jaws, incl. 4 pcs. mounting screws

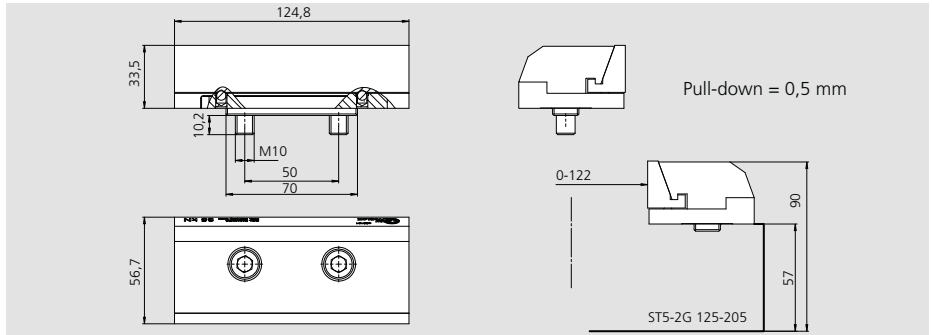

SMW-AUTOBLOK Type

ST5-2G 125 Pull-down jaw

Id. No.

466191

ST5-2G Pendulum jaw, sealed



1 pendulum jaw, incl. 2 pcs. mounting screws without grip inserts and stop pins

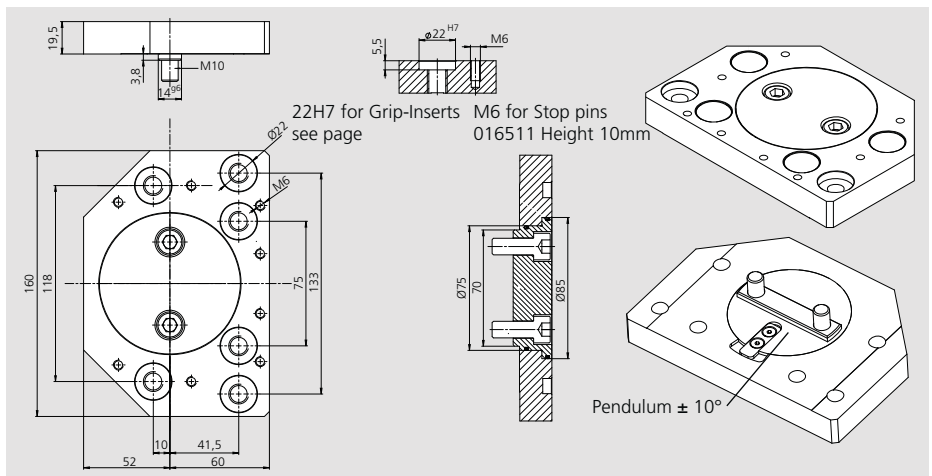

SMW-AUTOBLOK Type

ST5-2G 125 Pendulum jaw

Id. No.

466255

ST5-2G Pendulum jaw fix, sealed



1 pendulum jaw fix, incl. 2 pcs. mounting screws without grip inserts and stop pins

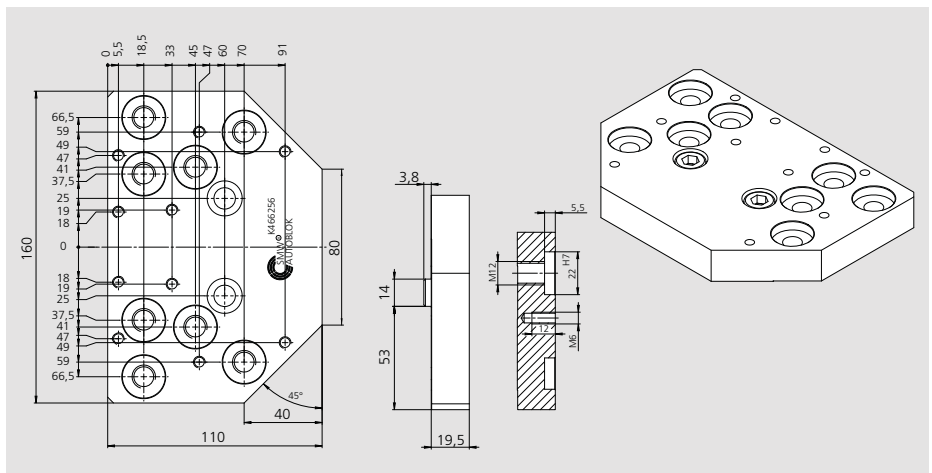

SMW-AUTOBLOK Type

ST5-2G 125 Pendulum fix jaw

Id. No.

466256

Application Examples



Mounting devices for ST5-2G 125-205

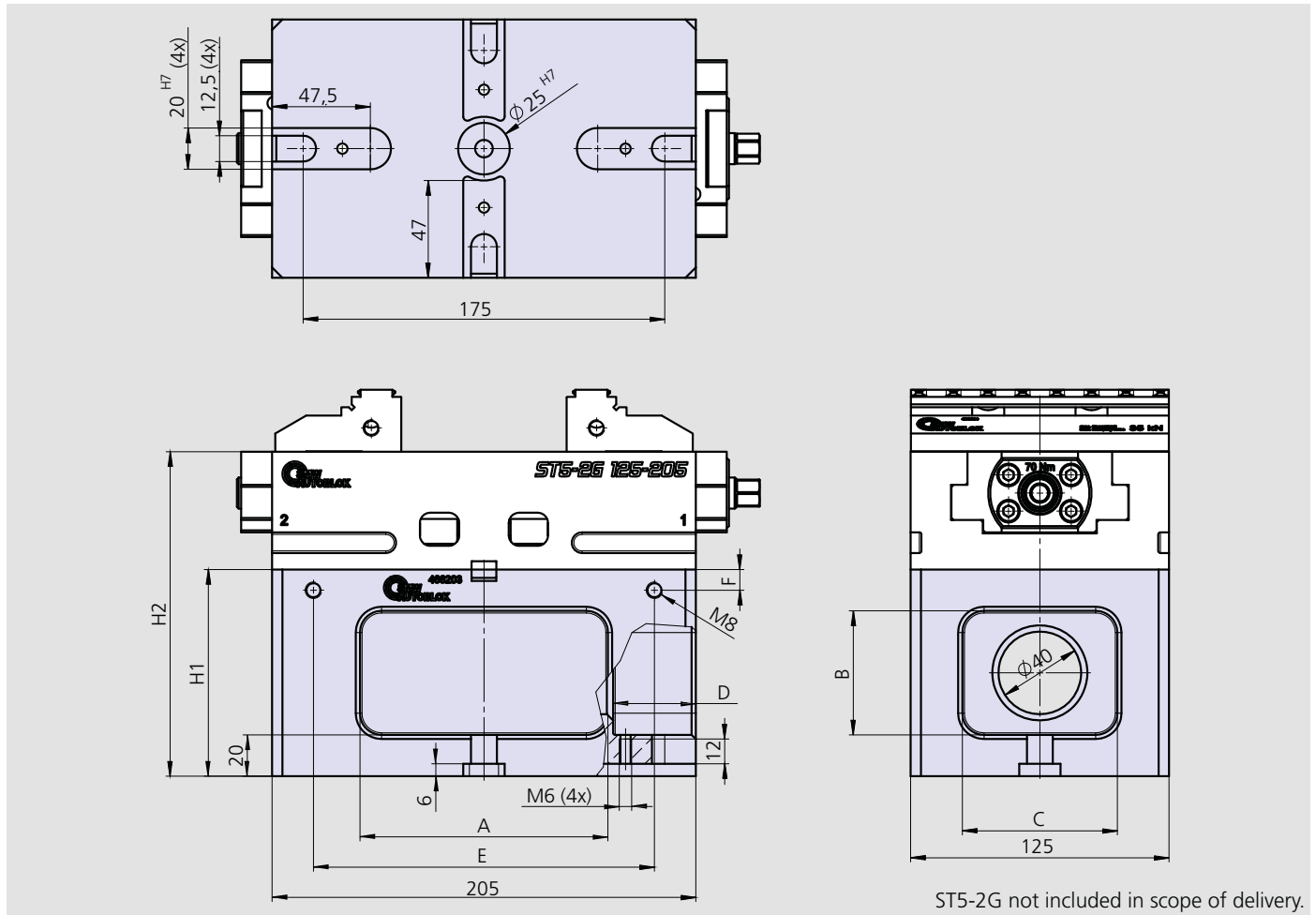

Type	Id. No.	H1	H2	A	B	C	D	E	F
ST5-2G H60	466202	60	117	120	40	70	29/16	145	20
ST5-2G H100	466203	100	157	120	60	75	40	165	10
ST5-2G H120	466204	120	177	120	75	75	40	165	20

Set of clamps

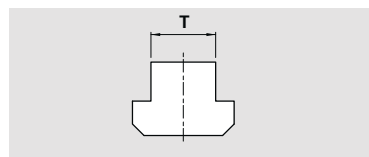

Consisting of:
1 piece clamp
with adjustable mounting
incl. T-nut and screw

Type	T	Id. No.						
		10 mm	12 mm	14 mm	16 mm	18 mm	20 mm	22 mm
ST5-2G 080		466150	466151	466152	466153	466154	466155	-
ST5-2G 125		-	466142	466143	466144	466145	466146	466147

Pair of positioning keys (special dimensions)

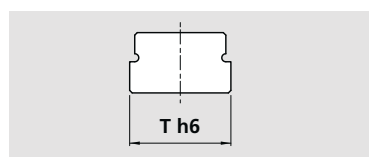
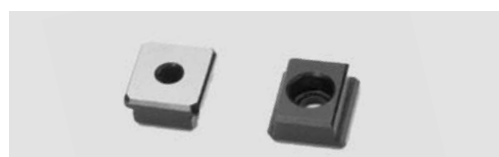

Pair of positioning keys for T-slots

Type	Th6	Id. No.					
		12 mm - h6	14 mm - h6	16 mm - h6	18 mm - h6	20 mm - h6	22 mm - h6
ST5-2G		58011592	58011593	58011594	58011595	58011596	58011597

Key for single use



Positioning key for zero point APS

Type for	Id. No.
APS-140 F7	46 16 23 28
APS-140 H7	46 16 23 29

ST5-2G 080 Overview configurations

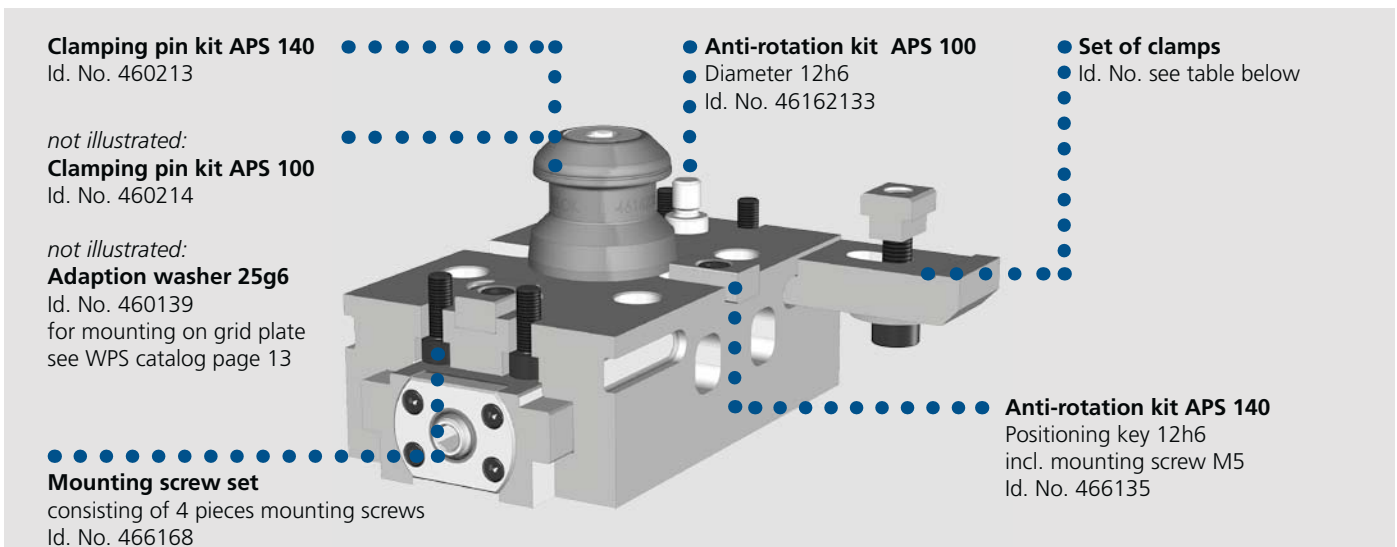

ST5-2G 125 Overview configurations

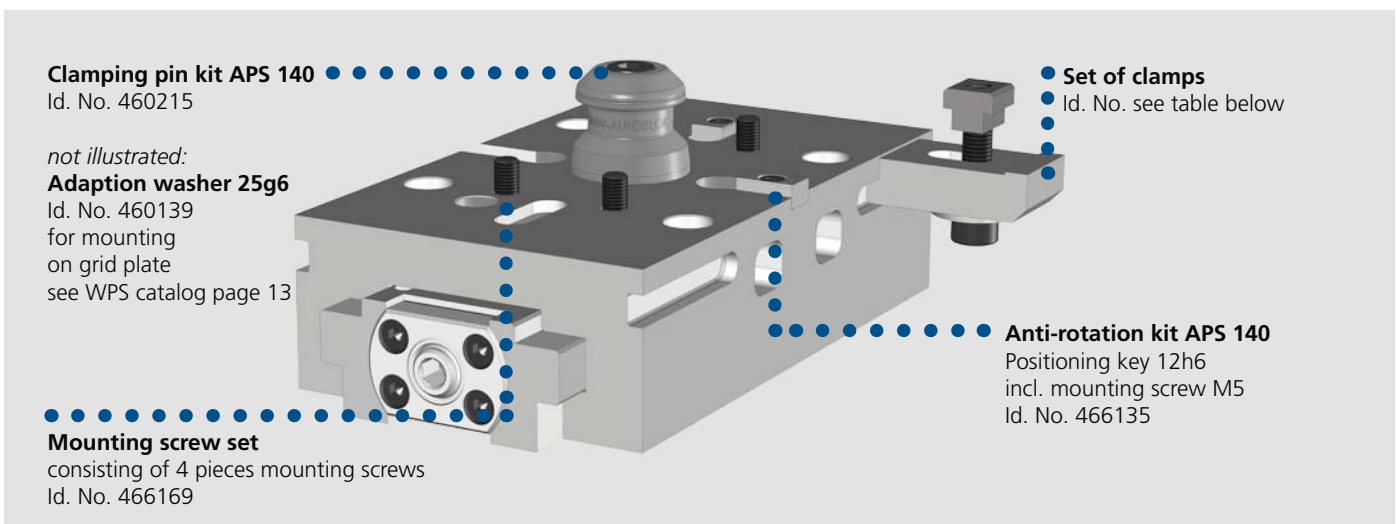

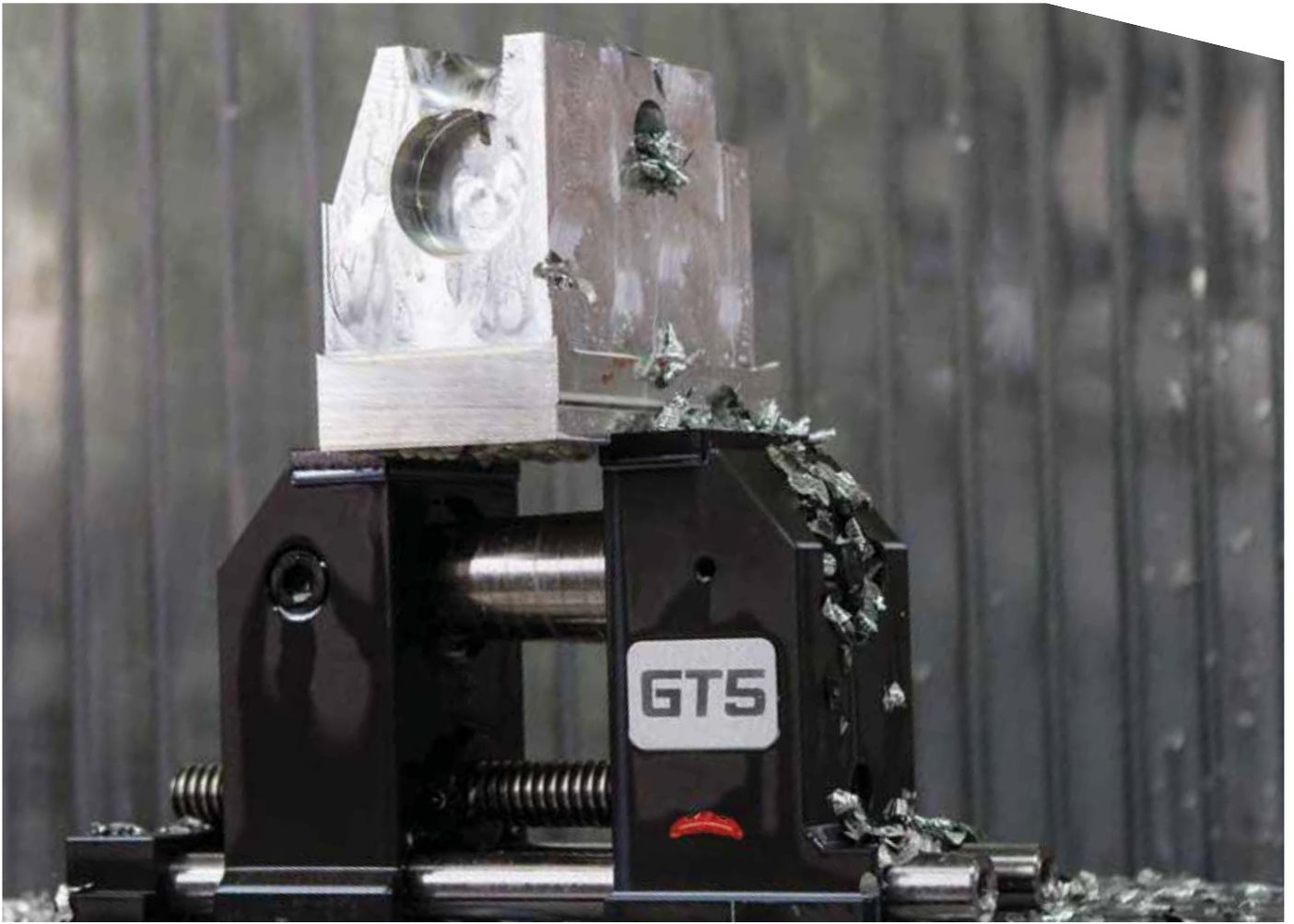

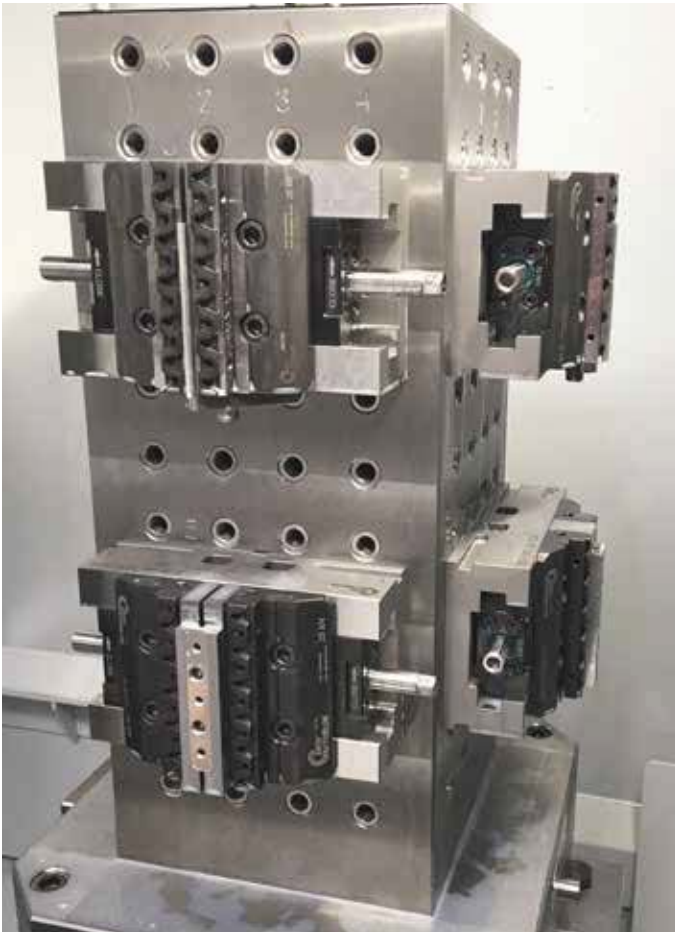

ST5-HD 125-320

Heavy Duty Self-centering vice

- Sealed – safed spindle
- Central clamping



Application/customer benefits

- Heavy duty high precise 5-axis centric clamping vice with highest repeatability
- Sealing for protection against contamination
- Compact design for best accessibility and with large chip ejection windows
- PREMIUM: Jaws with SinterGrip clamping inserts for lowest clamping depth of the workpiece without pre-marking
- Extra large clamping range
- Ideal for OP 10 and OP 20

Technical features

- Central clamping
- Manual actuation on both sides (SW 17)
- Clamping range 0 until 246 mm
- Clamping force up to 60 kN (100 Nm)
- Jaw width 125 mm
- Interface for zero point clamping systems APS / WPS and Lang 96 mm as a standard

Standard equipment

5-axis machine tool with wrench, BASIC: 1 pair top jaws Gripper
 PREMIUM: SinterGrip top jaws with 14 pieces SinterGrip clamping inserts for steel and 14 pieces protective cover and mounting bolts

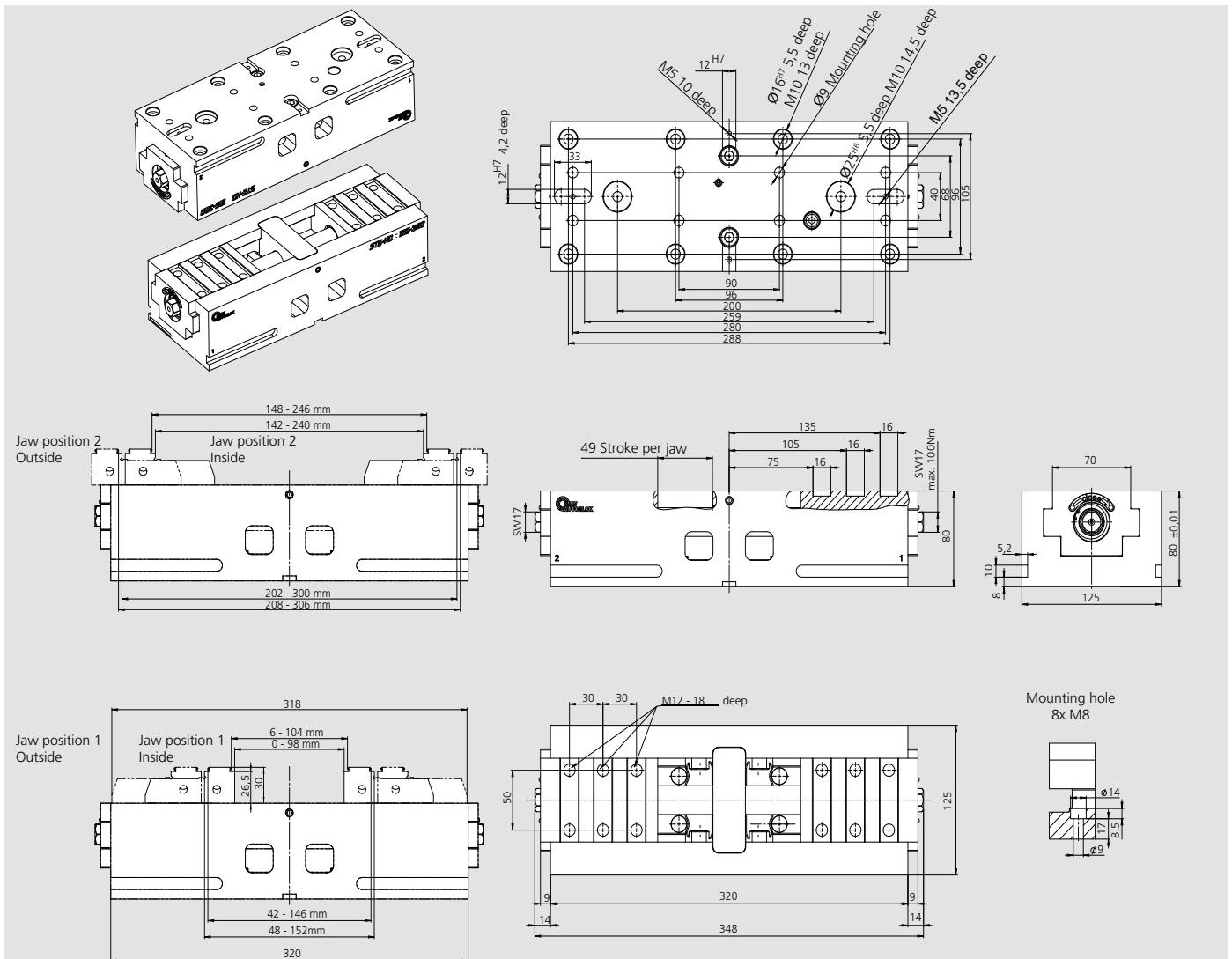

Type	Clamping range in mm	Id. No.
ST5-HD 125-320 BASIC with Gripper jaws	0-246	466122
ST5-HD 125-320 PREMIUM with SinterGrip jaws STD	0-246	466123
ST5-HD 125-320 PREMIUM with SinterGrip jaws ALU	0-246	466123A
ST5-HD 125-320 PREMIUM with SinterGrip jaws HRC	0-246	466123H
ST5-HD 125-320 without top jaws	0-246	466230

ST5-HDF 125-320

Heavy Duty Fixed jaw vice

- Sealed – safed spindle
- Clamping against fixed 1 jaw



Application/customer benefits

- Heavy duty high precise 5-axis centric clamping vice with highest repeatability
- Sealing for protection against contamination
- Compact design for best accessibility and with large chip ejection windows
- PREMIUM: Jaws with SinterGrip clamping inserts for lowest clamping depth of the workpiece without pre-marking
- Extra large clamping range
- Ideal for OP 10 and OP 20

Technical features

- Clamping against 1 fixed jaw
- Manual actuation (SW 17)
- Clamping range 0 until 257 mm
- Clamping force up to 50 kN (100 Nm)
- Jaw width 125 mm
- Interface for zero point clamping systems APS / WPS and Lang 96 mm as a standard

Standard equipment

5-axis machine tool with wrench, BASIC: 1 pair top jaws Gripper
 PREMIUM: SinterGrip top jaws with 12 pieces SinterGrip clamping inserts for steel and 12 pieces protective cover and mounting bolts

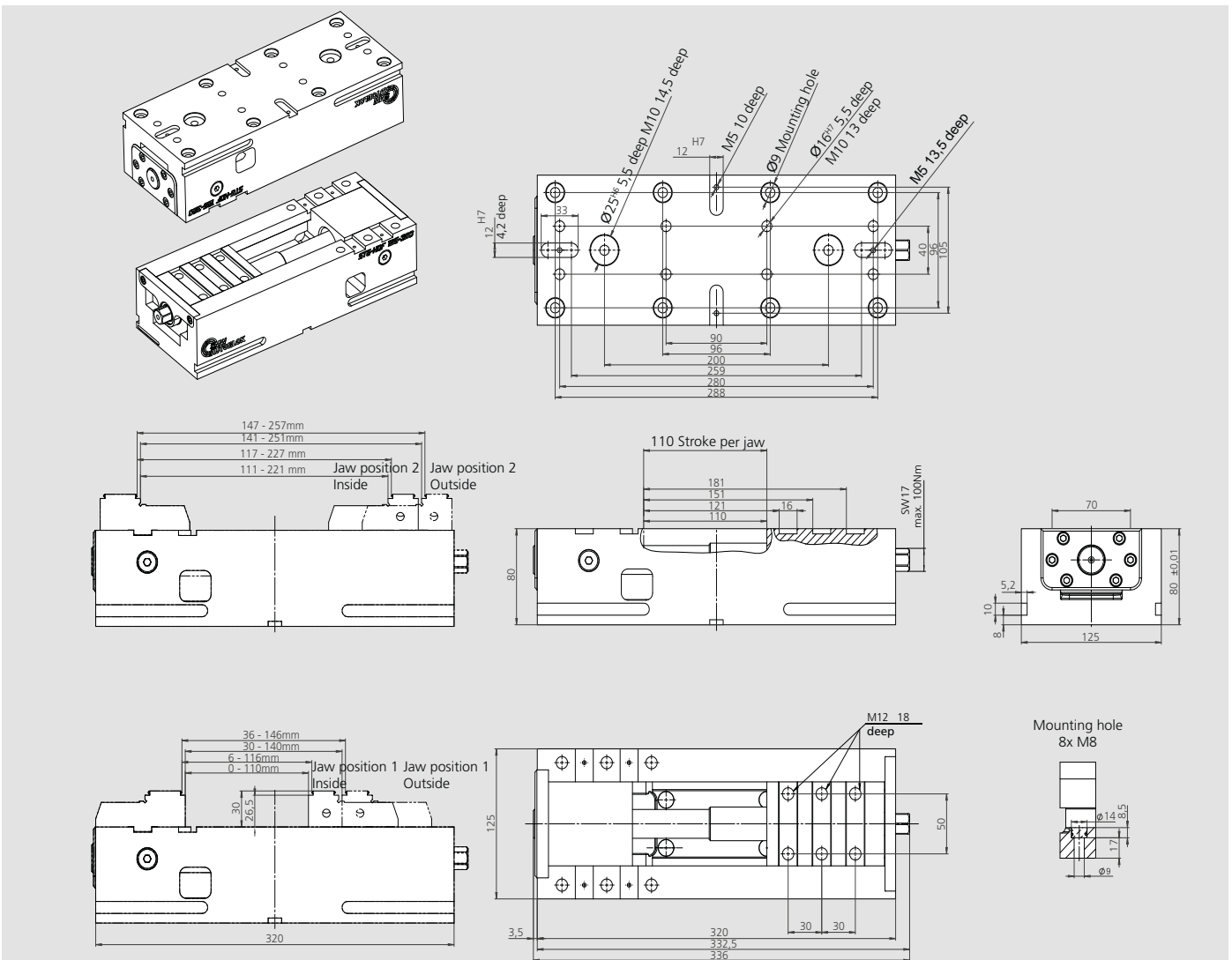

Type	Clamping range in mm	Id. No.
ST5-HDF 125 BASIC with Gripper jaws	0-257	466126
ST5-HDF 125 PREMIUM with SinterGrip jaws STD	0-257	466127
ST5-HDF 125 PREMIUM with SinterGrip jaws ALU	0-257	466127A
ST5-HDF 125 PREMIUM with SinterGrip jaws HRC	0-257	466127H
ST5-HDF 125 without top jaws	0-257	466270

ST5-HD/HDD Top jaws BASIC Gripper (Set with 2 jaws)



1 set = 2 pieces top jaws incl. 4 pcs. mounting screws

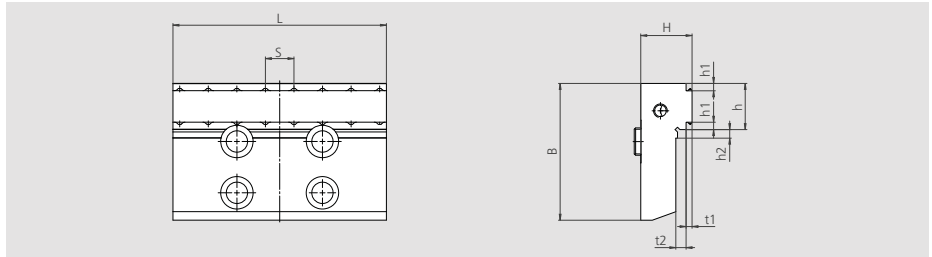

Type	Id. No.		L	B	H	S	h	h1	h2	t1	t2
ST5-HD(D) 125	466298	Top jaw	124.8	80	30	16.7 (7x)	27	3	5	3.5	5

ST5-HDF Top jaws BASIC Gripper (Set with 1 fix jaw and 1 movable top jaw)

Fix Jaw



Movable Top Jaw



1 set = 1 fix jaw, 1 movable top jaw, incl. 4 pcs. mounting screws

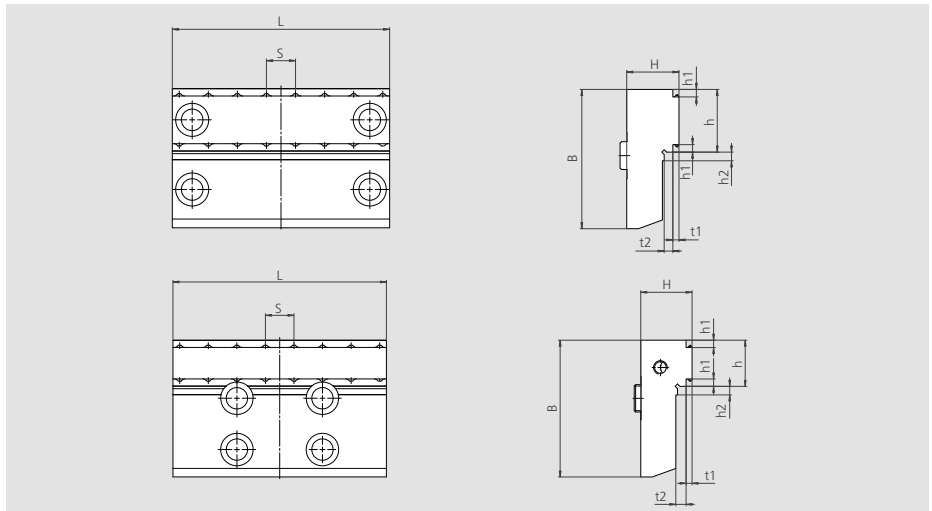

Type	Id. No.		L	B	H	S	h	h1	h2	t1	t2
ST5-HDF 125	466299	Fix jaw	124.8	80	30	16.7 (7x)	36	3	5	3.5	5
		Movable Top jaw	124.8	80	30	16.7 (7x)	27	3	5	3.5	5

ST5-HD/HDD Top jaws PREMIUM (Set with 2 jaws)



1 set = 2 pcs. top jaws; without SinterGrip clamping inserts, incl. 4 pcs. mounting screws

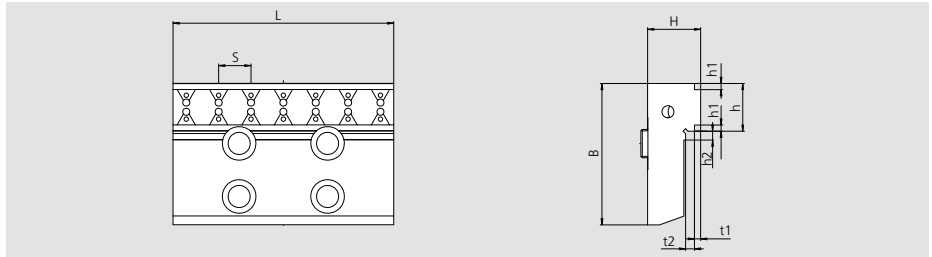

Type	Id. No.		L	B	H	S	h	h1	h2	t1	t2	SinterGrip per jaw
ST5-HD(D) 125	466300	Top jaw	124.8	80	30	18.3 (7x)	27	3	5	3.5	5	7+7

ST5-HDF Top jaws PREMIUM (Set with 1 fix jaw and 1 movable top jaw)

Fix Jaw



Movable Top Jaw



1 set = 1 fix jaw, 1 movable top jaw, without SinterGrip clamping inserts, incl. 4 pcs. mounting screws

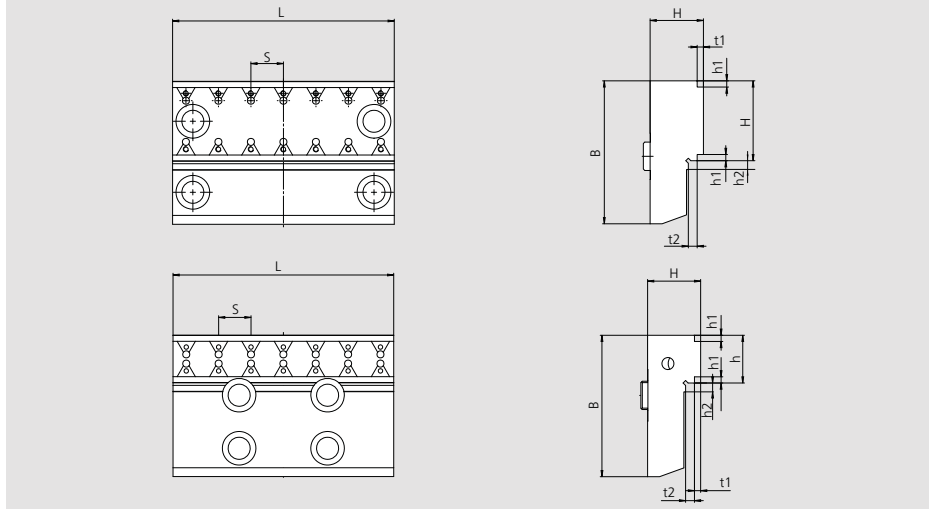

Type	Id. No.		L	B	H	S	h	h1	h2	t1	t2	SinterGrip per jaw
ST5-HDF 125	466301	Fix jaw	124.8	80	30	18.3 (7x)	45	3	5	3.5	5	7+7
		Movable Top jaw	124.8	80	30	18.3 (7x)	27	3	5	3.5	5	7+7

ST5-HD/HDD Top jaws PREMIUM Higher Version (Set with 2 jaws)

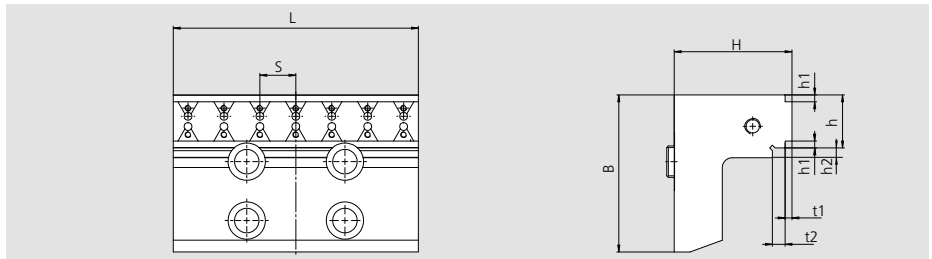

Type	Id. No.		L	B	H	S	h	h1	h2	t1	t2	SinterGrip per jaw
ST5-HD(D) 125	466302	Top jaw	124.8	80	60	18.3 (7x)	27	3	5	3.5	6.5	7+7

ST5-HDF Top jaws PREMIUM Higher Version (Set with 1 fix jaw and 1 movable top jaw)

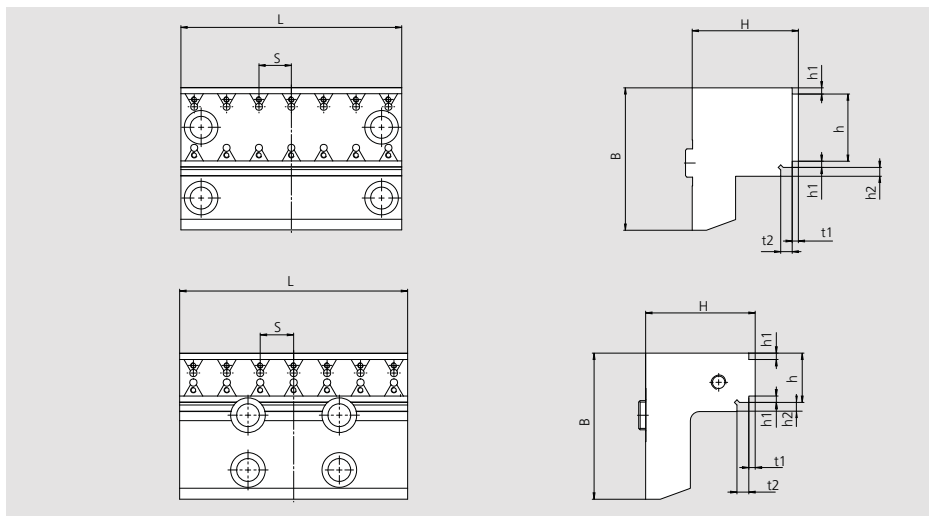

Type	Id. No.		L	B	H	S	h	h1	h2	t1	t2	SinterGrip per jaw
ST5-HDF 125	466303	Fix jaw	124.8	80	60	18.3 (7x)	45	3	5	3.5	6.5	7+7
		Movable Top jaw	124.8	80	60	18.3 (7x)	27	3	5	3.5	6.5	7+7

ST5-HD/HDD Top jaws Smooth (Set with 2 jaws)



1 set = 2 pieces top jaws incl. 4 pcs. mounting screws

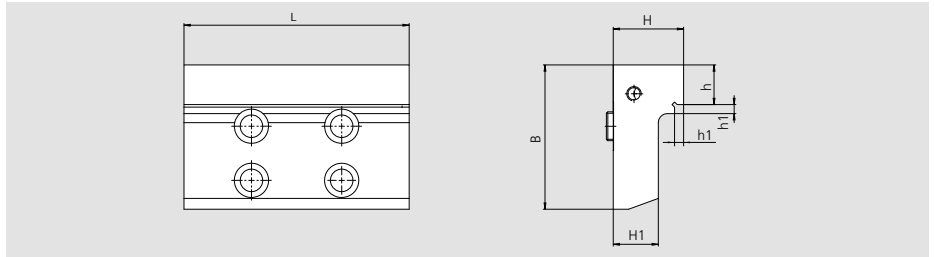

Type	Id. No.		L	B	H	H1	h1	h
ST5-HD(D) 125	466304	Top jaw	124.8	80	39	25	5	22

ST5-HDF Top jaws Smooth (Set with 1 fix jaw and 1 movable top jaw)

Fix Jaw



Movable Top Jaw



1 set = 1 fix jaw, 1 movable top jaw, incl. 4 pcs. mounting screws

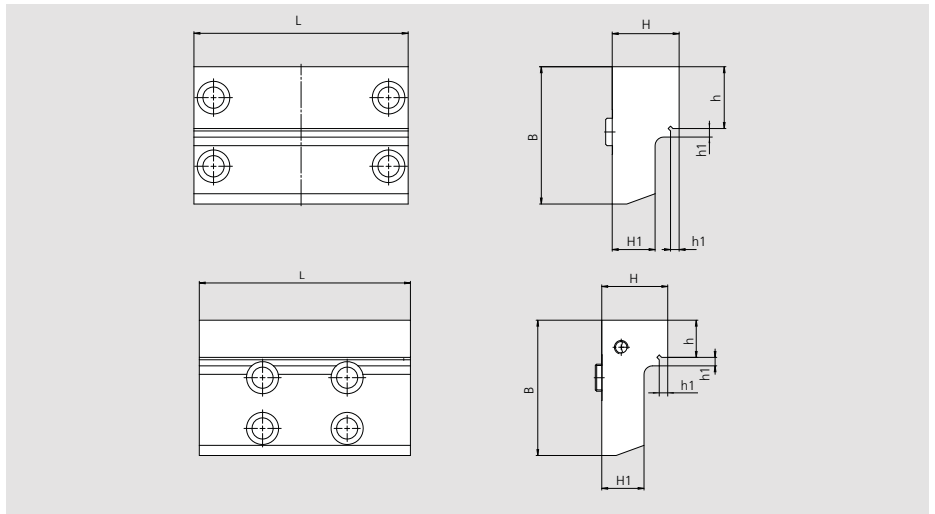

Type	Id. No.		L	B	H	H1	h1	h
ST5-HDF 125	466305	Fix jaw	124.8	80	39	25	5	36
		Movable Top jaw	124.8	80	39	25	5	22

Example: Clamping of a workpiece by using grip inserts

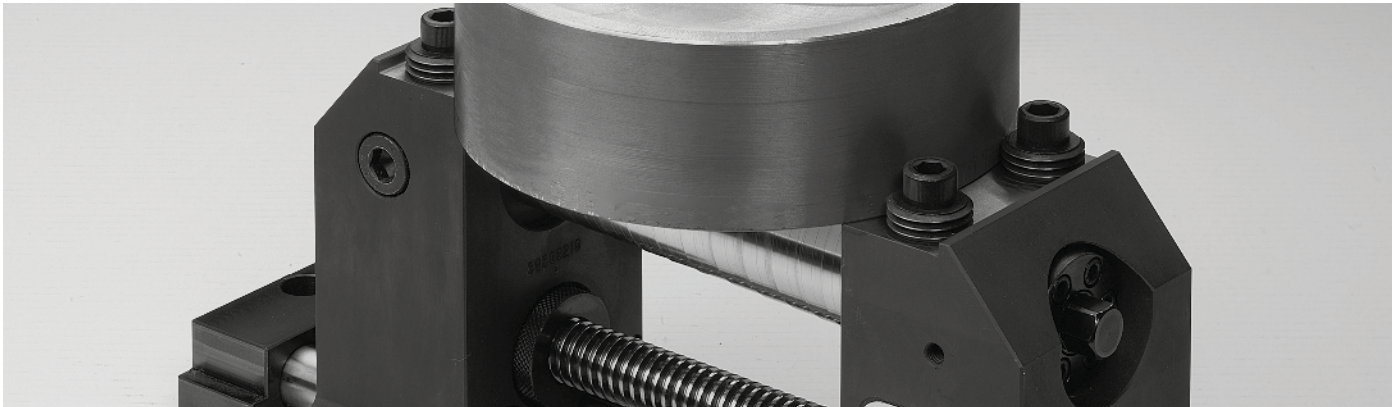

Grip insert smooth, height 11 mm

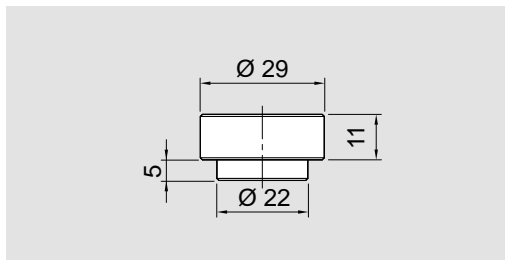

Smooth
Height 11 mm
Set consisting of 4 grippers
and 4 fixing screws

Type	Id. No.
GT5 / ST5-2G	58906114

Grip insert serrated, height 11 mm

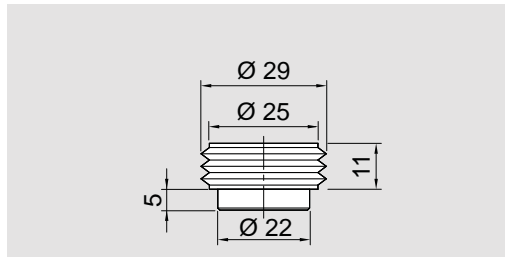

Serrated
Height 11 mm
Set consisting of 4 grippers
and 4 fixing screws

Type	Id. No.
GT5 / ST5-2G	58906124

Grip insert smooth, height 19 mm

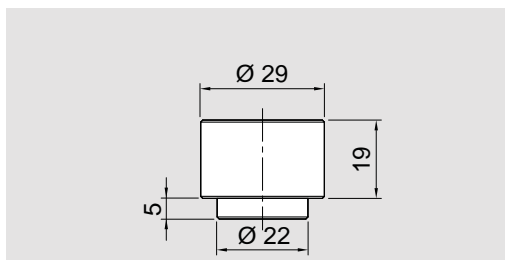

Smooth
Height 19 mm
Set consisting of 4 grippers
and 4 fixing screws

Type	Id. No.
GT5 / ST5-2G	58906214

■ Grip Inserts for GT5/ST5-2G

Grip insert serrated, height 19 mm

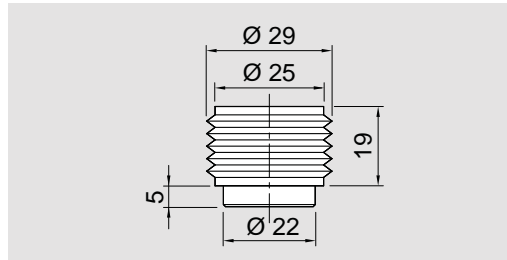

Serrated
Height 19 mm
Set consisting of 4 grippers
and 4 fixing screws

Type	Id. No.
GT5 / ST5-2G	58906224

Grip insert smooth, height 24 mm

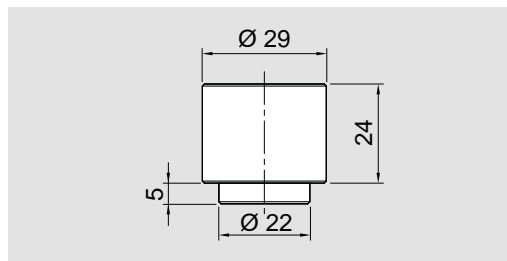

Smooth
Height 24 mm
Set consisting of 4 grippers
and 4 fixing screws

Type	Id. No.
GT5 / ST5-2G	58906314

Grip insert serrated, height 24 mm

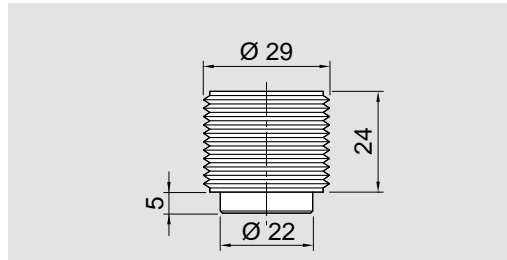

Serrated
Height 24 mm
Set consisting of 4 grippers
and 4 fixing screws

Type	Id. No.
GT5 / ST5-2G	58906324

Grip insert Multigrip 12.5 mm

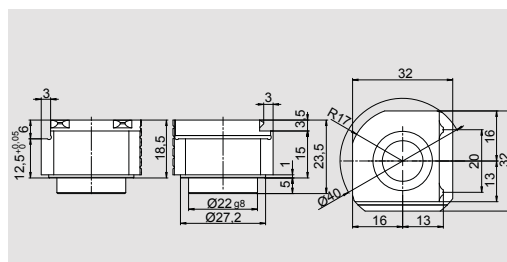
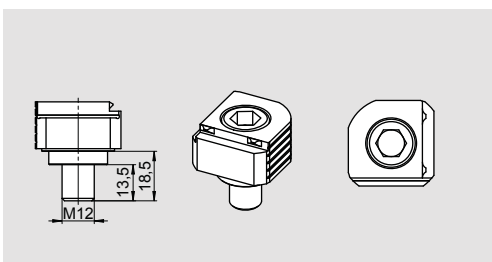

Multigrip
Height 12.5 mm
Set consisting of 1 gripper
and 1 fixing screw

Type	Id. No.
GT5 / ST5-2G	466228

Stop pins ALB

SMW-AUTOBLOK Type	Id. No.	G	H	SW
ALB 605	016513	M6	5	10
ALB 610	016511	M6	10	10
ALB 615	016512	M6	15	10
ALB 620	017602	M6	20	10

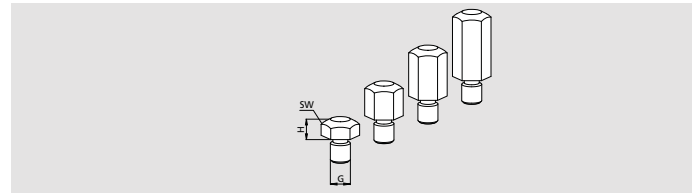

Twin Vices



STV-2

Spring and air operated vice 125, 180, 225

- Protected
- Springs to clamp, pneumatic to open
- Turbo function to increase the clamping forces
- Pneumatic jaw stroke control valve
- Normal stroke: STV-2N / Long stroke: STV-2L
- Air purge
- Air sensing

Page

32



STV-3

Spring and air operated vice 125, 180, 225

- Protected
- 3 jaws
- Springs to clamp, pneumatic to open
- Turbo function to increase the clamping forces
- Normal stroke: STV-3N
- Pneumatic jaw stroke control valve
- Air purge

Page

34



STV

Spring and Air operated

STV-2



Function:

- Springs to clamp
- Turbo function to increase the clamping forces
- Pneumatic to open



proofline® series
fully sealed – low maintenance

STV-3



Function:

- Springs to clamp
- Turbo function to increase the clamping forces
- Pneumatic to open

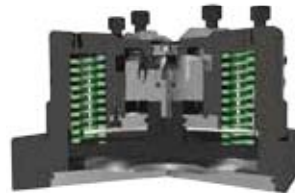

proofline® series
fully sealed – low maintenance

Proximities stroke control

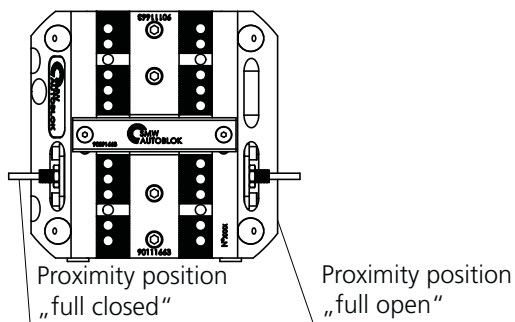
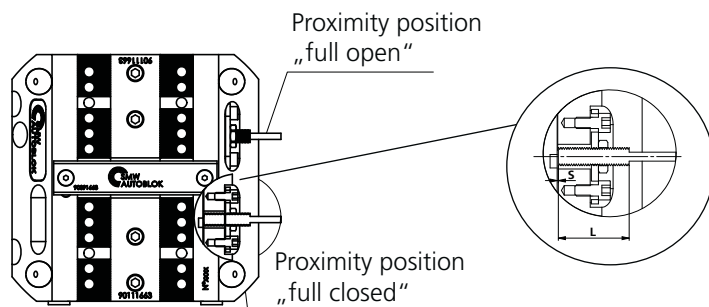

SinterGrip

For lowest clamping depth of workpieces and without pre-marking





ed Power Vices

Convincing advantages

- Protected against contamination of swarf and chips, fully sealed (proofline)
- Compact design
- Highest repeatability
- Highest rigidity
- Housing and functional parts hardened for high precision and long life
- Air purge
- Master jaws with both tongue & groove and fine serration 1.5 mm x 60°
- OD clamping only
- Air sensing (only STV-2)
- Self-centering vice without top jaws
- All bolts and centering bushings included



Industry 4.0
Product



Safety valve SAB-1

- Safety valve SAB-1 to maintain air pressure during pallet transportation/storage and machining without feed
- Easy and smart opening of the vice by air gun
- Turbo function to increase the clamping forces

Pneumatic jaw stroke control valve (optional)

- For the monitoring of the jaw position
- Direct connection through the plate or the tombstone
- No cables needed
- Ideal for automation

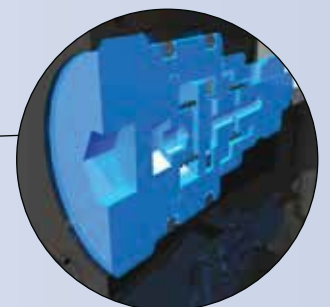

STV-2N

STV-2L

Spring and air operated twin vice

NORMAL STROKE

LONG STROKE

- Protected
- Springs clamping
- Pneumatic jaw stroke control valve



Application/customer benefits

- Protected against contamination of swarf and chips, fully sealed (proofline)
- Compact design
- Highest repeatability
- Highest rigidity

Technical features

- Spring to clamp, pneumatic open
- Increase of the clamping force via Turbo function
- Housing and functional parts hardened for high precision and long life
- Air purge
- Master jaws with both Tongue & Groove and fine serration 1.5 mm x 60°
- OD clamping only
- Safety valve SAB-1 to maintain air pressure during pallet transportation/storage and machining without feed (optional)
- Pneumatic jaw stroke control valve (optional)
- Stroke control via proximity switches (optional)
- Air sensing

Standard equipment

Self-centering vice without top jaws
All bolts and centering bushings included

Actual gripping force diagrams

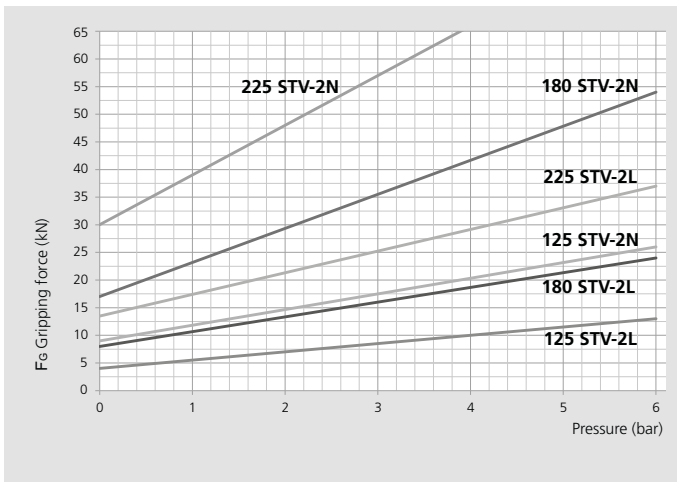

SAB-1 safety valve

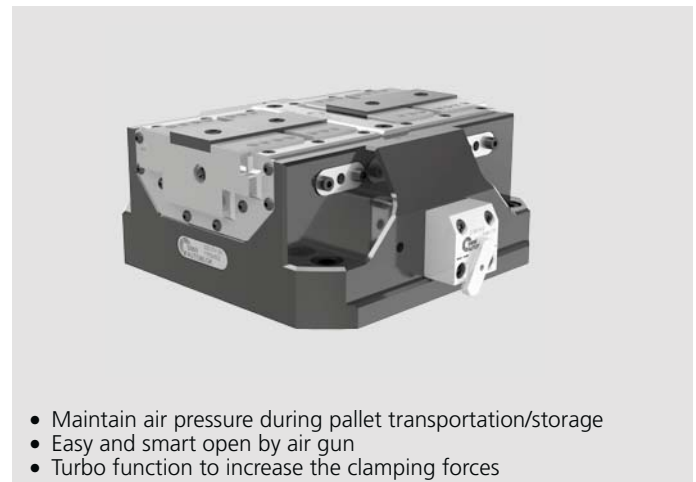

- Maintain air pressure during pallet transportation/storage
- Easy and smart open by air gun
- Turbo function to increase the clamping forces

Technical data

Type	Id. No.	Id. No. incl. SAB-1 valve	Type Stroke	Max. clamping force middle stroke		Stroke/ Jaw mm	Piston area cm ²	Re- opening pressure bar	Ope- rating pressure bar	Repea- tability mm	Weight kg
				Springs kN	Springs+Turbo kN						
125 STV-2N	77904312	77904812	Normal	9	26	2.6	78	5	6	0.01	7
125 STV-2L	77904412	77904818	Long	4	13	6	78	5	6	0.01	7
180 STV-2N	77904318	77904822	Normal	17	54	3	170	5	6	0.01	17.5
180 STV-2L	77904418	77904912	Long	8	24	8.4	170	5	6	0.01	17.5
225 STV-2N	77904322	77904918	Normal	30	66	4.2	250	6	4	0.02	28
225 STV-2L	77904422	77904922	Long	13.5	37	10.2	250	6	6	0.02	28

Spring and air operated twin vice

STV-2N

STV-2L

- Protected
- Springs clamping
- Pneumatic jaw stroke control valve

NORMAL STROKE

LONG STROKE

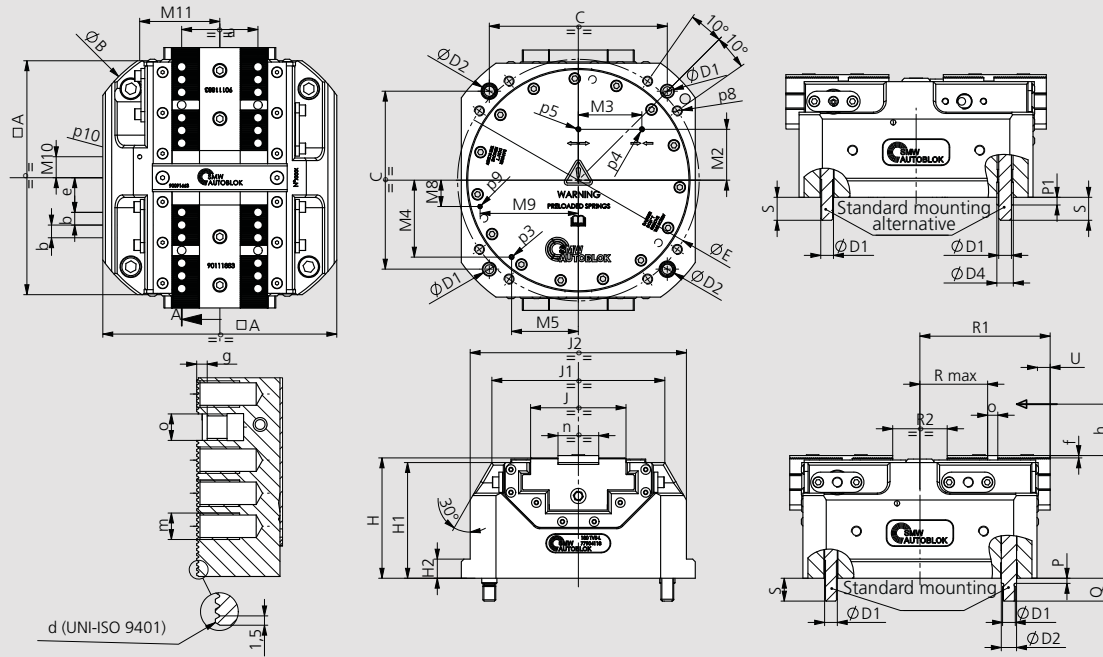

SMW-AUTOBLOK Type			STV-2 125	STV-2 180	STV-2 225
	A	mm	125	184	225
	B(Ø)	mm	162	225	284
	C	mm	100	140	180
	D1(Ø)	mm	M8	M10	M12
	D2 (Øf7)	mm	10	12	14
	D4 (Øjs7)	mm	11	13	16
	E (Ø)	mm	136	190	240
	H	mm	80.5	94.7	102
	H1	mm	77	91	98
	H2	mm		15	15
	J	mm	47	75	94
	J1	mm	100	136	172
	J2	mm	125	170	216
	M2	mm	32	40	50
	M3	mm	29.5	50	65
	M4	mm	40.5	60.5	79
	M5	mm	38.5	52.5	63
	P	mm	4	4	5
	P1	mm	4	6	6
	Q	mm	15	18	20
min/max (long stroke)	R max	mm	25.6/31.6	44.8/53.2	54.5/64.7
min/max (normal stroke)	R max	mm	25.4/28	45/48	54.5/58.7
min/max (long stroke)	R1	mm	64.5/70.5	94/102.4	114.5/124.7
min/max (normal stroke)	R1	mm	64.4/67	94.5/97.5	114.8/119
min/max (long stroke)	R2	mm	20/32	26/42.8	30/50.4
min/max (normal stroke)	R2	mm	19.8/25	26/32	30.6/39
	S	mm	15	18	20
long stroke	U	mm	6	8.4	10.2
normal stroke	U	mm	2.6	3	4.2
	a	mm	35	60	80
	b	mm	7	10	10
serration	d	mm	1.5x60°	1.5x60°	1.5x60°
min/max (long stroke)	e	mm	14.6/20.6	18.8/27.2	28.5/38.7
min/max (normal stroke)	e	mm	14.4/17	19/22	28.5/32.7
	f	mm	1.8	1.8	2
	g	mm	2.7	3.2	4
	h	mm	16	25	35
	m	mm	M6x10	M8x12	M8x12
	n (g6)	mm	20	32	40
	o (H7)	mm	6	8	8
	p3	mm	M4	M4	M4
	p4	mm	M4	M4	M4
	p5	mm	M4	M4	M4
	p8	mm	M6x12	M8x16	M10x18
	p9	mm	M4	M4	M4
	p10	mm	M4	M4	M4
	M8	mm	10.6	20.7	15
	M9	mm	54.5	77.3	99.9
	M10	mm	10.5	16.5	15
	M11	mm	46	63	81

STV-3N

NORMAL STROKE

Spring and air operated twin vice

- Protected
- 3 jaws
- Springs clamping
- Pneumatic jaw stroke control valve



Application/customer benefits

- Protected against contamination of swarf and chips, fully sealed (proofline)
- Compact design
- Highest repeatability
- Highest rigidity

Technical features

- Spring to clamp, pneumatic open
- Increase of the clamping force via Turbo function
- Housing and functional parts hardened for high precision and long life
- Air purge
- Master jaws with both Tongue & Groove
- OD clamping only
- Safety valve SAB-1 to maintain air pressure during pallet transportation/storage and machining without feed
- Pneumatic jaw stroke control valve (optional)

Standard equipment

Self-centering vice without top jaws
All bolts and centering bushings included

Actual gripping force diagrams

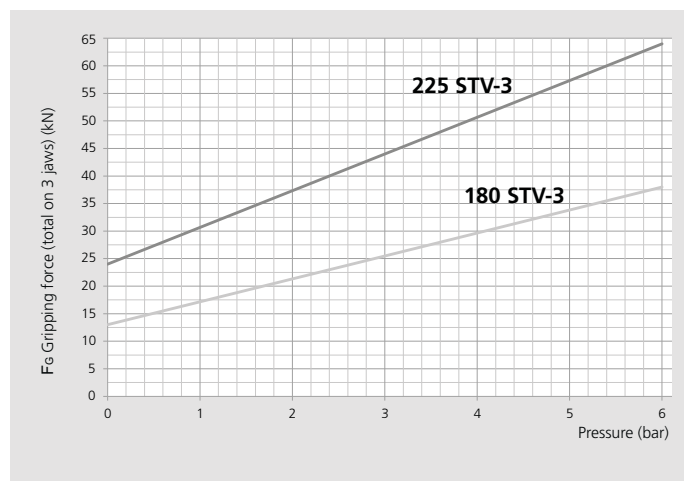

SAB-1 safety valve



Technical data

Type	Id. No.	Id. No. incl. SAB-1 valve	Type Stroke	Max. clamping force middle stroke		Stroke/ Jaw mm	Piston area cm ²	Re- opening pressure bar	Ope- rating pressure bar	Weight kg
				Springs kN	Springs+Turbo kN					
125 STV-3	on request	on request	Normal							
180 STV-3	77904618	77905018	Normal	13	38	3.8	170	5	6	18
225 STV-3	77904622	77905022	Normal	24	64	4.2	250	6	6	29.5

Spring and air operated twin vice

- Protected
- 3 jaws
- Springs clamping
- Pneumatic jaw stroke control valve

STV-3N

NORMAL STROKE

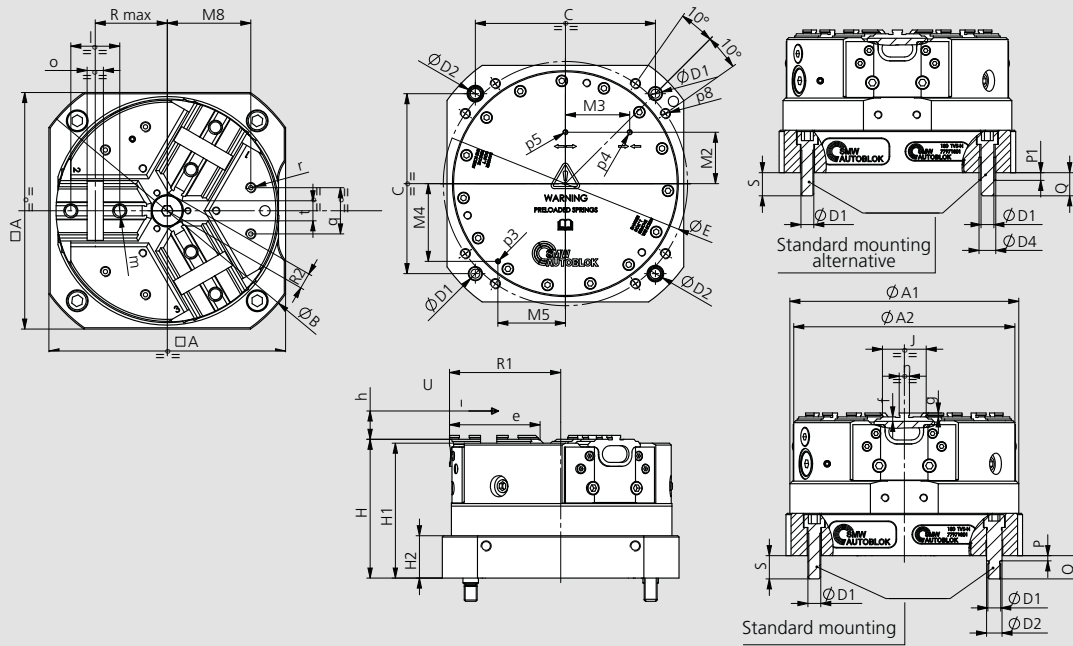

SMW-AUTOBLOK Type			STV-3 180	STV-3 225
	A	mm	184	225
	A1	mm	178	222
	A2	mm	172	216
	B(Ø)	mm	225	284
	C	mm	140	180
	D1(Ø)	mm	M10	M12
	D2 (Øf7)	mm	12	14
	D4 (Øjs7)	mm	13	16
	E (ø)	mm	190	240
	H	mm	108	115
	H1	mm	105	112
	H2	mm	33	38
	J	mm	34	46
	M2	mm	40	50
	M3	mm	50	65
	M4	mm	60.5	79
	M5	mm	52.5	63
	M8	mm	65	80
	P	mm	4	5
	P1	mm	6	6
	Q	mm	18	20
min/max	R max	mm	52.2/56	67.8/72
min/max	R1	mm	82.7/86.5	103.8/108
min/max	R2	mm	8.7/12.5	12.8/17
	S	mm	18	20
	U	mm	3.8	4.2
	e	mm	70	87
	f	mm	3.5	3.5
	g	mm	3	3
	h	mm	25	35
	l	mm	38	44.4
	m	mm	M10x12	M12x14
	n (h8)	mm	7.94	7.94
	o (H7)	mm	12.68	12.68
Air stroke control or Air purge	p3	mm	M4	M4
Vice Closed	p4	mm	M4	M4
Vice Open	p5	mm	M4	M4
	p8	mm	M8x16	M10x18
	q	mm	36	45
	r	mm	M8x10	M8x10
min/max	t	mm	9/15.6	13.5/20.9

■ Mounting instruction

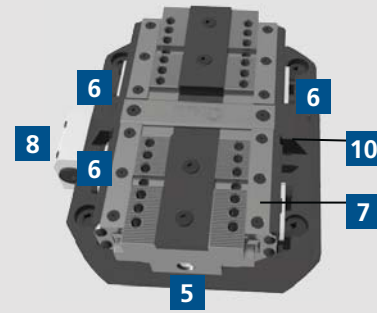
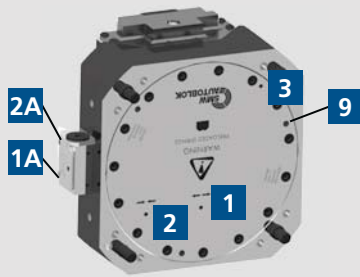

Solution 1 Standard

± 0,03 mm to clamping center

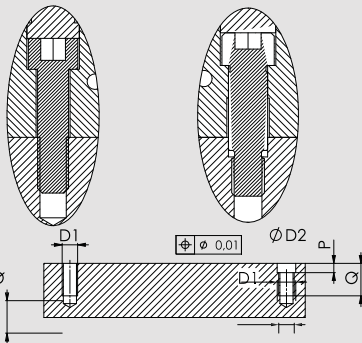
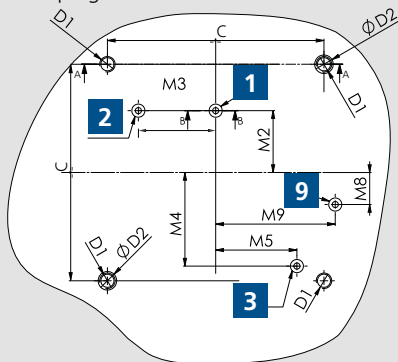

All bolts and centering bushings included

Solution 2 Standard

± 0,025 mm to clamping center

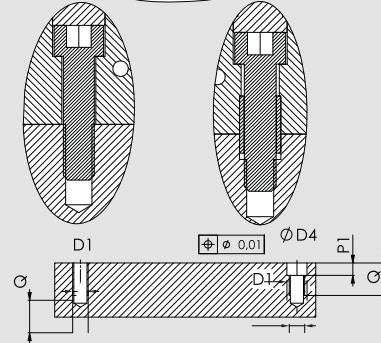
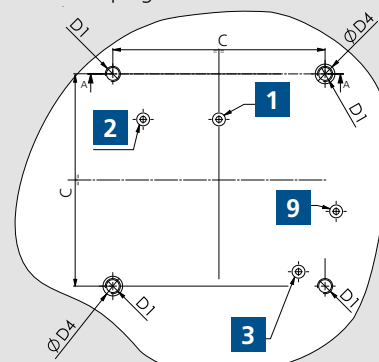

All bolts and centering bushings included

Feeding seats

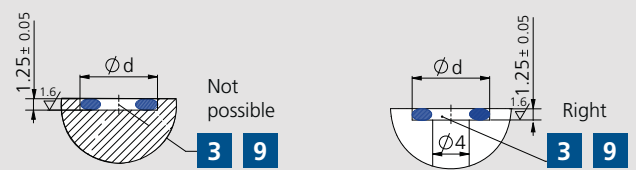
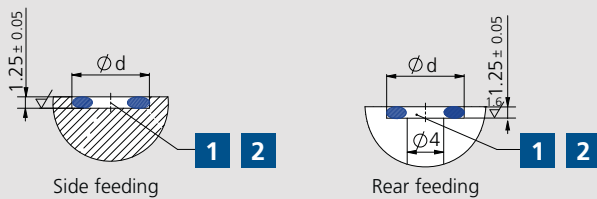

Functional Overview

1	Open-Rear feeding	1A	Open-Side feeding	6	Proximity switches seats	9	Air sensing connection**
2	Closed-Rear feeding	2A	Closed-Side Feeding	7	Pneumatic stroke control valve	10	Air sensing outlet** (under front plate)
3	Pneumatic stroke control or air purge*	5	Lubrication fitting	8	Safety valve		

* The air purge can be used only without the valve.

**9 and 10 Points available only on 2 jaws version.

Type	C	D1	D2 H7	D4 H7	M2	M3	M4	M5	M8	M9	P	P1	Q	Ød	OR
STV 125	100	M8	10	11	32	29.5	40.5	38.5	10.6	54.5	6	6	18	8	OR2018
STV 180	140	M10	12	13	40	50	60.5	52.5	20.7	77.3	6	7	21	8.8	OR2021
STV 225	180	M12	14	16	50	65	79	63	15	99.9	7	7	24	8.8	OR2021

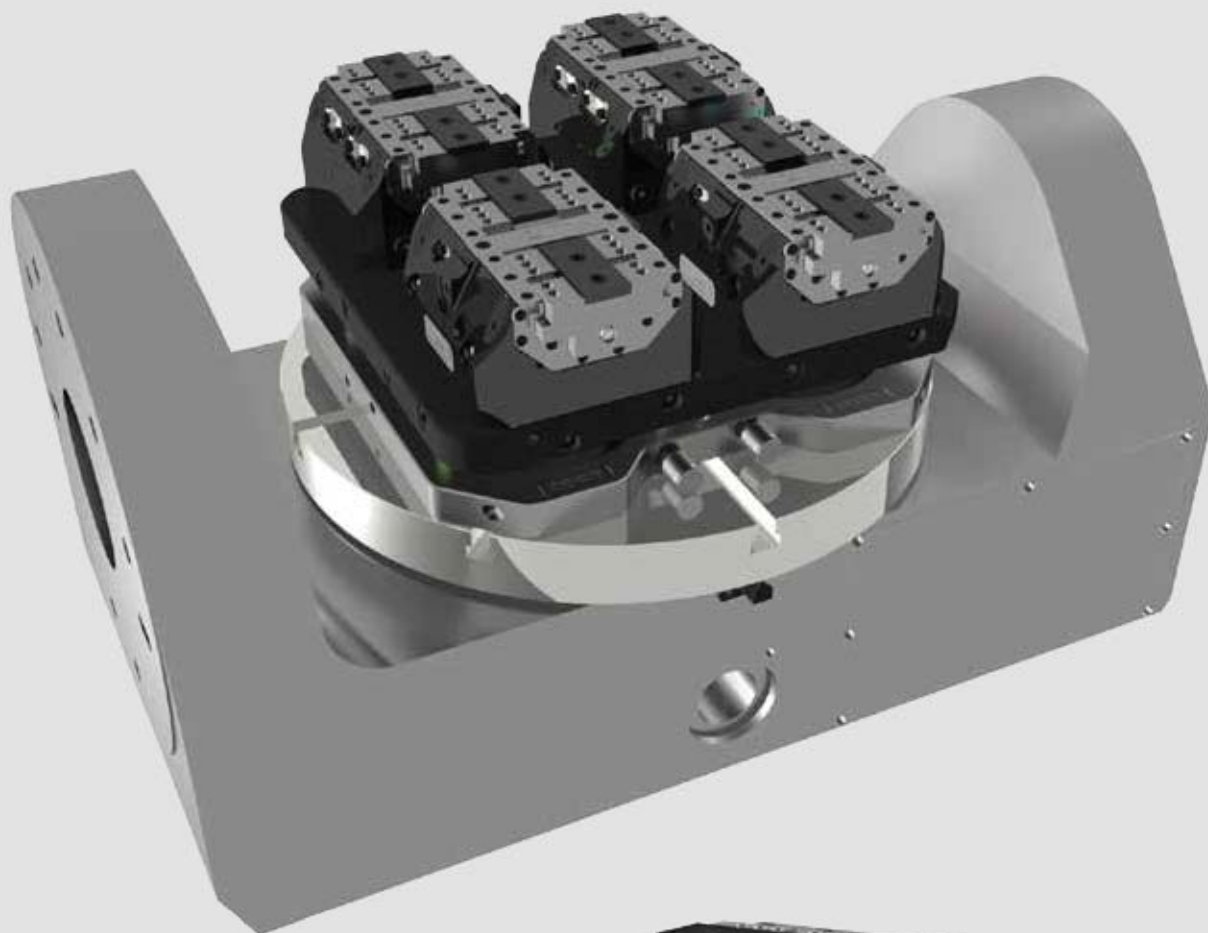

Soft blank top jaws, tongue & groove

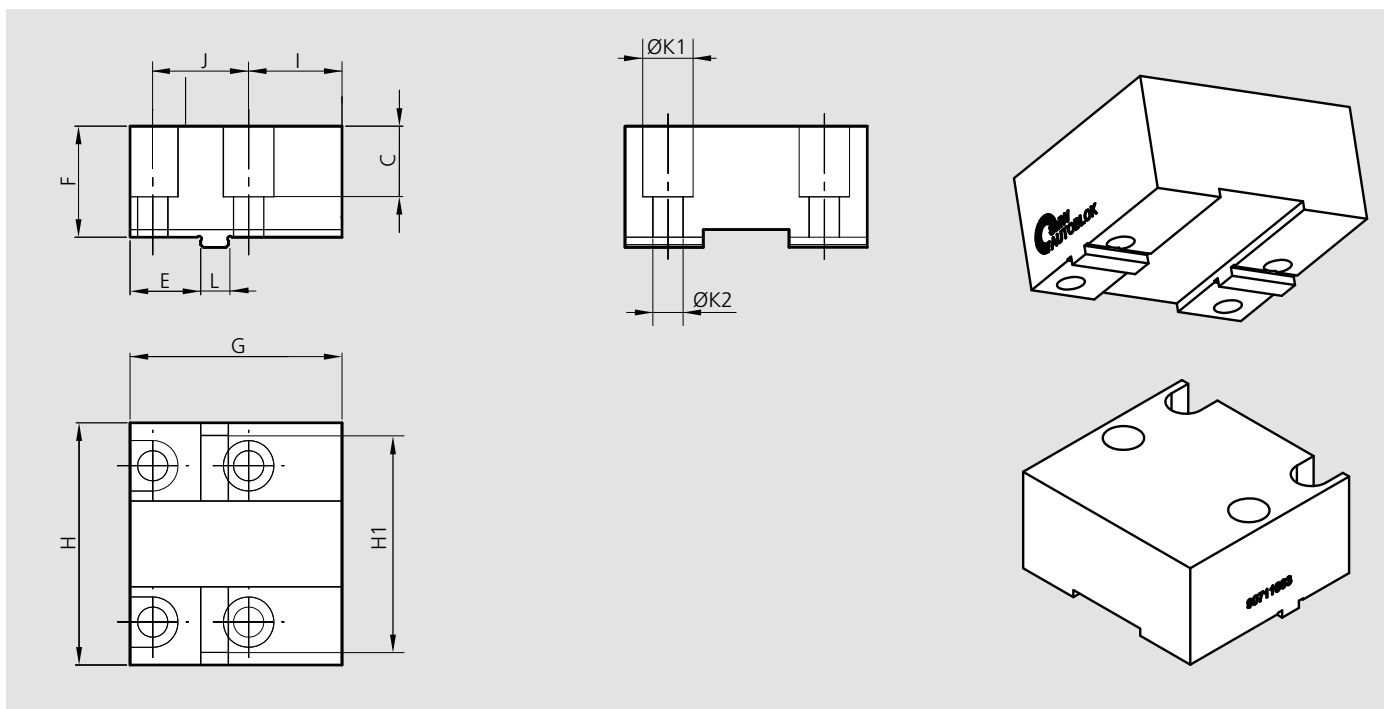

Type	Id. No.	C mm	E mm	F mm	G mm	H mm	H1 mm	I mm	J mm	K1 mm	K2 mm	L mm	Clamping range
125 STV-2 / PT	90711283	20	33	27.5	64	54.5	45	21	35	11	7	6h7	0-100
125 STV-2 / PT	90721283	40	33	47.5	64	54.5	45	21	35	11	7	6h7	0-100
180 STV-2 / PT	90711883	27	41	37	93	79	74	38	40	14	9	8h7	0-140
180 STV-2 / PT	90721883	66.5	41	76.5	93	79	74	38	40	14	9	8h7	0-140
225 STV-2	90712283	37	52	47	113.5	109	92	47.5	50	14	9	8h7	0-180
225 STV-2	90722283	76.5	52	86.5	113.5	109	92	47.5	50	14	9	8h7	0-180

Consisting of 1 piece of jaw

Soft blank top jaws, tongue & groove, for STV-3

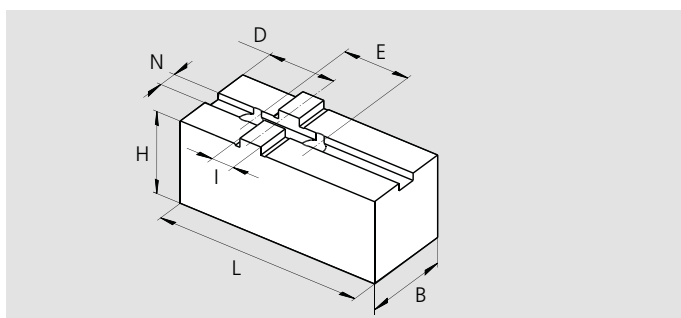

Type	Id. No.	B mm	H mm	L mm	N mm	D mm	E mm	I mm
180 STV-3	12041660	30	32	80	7.94	30	38.1	12.68
225 STV-3	12042060	35	37	100	7.94	35	44.4	12.68

Consisting of 1 piece of jaw

■ Fine serration 1.5 mm x 60°

Soft blank top jaws, fine serration 1.5 mm x 60°

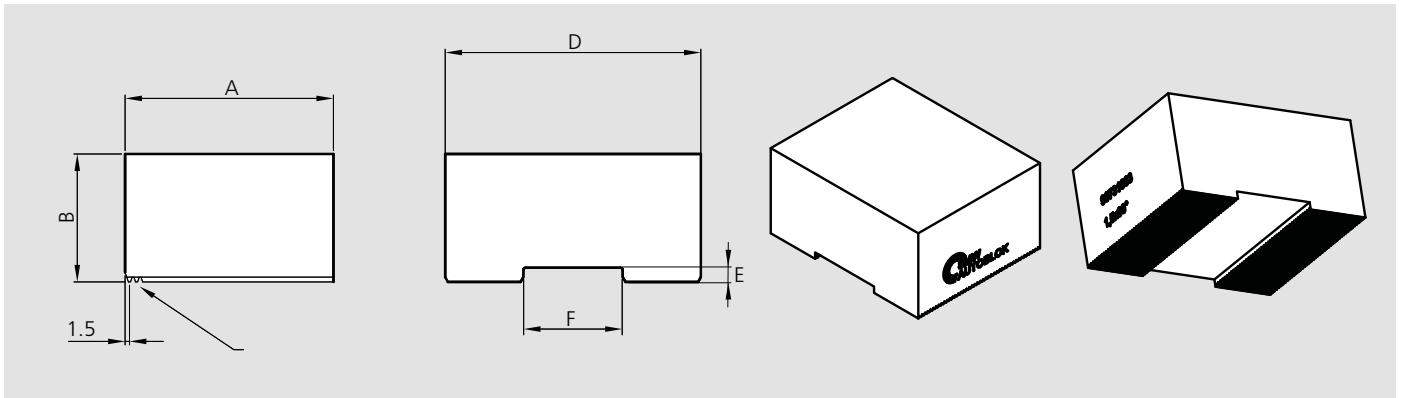

Type	Id. No.	A mm	B mm	D mm	E mm	F mm
100-125 STV / TV / PT / SL	90731063	42	29.5	54.5	2.5	20H8
100-125 STV / TV / PT / SL	90741063	47	49.5	54.5	2.5	20H8
160-180 STV / TV / PT / SL	90731663	66	39.5	79	3	32H8
160-180 STV / TV / PT / SL	90741663	76	79	79	3	32H8
200-225 STV / TV / PT / SL	90732063	87	49.5	109	4	40H8
200-225 STV / TV / PT / SL	90742063	87	89	109	4	40H8

Consisting of 1 piece of jaw

Soft blank top jaws, narrow, fine serration 1.5 mm x 60°

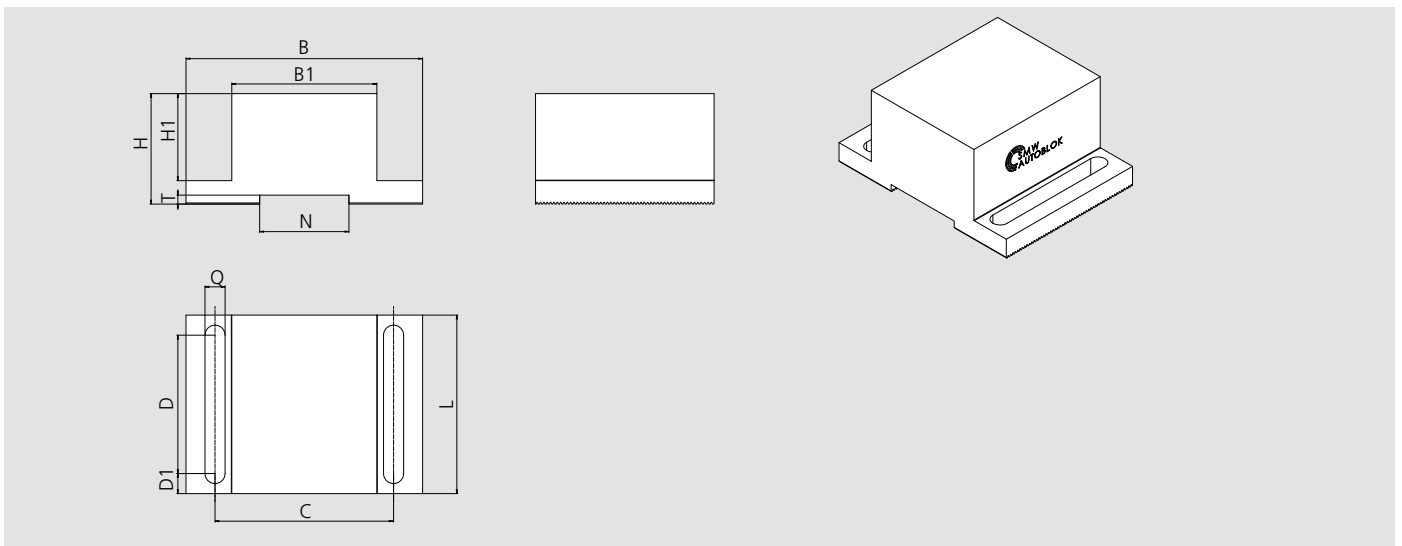

Type	Id. No.	B mm	B1 mm	C mm	D mm	D1 mm	H mm	H1 mm	L mm	N mm	Q mm	T mm
100-125 STV / TV / PT / SL	90751063	54.5	24	35	30	6	29.5	21.5	42	20H8	6.6	2.5
160-180 STV / TV / PT / SL	90751663	79	45	60	42	9	39.5	29	60	32H8	9	3
200-225 STV / TV / PT / SL	90752063	109	65	80	62	9	49.5	39	80	40H8	9	4

Consisting of 1 piece of jaw

SinterGrip jaws

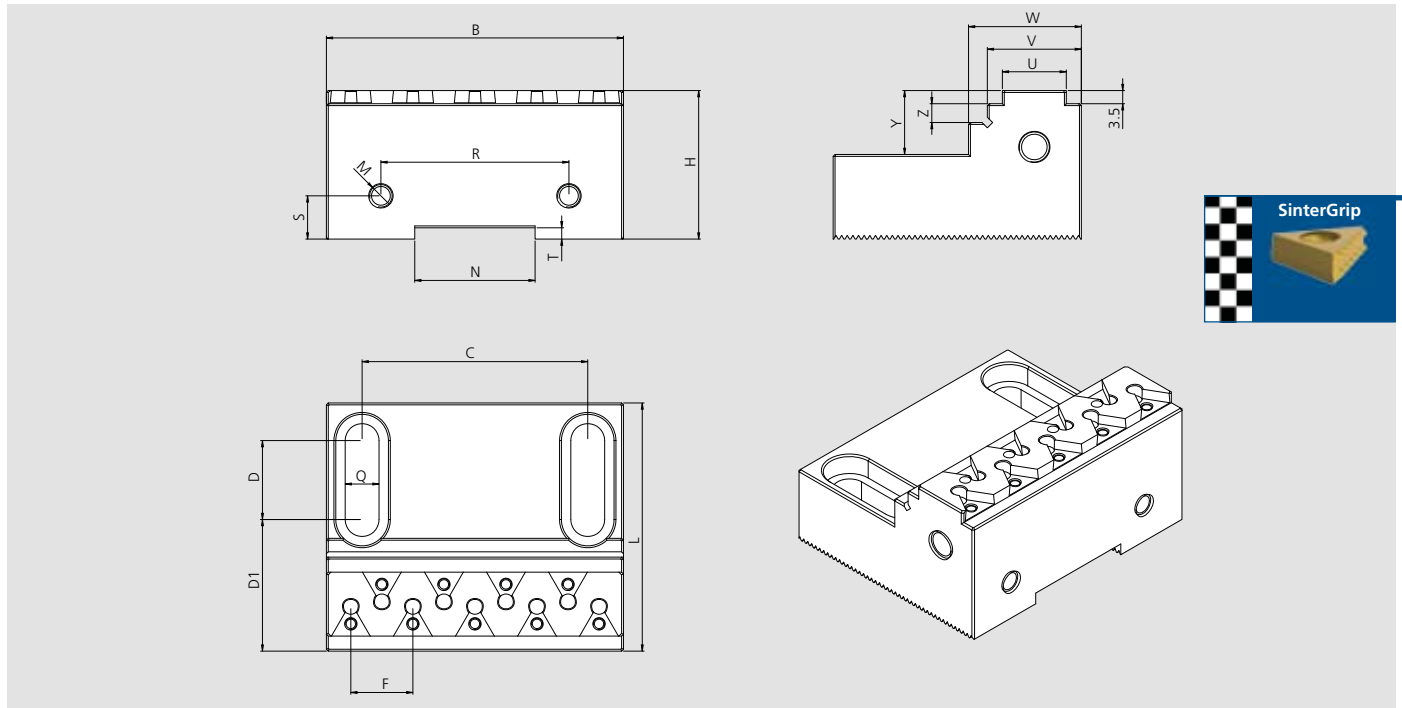

Type	Id. No.	B mm	C mm	D mm	D1 mm	F mm	H mm	L mm	M mm	N mm	Q mm	R mm	S mm	T mm	U mm	V mm	W mm	Y mm	Z mm	Inserts mm
100-125 (S)TV / PT / SL	58454119	54.5	35	7.4	28.3	16.5	29.5	42	M6	20 H8	6.6	35	11.5	2.5	14	22	27	17	5	5
160-180 (S)TV / PT / SL	58454129	79	60	21	35	16.5	39.5	66	M6	32 H8	9	50	11.5	3	17	25	30	17	5	9
200-225 (S)TV / PT / SL	58454139	109	80	21	39.5	18	49.5	87	M6	40 H8	9	70	11.5	4	17	25	30	27.5	7	11

SinterGrip jaws narrow

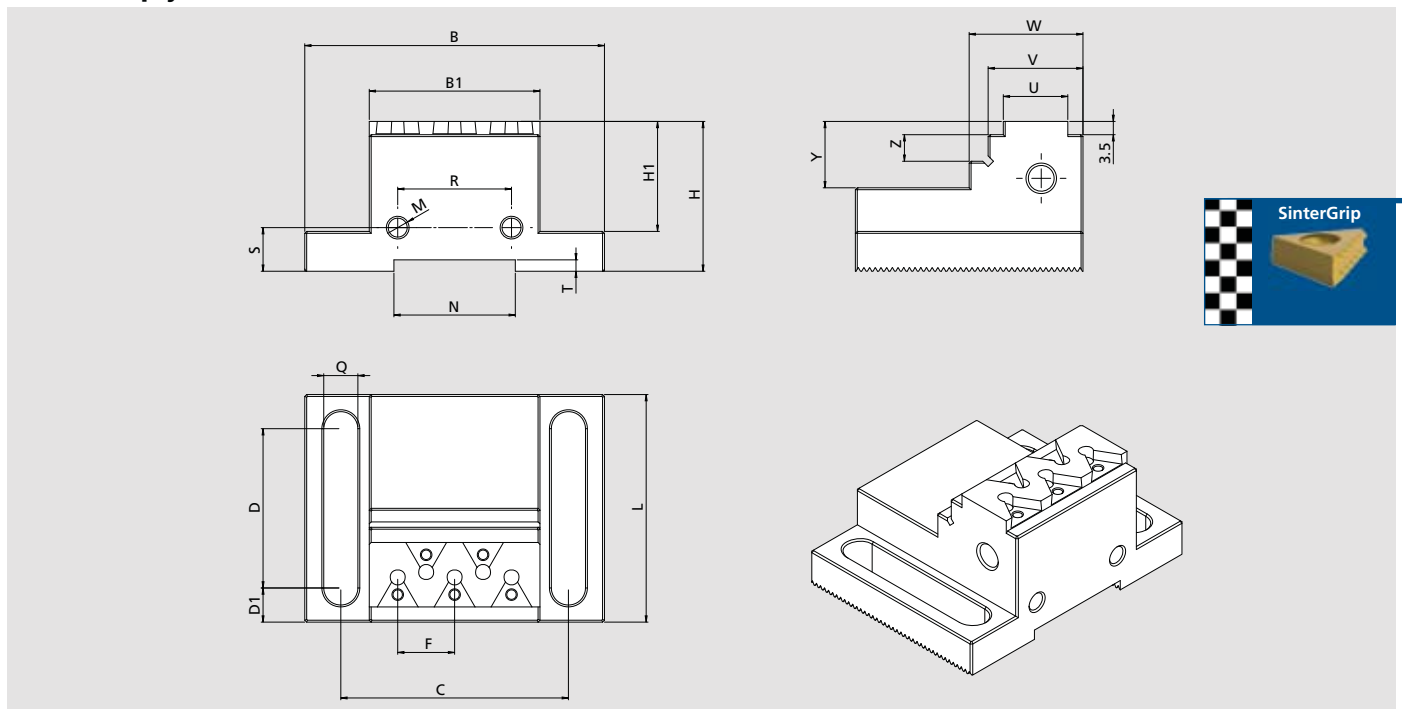

Type	Id. No.	B mm	B1 mm	C mm	D mm	D1 mm	F mm	H mm	H1 mm	L mm	M mm	N mm	Q mm	R mm	S mm	T mm	U mm	V mm	W mm	Y mm	Z mm	Inserts mm
160-180 (S)TV / PT / SL	58454229	79	45	60	42	9	15	39.5	29	60	M6	32 H8	9	30	11.5	3	17	25	30	17.5	7	5
200-225 (S)TV / PT / SL	58454239	109	65	80	62	9	16.5	49.5	39	80	M6	40 H8	9	40	11.5	4	17	25	30	17.5	7	7

Precision vise for 5 axis machine tools



Genius Vise

Page 45



Spare parts

Page 50



Accessories

Page 46

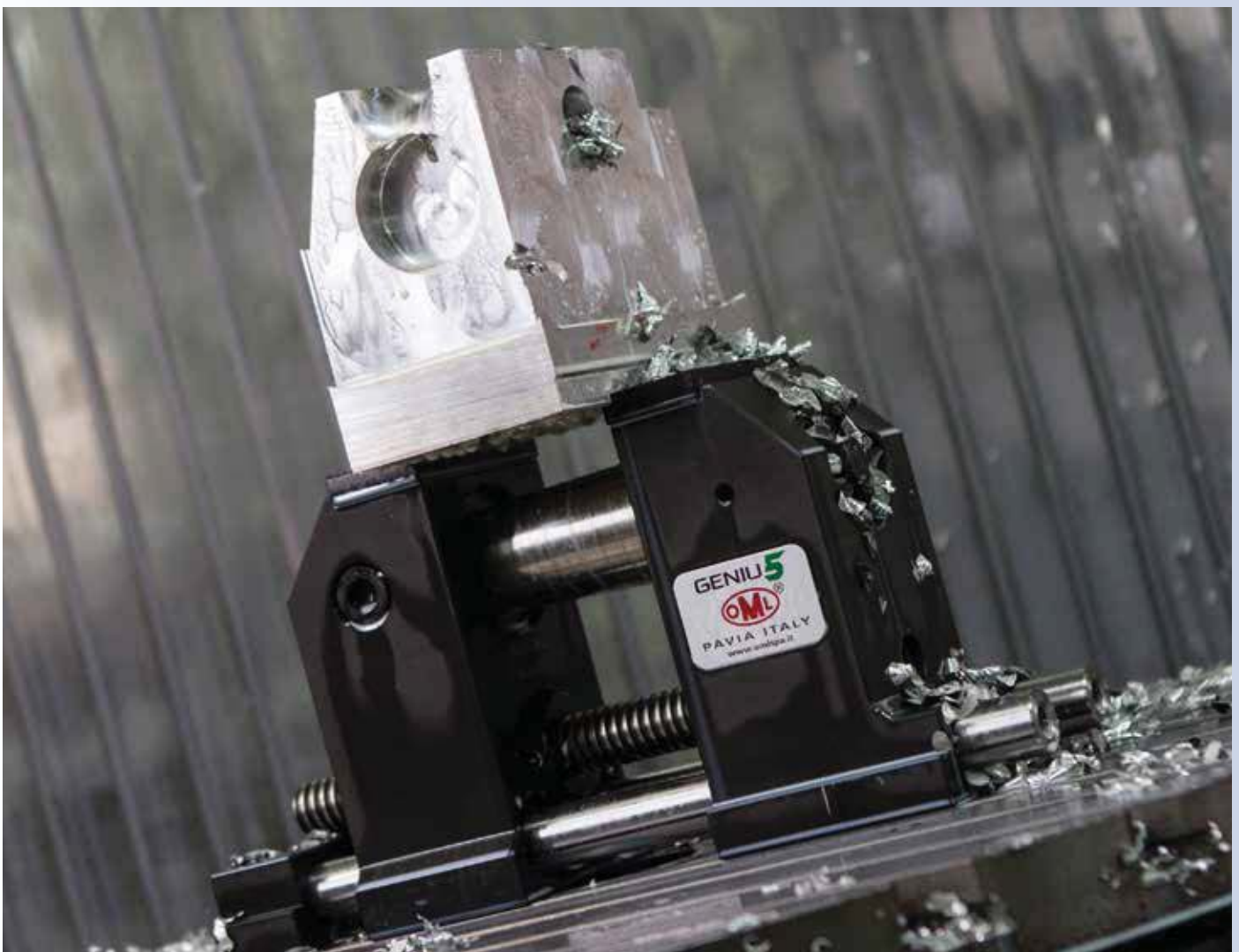

GENIUS

5 are its main features

1

The clamping force (up to 40 kN) is generated right where it is needed: at the part.

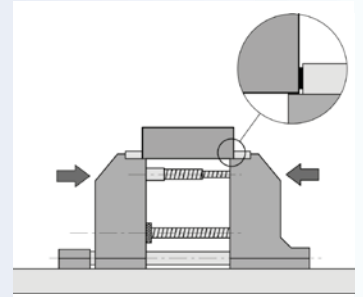
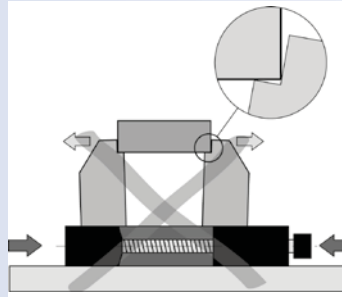

2

Thanks to its own expanding screw, GENIUS can clamp workpieces up to 200 mm with just one set-up.

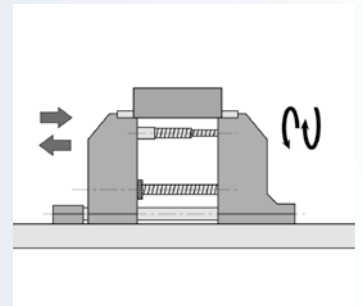

3

Unlike traditional vises, GENIUS clamps the workpieces by means of traction clamping.

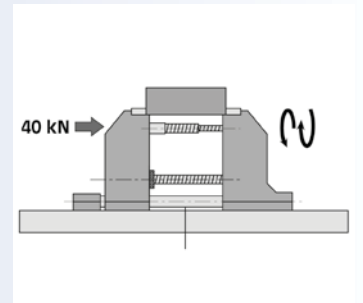
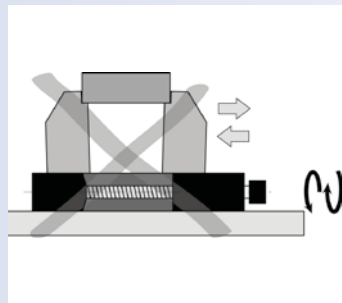

4

GENIUS is the first vise designed for 5 axis-machine tools that can be used for high precision milling operations.

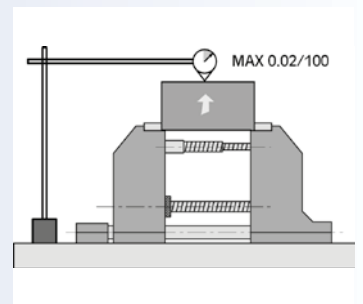
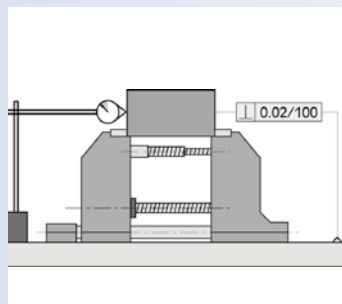

5

The movement of the jaws is not on a base, but on hardened and ground shafts. This allows for quicker and more accurate positioning of both the same axis with the centre of the machine tool pallet.

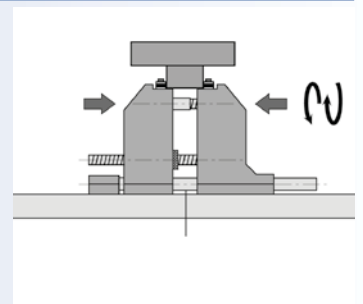

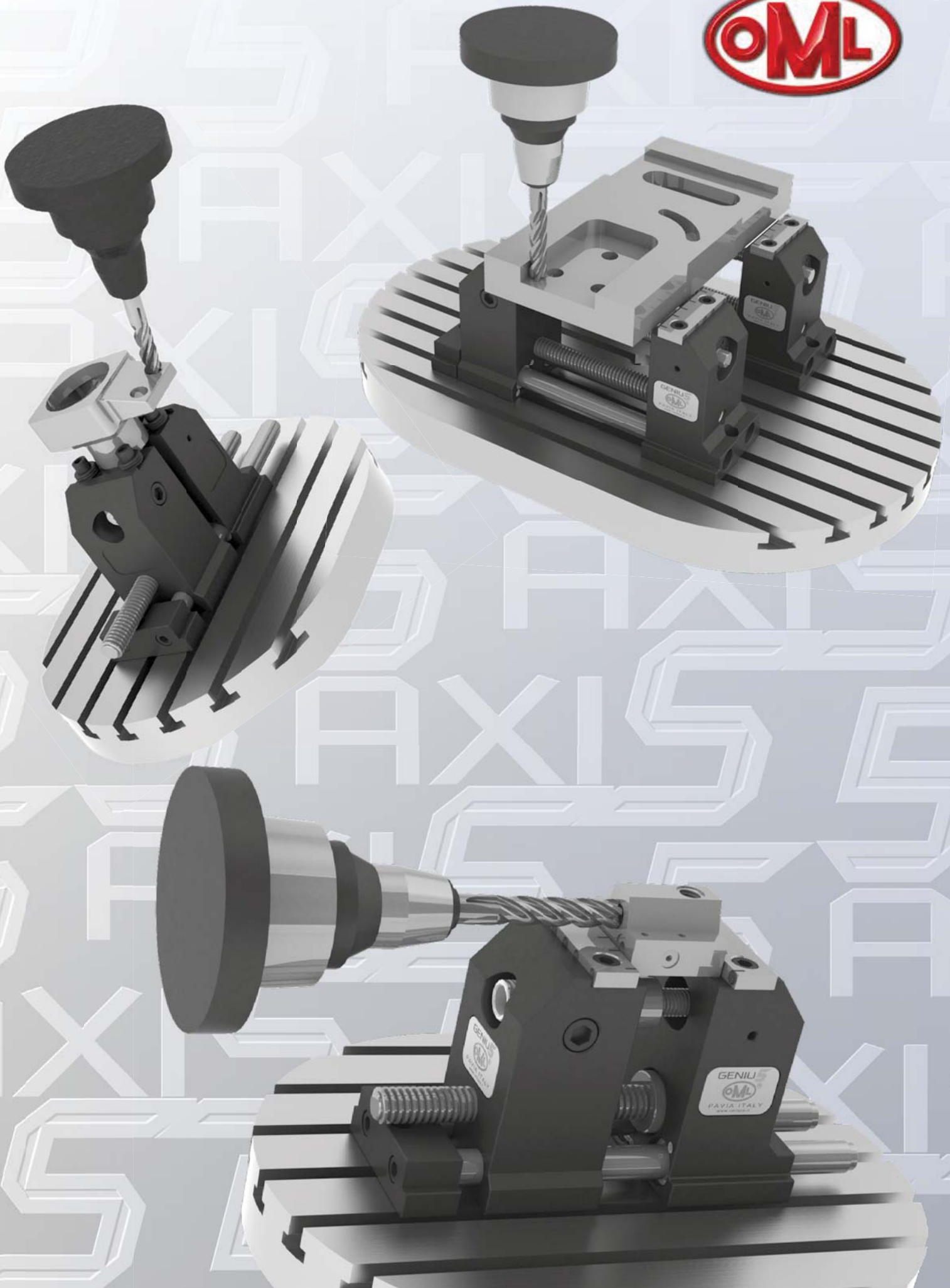

SinterGrip: the New Choice

Our new patented product **SinterGrip** is born to satisfy the current need to clamp a workpiece for very few millimeters (with SinterGrip 3,5 mm clamping surface), and this for the following reasons:

- 1) In order to machine the workpiece completely in a single operation (especially for 5 axis machines);
- 2) In order to save money for the raw materials, especially when they have a big impact on the price (aluminum, titanium, etc.)

Indirectly to these reasons, and in order to improve the performance of the machine tool and the tools

**higher cutting speed +
higher feed rate =
bigger volume of metal removed =
less time to machine the workpiece**

the market requires safe clamping, which could at the same time possibly avoid the deformations of the piece itself.

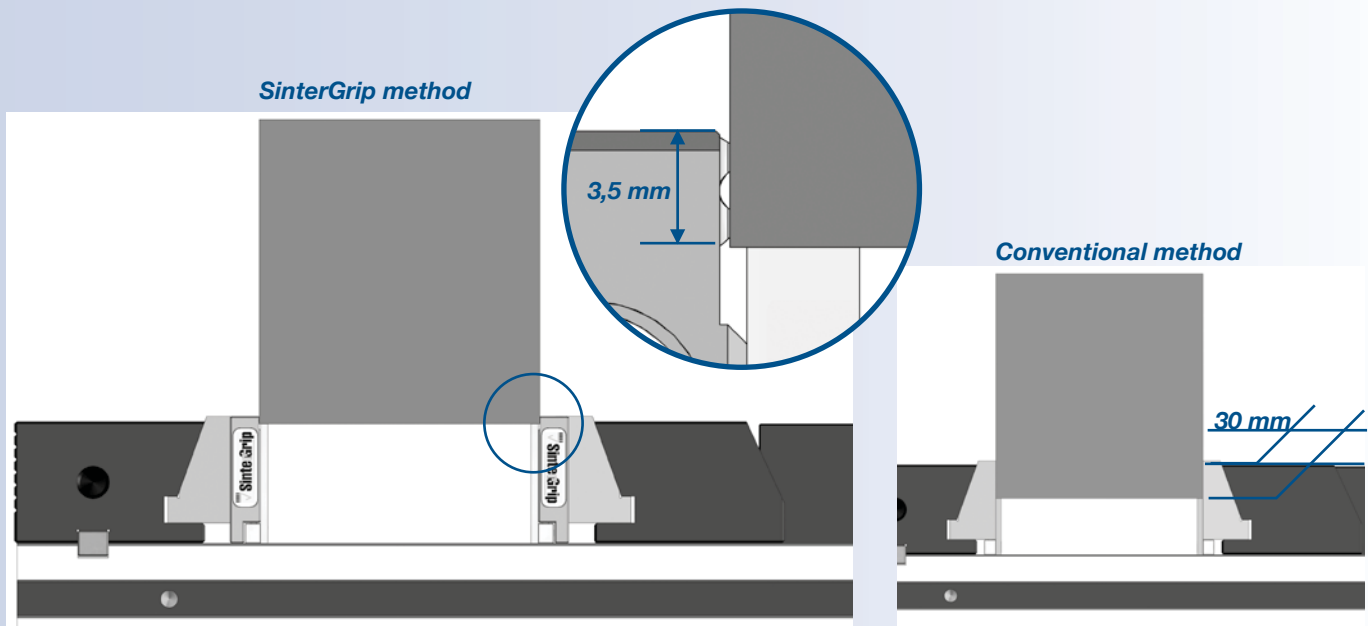

Only 3,5 mm clamping surface, no need of pre-machining the workpiece, clamping stability, higher cutting rate: SinterGrip brings only advantages compared to the traditional systems.

On the contrary, traditional systems need, for the clamping of the workpiece, a bigger clamping surface, with the result of waste of raw materials and greater possibility of deformation of the workpiece.



GENIUS vise with wrench, pair of positioning keys and Sintergrip inserts STD for steel

(On request SinterGrip inserts HRC or inserts for ALU)

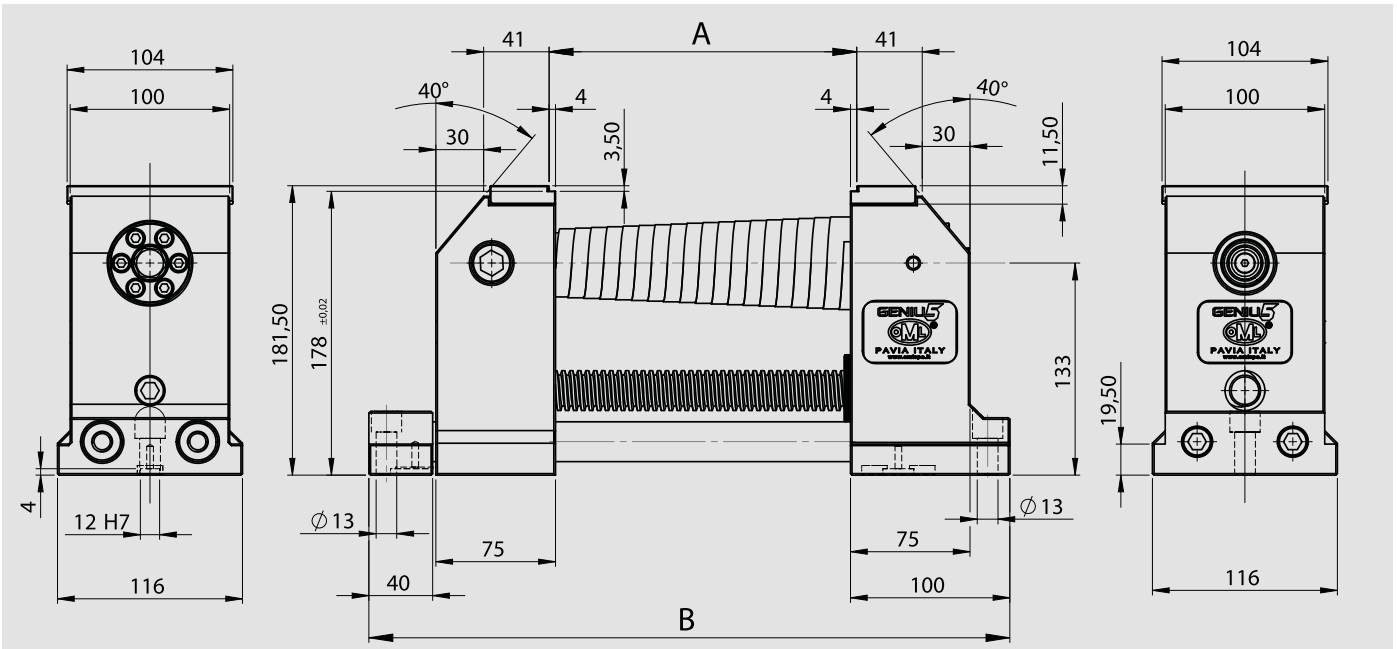

Type	Id. No.	A*	B	Weight Kg
GENIUS 100	77 58 50 11	100	312	23
GENIUS 200	77 58 50 12	200	412	25

Special opening "A" upon request

Special applications upon request



Work stop

Id. No. 58 50 50 00

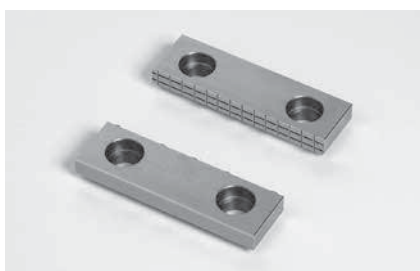

Pair of smooth/grooved jaws

Id. No. 58 50 41 19

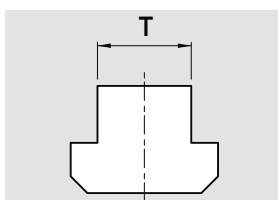
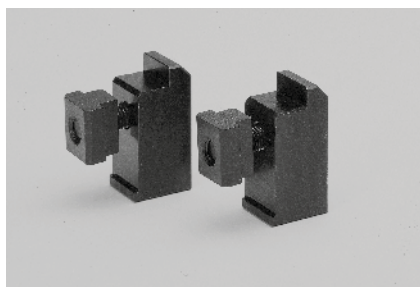

Pair of clamps, complete with screw and T-nuts

	mm 12	mm 14	mm 16	mm 18	mm 20	mm 22
Id. No.	58 02 27 92	58 02 27 93	58 02 27 94	58 02 27 95	58 02 27 96	58 02 27 97

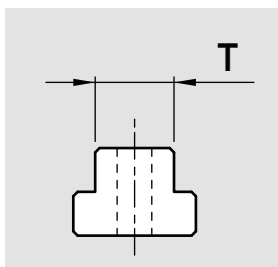

Pair of nuts complete with screws M12

Id. No.	T mm
58 50 25 93	14
58 50 25 94	16
58 50 25 95	18
58 50 25 96	20
58 50 25 97	22

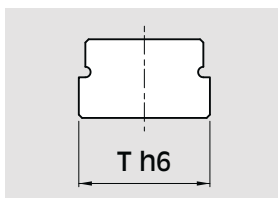
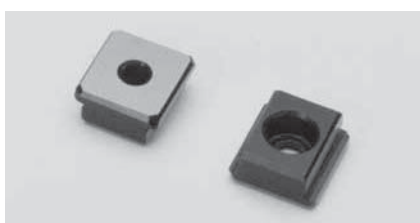

Pair of positioning key

	mm 12 h6	mm 14 h6	mm 16 h6	mm 18 h6	mm 20 h6	mm 22 h6
Id. No.	58 01 15 92	58 01 15 93	58 01 15 94	58 01 15 95	58 01 15 96	58 01 15 97



Torque wrench

Id. No. 51 50 10 06

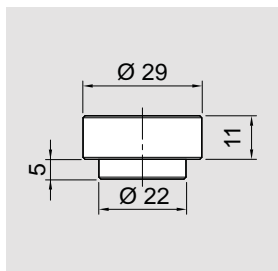

set of 4 "grippers" h11 smooth

Id. No. 58 90 61 14

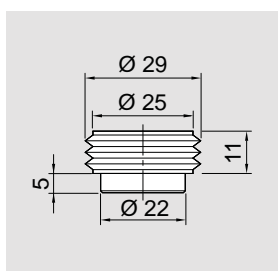

set of 4 "grippers" h11 serrated

Id. No. 58 90 61 24

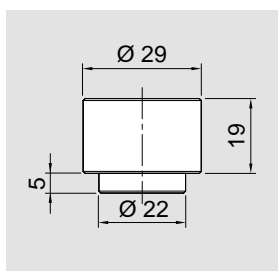

set of 4 "grippers" h19 smooth

Id. No. 58 90 62 14

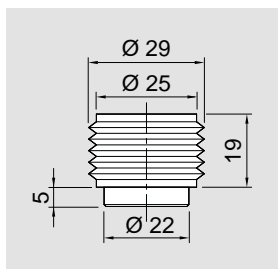

set of 4 "grippers" h19 serrated

Id. No. 58 90 62 24

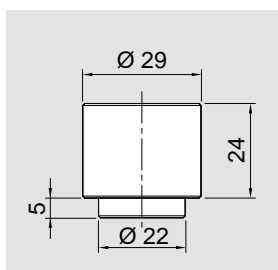

set of 4 "grippers" h24 smooth

Id. No. 58 90 63 14

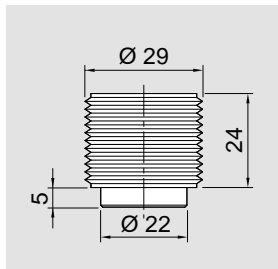

set of 4 "grippers" h24 serrated

Id. No. 58 90 63 24

Working example with "grippers"

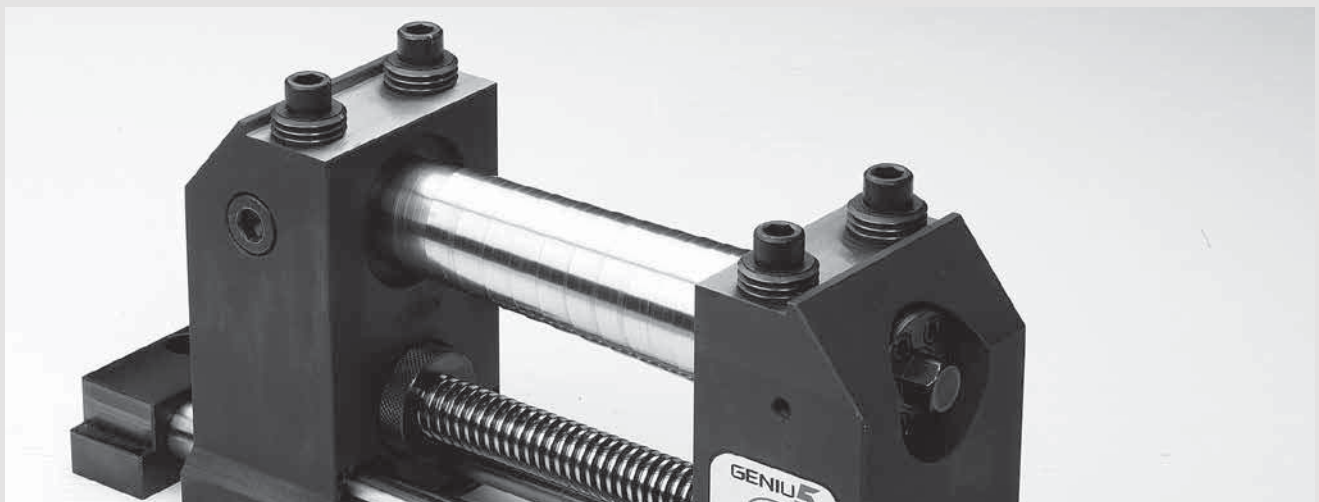

Working example with SinterGrip

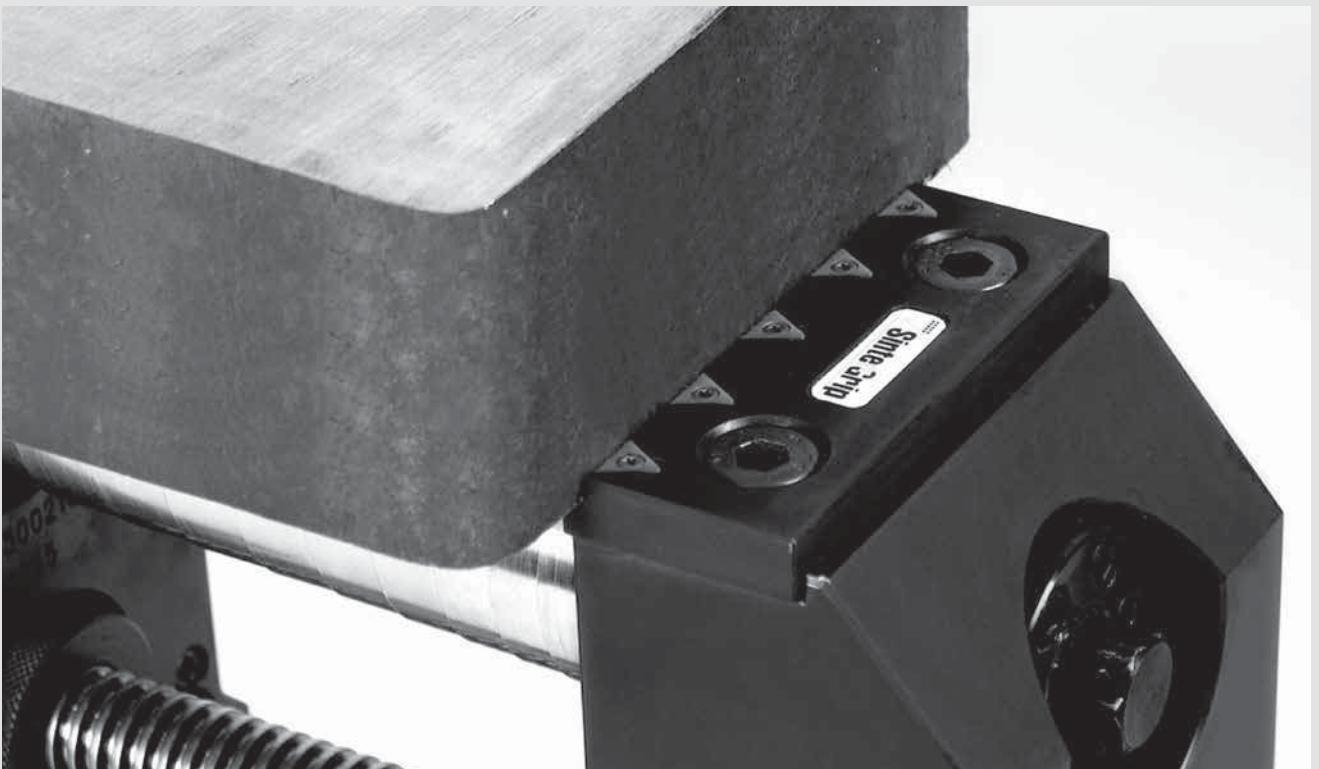

GENIUS 5

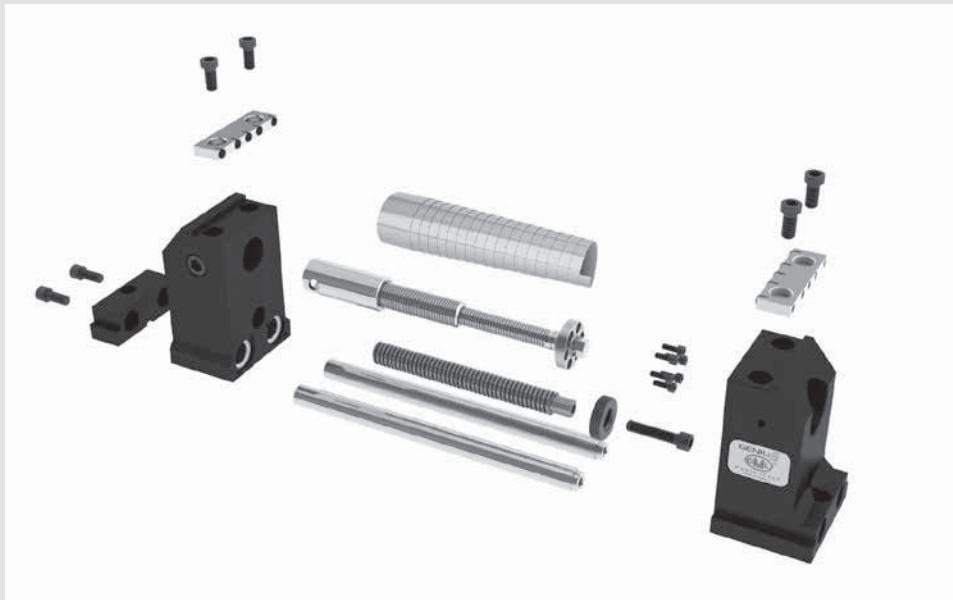

**Pair of jaws for Sintergrip**

Id. No. 58 45 15 19

**Pair of jaws with grippers**

Id. No. 58 50 42 19 (old)

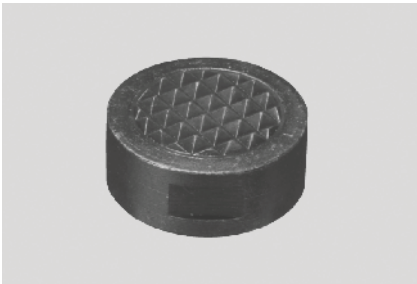
**Round gripper**

Id. No. 51 99 20 08 (old)

**Clamping key**

Id. No. 51 50 29 10

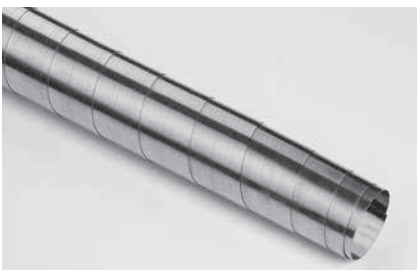
**Telescopic stainless steel carter**

Id. No. 71 29 02 18

**Spindle group**

Id. No. 77 58 50 10

Plate for vise Genius

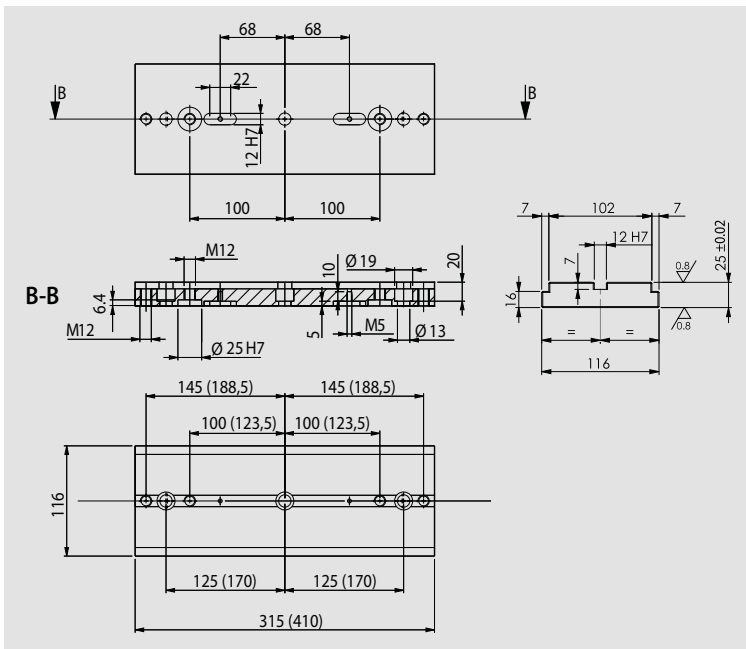
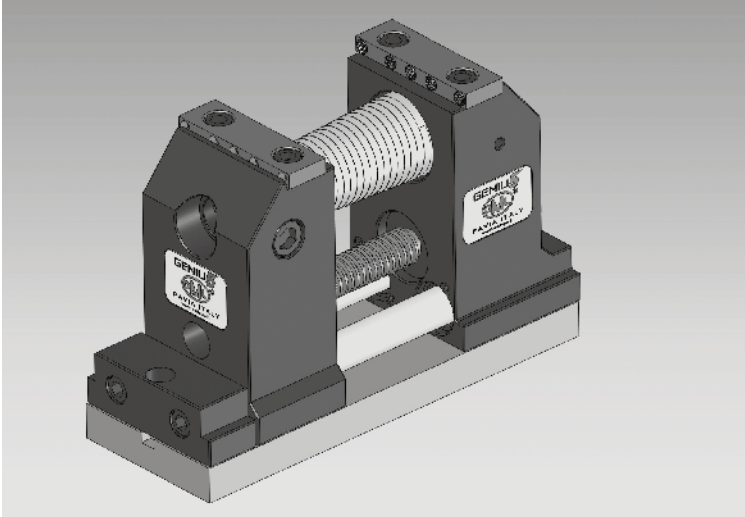

Type	Id. No.	Weight Kg
GENIUS 100	58 50 20 10	7
GENIUS 200	(58 50 20 20)	9

Notes

A large rectangular area filled with horizontal stripes in alternating shades of light blue and medium blue. This area is intended for taking notes.

Vari CLAMP

Page



Self-centering set base VCA

Set base Vise Power complete with:
wrench
cover for the protection of the screw
2 positioning keys with screw
4 clamps



Cod.	for type
77 58 90 70	VCA 100
77 58 91 70	VCA 130
77 58 92 70	VCA 160

"L" jaw kit

Cod.	for type
58 90 71 20	VCA 100
58 91 71 20	VCA 130
58 92 71 20	VCA 160



Square block jaw kit

Cod.	for type
58 90 72 20	VCA 100
58 91 72 20	VCA 130
58 92 72 20	VCA 160

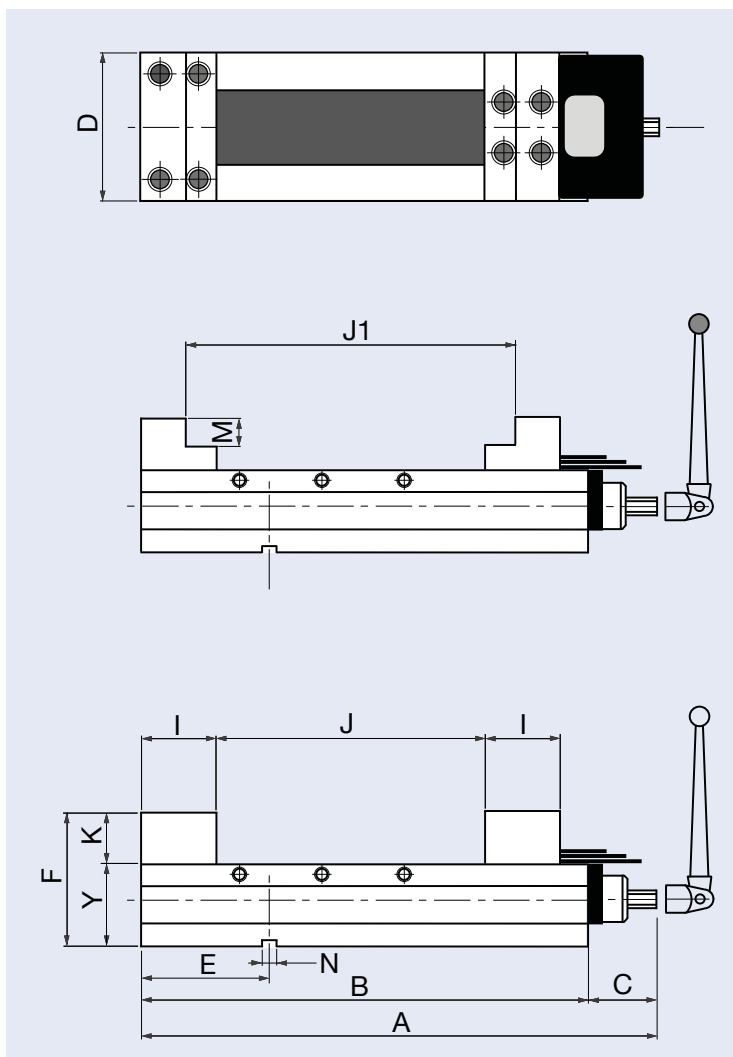
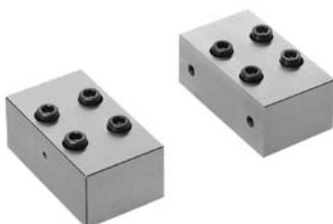

type	A		B		C		D		E		F		J		J1		I		K		M		N		X		Y		max clamping force KN (kgf)	weight kg
	mm	mm	mm	mm	mm	mm	mm	mm	mm	mm	mm	mm	mm	mm	mm	mm	mm	mm	mm	mm	mm	mm	mm	mm	mm	mm	mm			
VCA 100	378	300		101	150	130	40	165	40	220	64	45	25		45	85	20 (2.000)	22												
VCA 130	488	410	78	131	205	147	40	250	40	320	74	52	30	18	65	95	23 (2.300)	40												
VCA 160	553	475		161	237,5	160	40	290	40	370	86	55	30		65	105	24 (2.400)	60												

Self-centering set base VCA

Set base Vise Power complete with:
wrench
cover for the protection of the screw
2 positioning keys with screw
4 clamps



Cod.	for type
77 58 90 70	VCA 100
77 58 91 70	VCA 130
77 58 92 70	VCA 160

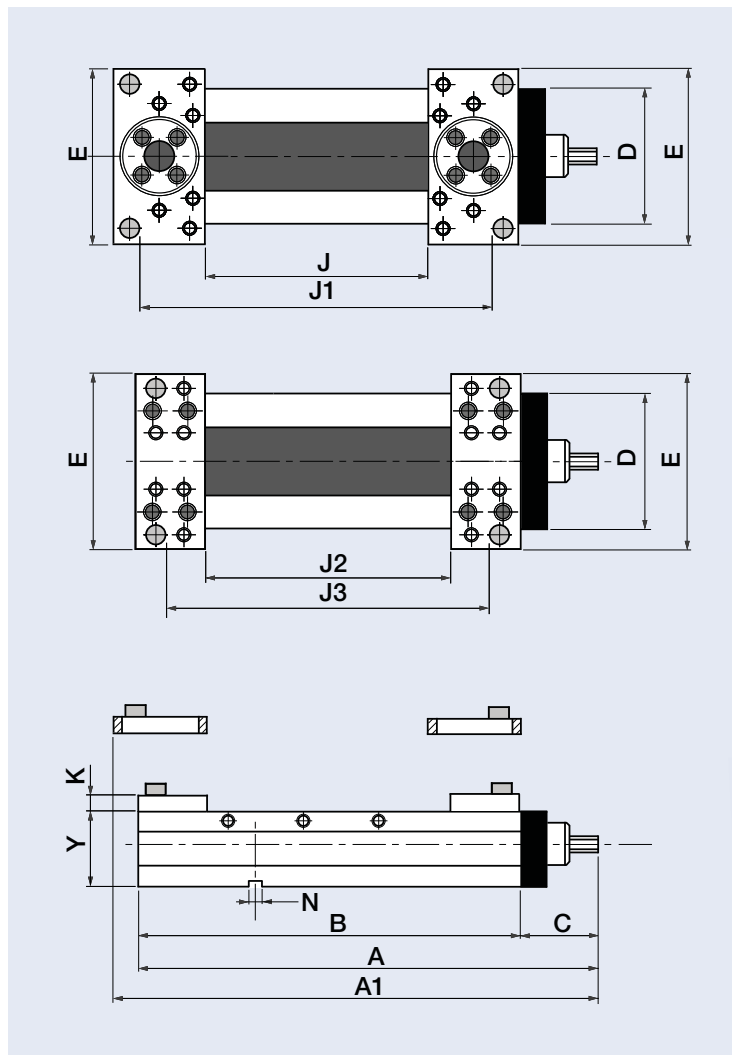

Gripper jaw kit

Cod.	for type
58 90 73 30	VCA 100
58 91 73 30	VCA 130
58 92 73 30	VCA 160



Floating gripper jaw kit

Cod.	for type
58 90 73 40	VCA 100
58 91 73 40	VCA 130
58 92 73 40	VCA 160



type	A	A1	B	C	D	E	J		J1	J2		J3	K	N	Y	max clamping force KN (kgf)	weight kg
	mm	mm	mm	mm	mm	mm	min	max	mm	min	max	mm	mm	mm			
VCA 100	378	397	300		101	160	5	122	270	40	170	230			85	20 (2.000)	19
VCA 130	488	513	410	78	131	190	5	205	377	30	255	340	22	18	95	23 (2.300)	34
VCA 160	553	584	475		161	220	11	230	450	40	295	390			105	24 (2.400)	53

Set of 4 grippers h11 smooth



Cod. 58 90 61 14



Set of 4 grippers h11 serrated



Cod. 58 90 61 24



Set of 4 grippers h19 smooth



Cod. 58 90 62 14

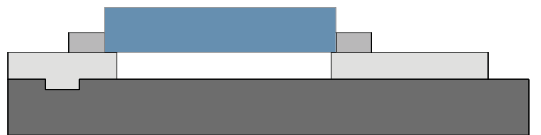

Set of 4 grippers h19 serrated



Cod. 58 90 62 24

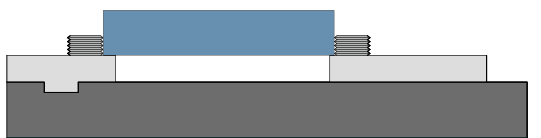

Set of 4 grippers h24 smooth



Cod. 58 90 63 14

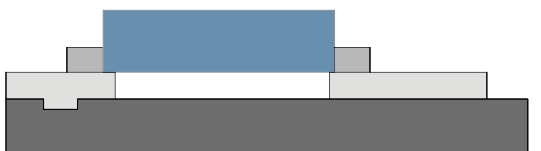

Set of 4 grippers h24 serrated



Cod. 58 90 63 24



Set of 4 grippers h11 smooth-serrated



Cod. 58 90 64 14



Set of 4 soft grippers h25 smooth



Cod. 58 90 65 14



Set of 4 grippers h50 serrated with adjustable screw



Cod. 58 90 67 24

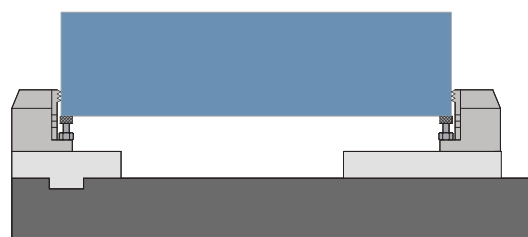

Set of 4 grippers h50 smooth with step



Cod. 58 90 68 14

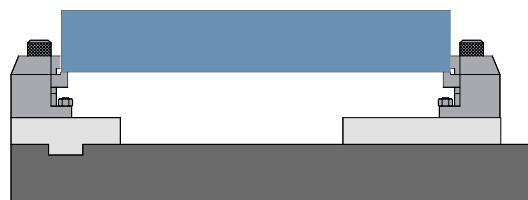

Set of 4 grippers h50 serrated with step



Cod. 58 90 68 24

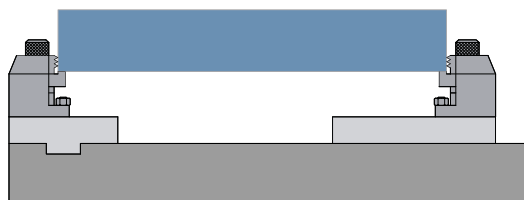

Set of 4 grippers h25 smooth with adjustable screw



Cod. 58 90 66 14



Set of 4 grippers h25 serrated with adjustable screw



Cod. 58 90 66 24



Set of 4 grippers h50 smooth with adjustable screw



Cod. 58 90 67 14

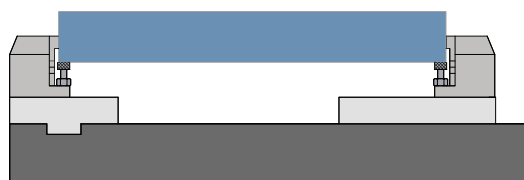

Moveable square block jaw (with expanding chip cover)

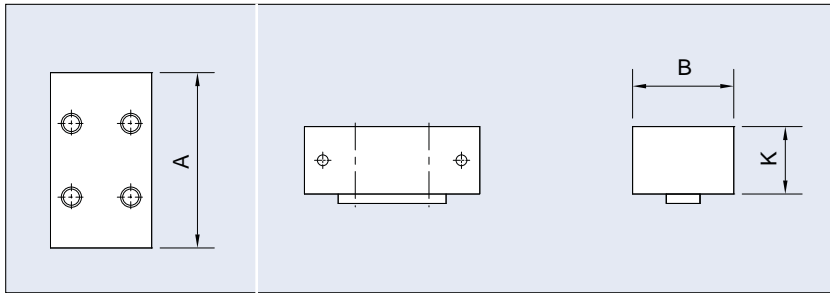

Cod.	type	A mm	B mm	K mm	weight kg
58 90 03 20	100	100	64	45	2,5
58 91 03 20	130	130	74	52	4,5
58 92 03 20	160	160	86	55	6

Moveable jaw "L" type (with expanding chip cover)

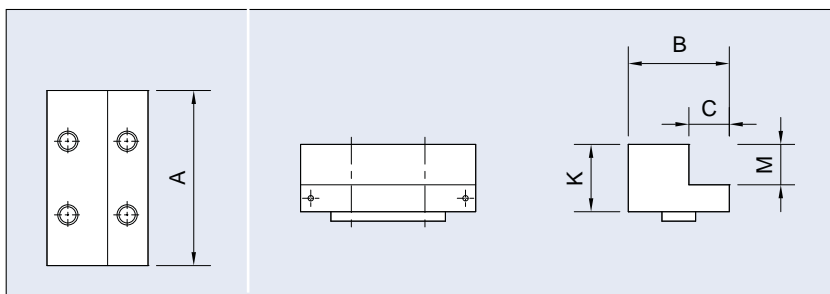

Cod.	type	A mm	B mm	C mm	K mm	M mm	weight kg
58 90 03 10	100	100	64	26	45	25	1,5
58 91 03 10	130	130	74	30	52	30	2,8
58 92 03 10	160	160	86	35	55	30	4,2

Moveable jaw gripper

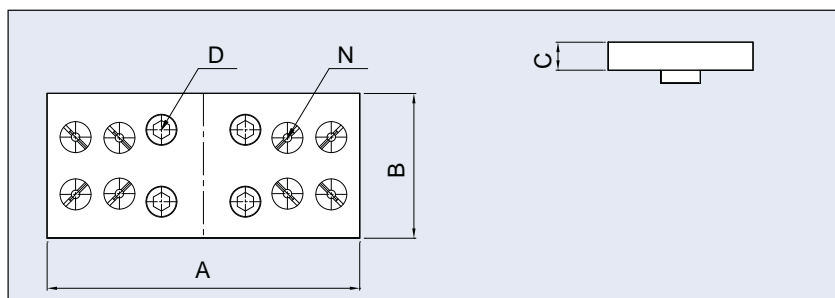

Cod.	type	A mm	B mm	C mm	D mm	N	weight kg
58 90 03 30	100	160	64	22	M10x25L	6	1,4
58 91 03 30	130	190	88	22	M12x30L	8	2,2
58 92 03 30	160	220	88	22	M14x30L	8	3,3

Floating jaw gripper

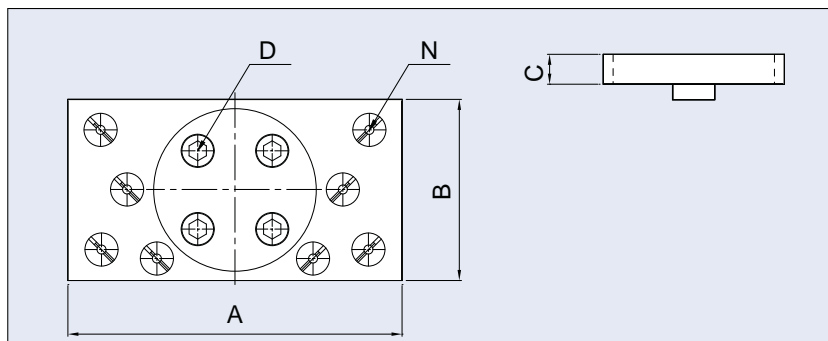

Code	type	A mm	B mm	C mm	D mm	N	weight kg
58 90 03 40	VCP 100	160	88	22	M10x25L	6	2,2
58 91 03 40	VCP 130	190	103	22	M12x30 L	8	3,2
58 92 03 40	VCP 160	220	128	22	M14x30L	8	5,7

Gripper h11 smooth

Code

58 90 61 10

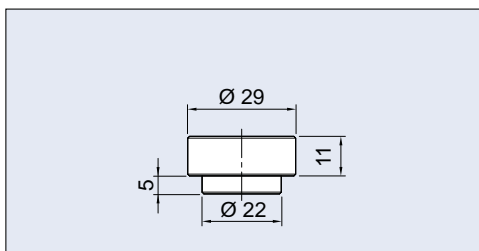

Gripper h11 serrated

Code

58 90 61 20

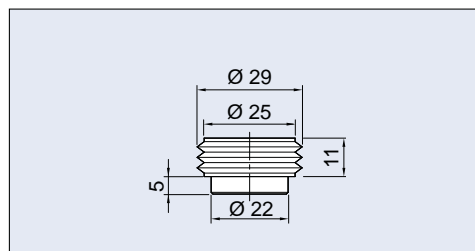

Gripper h19 smooth

Code

58 90 62 10

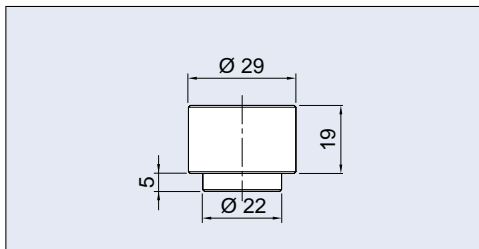

Gripper h19 serrated

Code

58 90 62 20

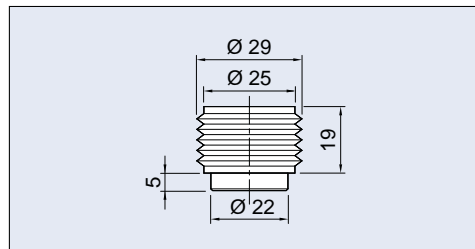

Gripper h24 smooth

Code

58 90 63 10

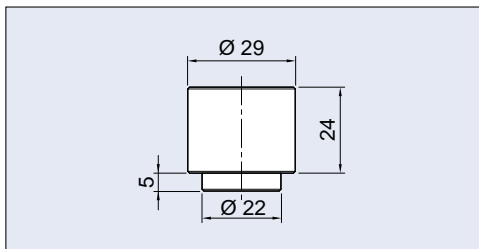

Gripper h24 serrated

Code

58 90 63 20

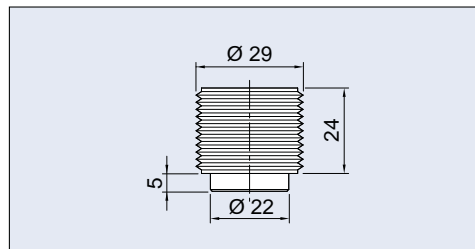

Gripper h11 smooth-serrated

Code

58 90 64 10

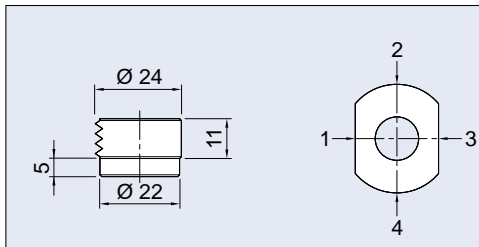

Soft gripper h25 smooth

Code

58 90 65 10

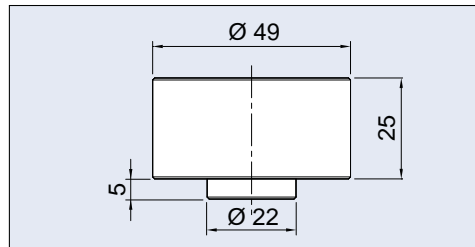

Gripper h50 serrated with adjustable screw

Code

58 90 67 20

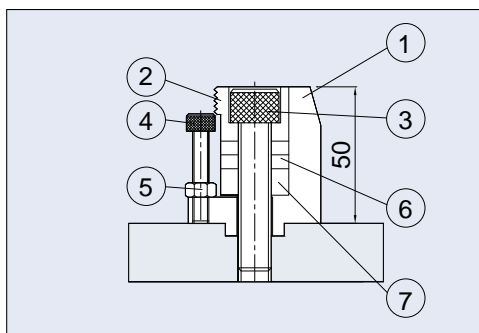

Pos.

Code

Description

1	58 90 51 20	Body
2	58 90 52 20	Serrated gripper
3	71 11 31 09	Screw TCEI M12x60 12.9
4	71 11 30 47	Screw TCEI M6x30 12.9
5	71 15 02 06	Nut M6
6	58 90 54 10	Washer (5 mm)
7	58 90 54 20	Washer (10 mm)

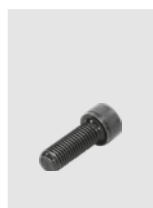

Gripper h50 smooth with step

Code

58 90 68 10

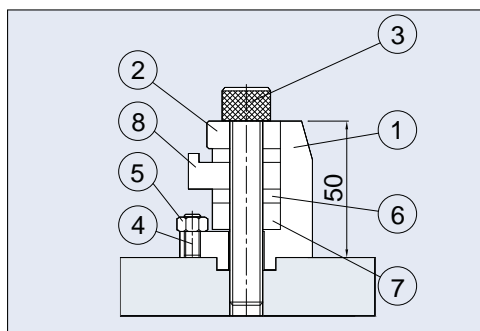

Pos.

Code

Description

1	58 90 51 20	Body
2	58 90 53 10	Smooth gripper
3	71 11 31 10	Screw TCEI M12x70 12.9
4	71 11 21 24	Grub screw M6x16
5	71 15 02 06	Nut M6
6	58 90 54 10	Washer (5 mm)
7	58 90 54 20	Washer (10 mm)
8	58 90 55 10	Step washer

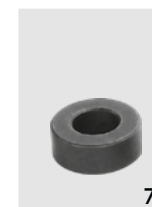
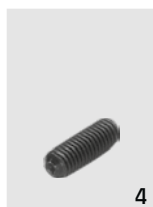

Gripper h50 serrated with step

Code

58 90 68 20

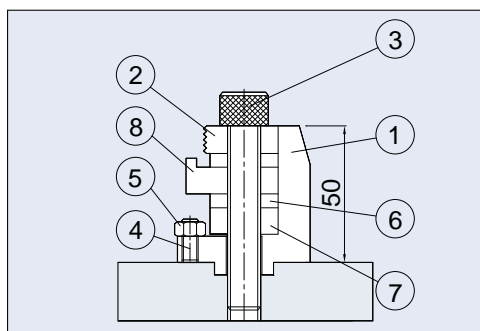

Pos.

Code

Description

1	58 90 51 20	Body
2	58 90 53 20	Serrated gripper
3	71 11 31 10	Screw TCEI M12x70 12.9
4	71 11 21 24	Grub screw M6x16
5	71 15 02 06	Nut M6
6	58 90 54 10	Washer (5 mm)
7	58 90 54 20	Washer (10 mm)
8	58 90 55 10	Step washer

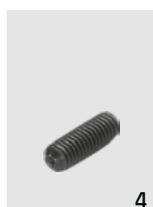

Gripper h25 smooth with adjustable screw

Code

58 90 66 10

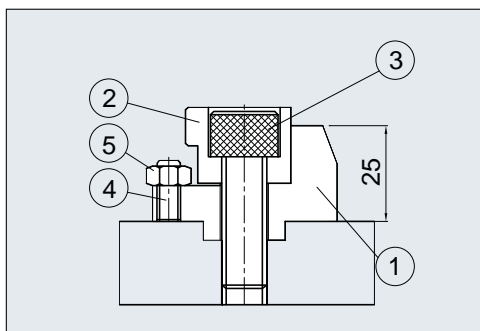

Pos.

Code

Description

1	58 90 51 10	Body
2	58 90 52 10	Smooth gripper
3	71 11 31 05	Screw TCEI M12x3512.9
4	71 11 21 24	Grub screw M6x16
5	71 15 02 06	Nut M6

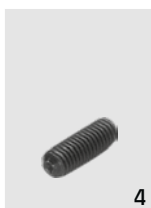

Gripper h25 serrated with adjustable screw

Code

58 90 66 20

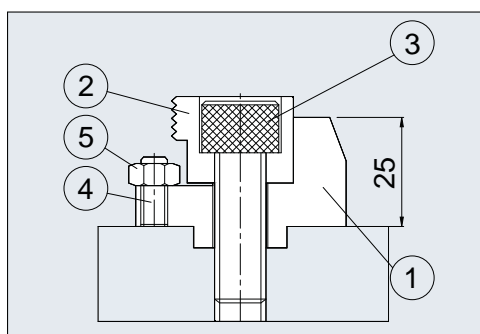

Pos.

Code

Description

1	58 90 51 10	Body
2	58 90 52 20	Serrated gripper
3	71 11 31 05	Screw TCEI M12x35 12.9
4	71 11 21 24	Grub screw M6x16
5	71 15 02 06	Nut M6

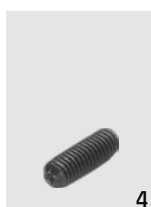

Gripper h50 smooth with adjustable screw

Code

58 90 67 10

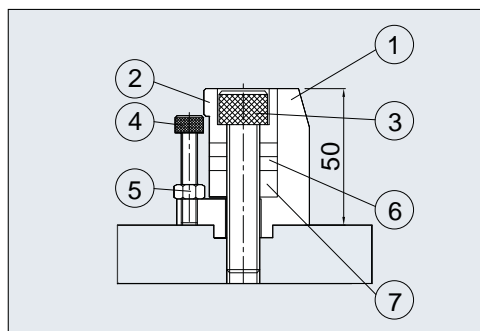

Pos.

Code

Description

1	58 90 51 20	Body
2	58 90 52 10	Smooth gripper
3	71 11 31 09	Screw TCEI M12x60 12.9
4	71 11 30 47	Screw TCEI M6x16
5	71 15 02 06	Nut M6
6	58 90 54 10	Washer (5 mm)
7	58 90 54 20	Washer (10 mm)

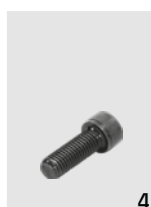

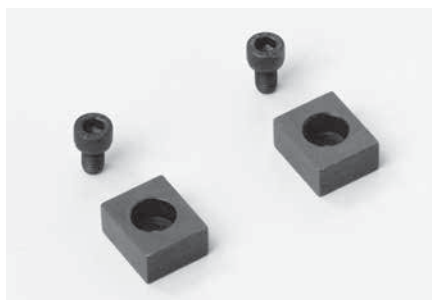

Pair of positioning keys

Cod.	mm	Cod.	mm
58 90 13 92	18 x 12	58 90 13 95	18 x 18
58 90 13 93	18 x 14	58 90 13 96	18 x 20
58 90 13 94	18 x 16	58 90 13 97	18 x 22

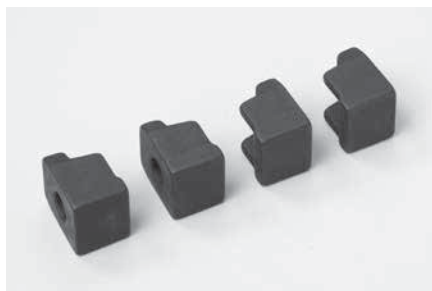

Kit of 4 clamps

Cod.	for type
58 90 27 09	VCP 100 - VP 100
	VCP 130 - VP 130
	VCP 160 - VP 160



Wrench VCP/VP

Cod.	for type
58 90 19 00	VCP 100 - VP 100
	VCP 130 - VP 130
	VCP 160 - VP 160



Wrench VCM/VCA

Cod.	for type
58 90 19 10	VCM 100 - VCA 100
	VCM 130 - VCA 130
	VCM 160 - VCA 160



Torque wrench

Cod.	for type
51 50 10 01	VCM 100 - VCA 100
	VCM 130 - VCA 130
	VCM 160 - VCA 160

Repeatability accuracy for the clamping of model VCA +/- 0,01

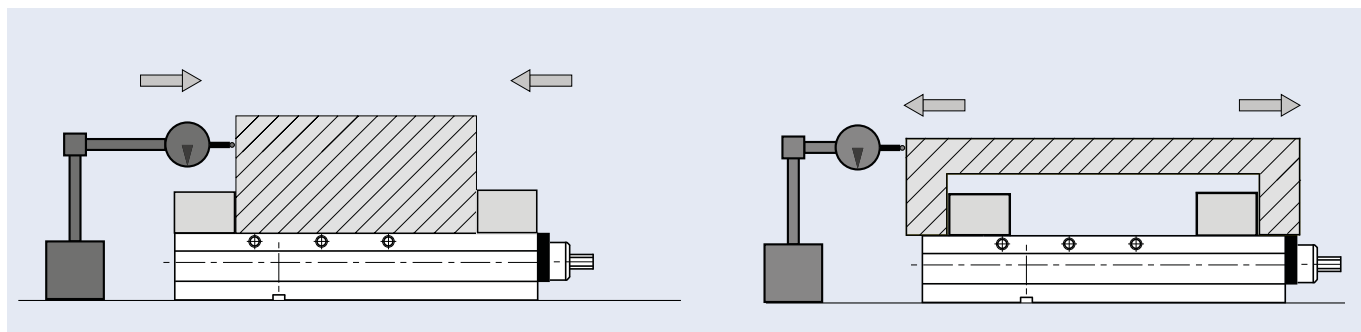

Clamping force diagrams VCA without clamping force multiplier

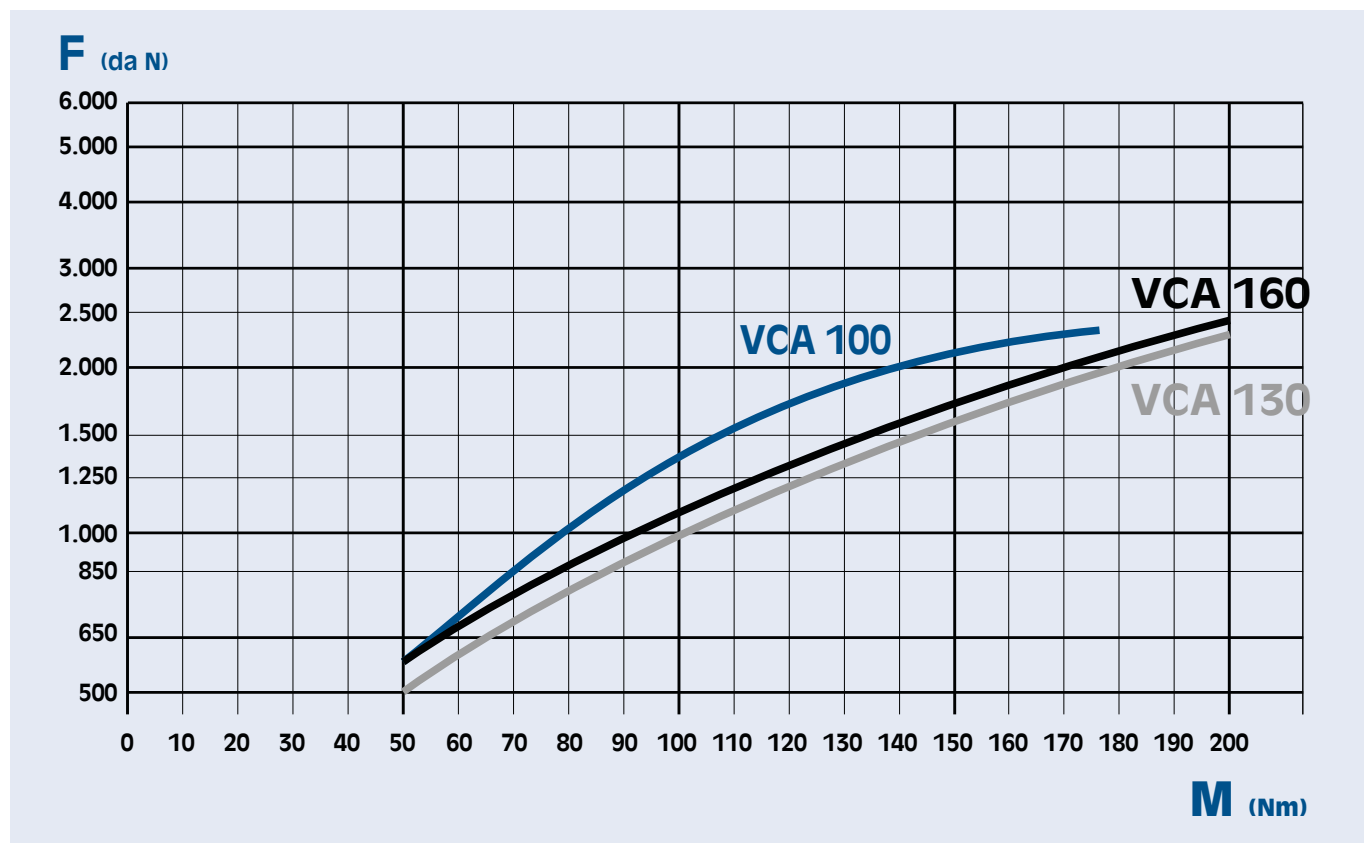

Possible configurations of vices "SELF CENTERING"



With block jaws

With L jaws

With gripper jaws

With floating gripper jaws

Notes

The page features a series of horizontal stripes in two shades of blue, alternating from top to bottom. The stripes are uniform in width and extend across the entire width of the page, providing a structured area for writing notes.

Notes

The page features a series of horizontal stripes in two shades of blue, alternating from top to bottom. The stripes are uniform in width and extend across the entire width of the page, providing a structured area for writing notes.



MODULAR CLAMPING SYSTEMS



SINTERGRIP



APS



FMS



TC



MC



LC



CLAK SYSTEM



GENIUS



CIVI 2000



CAM SYSTEM



HOLDING CLAMPS



VARI CLAMP



DUO - LOCK



JAWS



SC



ST5-2G



FAST CLAMPS



TWIN VISE

CODE 10705874 - printed October 2018



ZIBTR PRO d.o.o.

Tel.: +386 1 896 22 80

Fax: +386 1 896 22 82

Splet: www.zibtr.com