

# Tailor made solutions

*...a real challenge*

▶ *Special tool holders*

▶ *Special inserts*

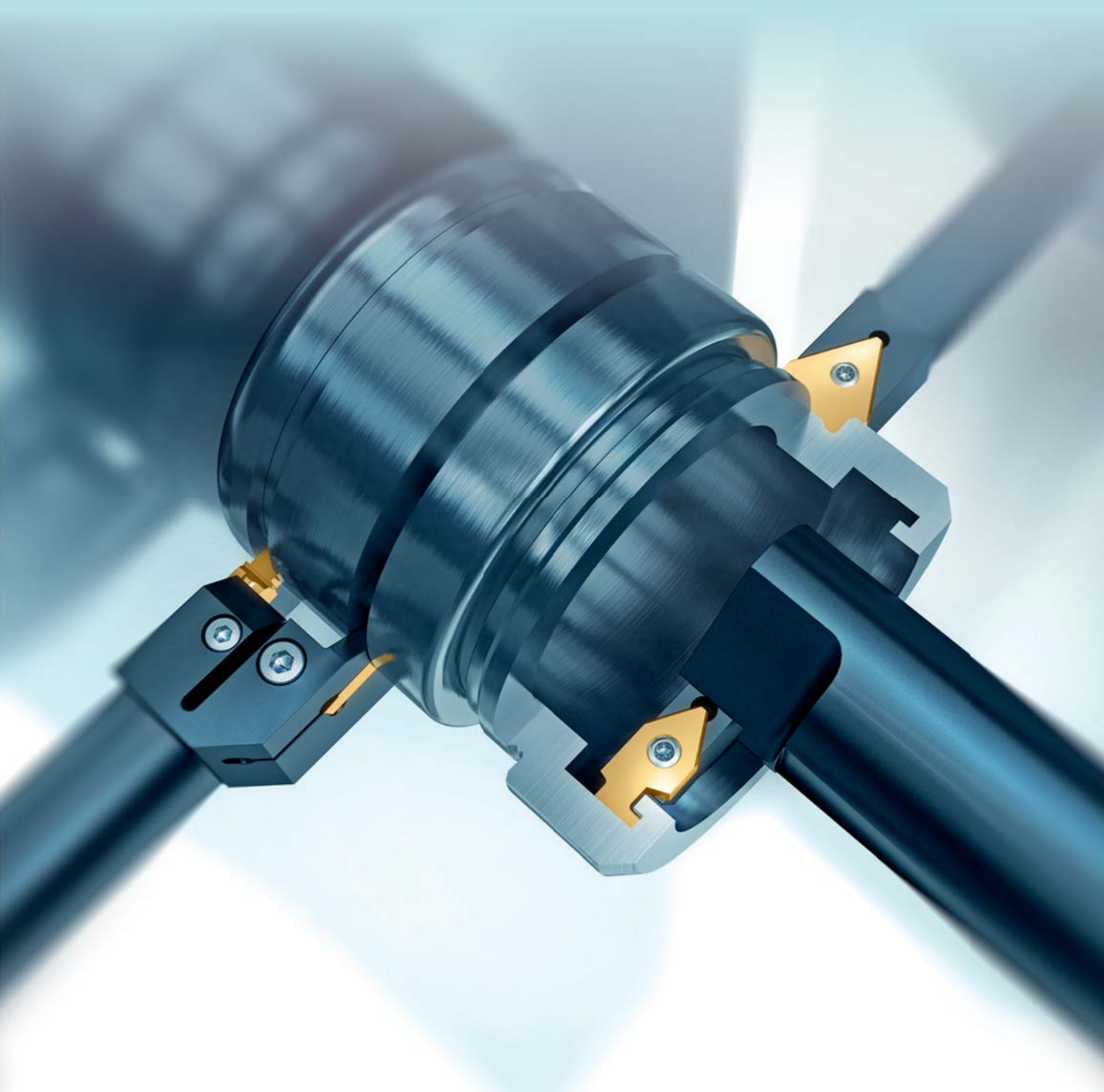

## When and why should tailor made solutions be applied?

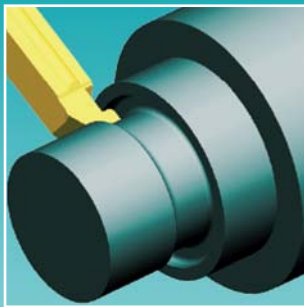

- ▶ when standard tools are not efficient,
- ▶ general cost saving measures,
- ▶ to reduce production time,
- ▶ to save on tool costs.

## Our Strengths

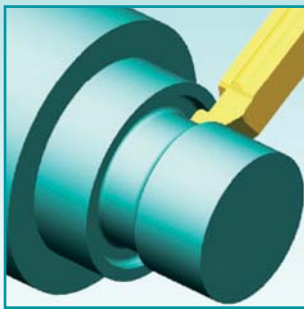

- ▶ Qualified service
- ▶ Specified quotations
- ▶ Fair prices
- ▶ Production on most advanced machine tools
- ▶ Short delivery times



## Tailor made inserts

- ▶ So far more than 3300 different profiles have been ground
- ▶ Manufactured on most advanced machine tools
- ▶ Qualified employees
- ▶ Small quantities can also be made
- ▶ Precise cutting edges (Perfection on the edge)

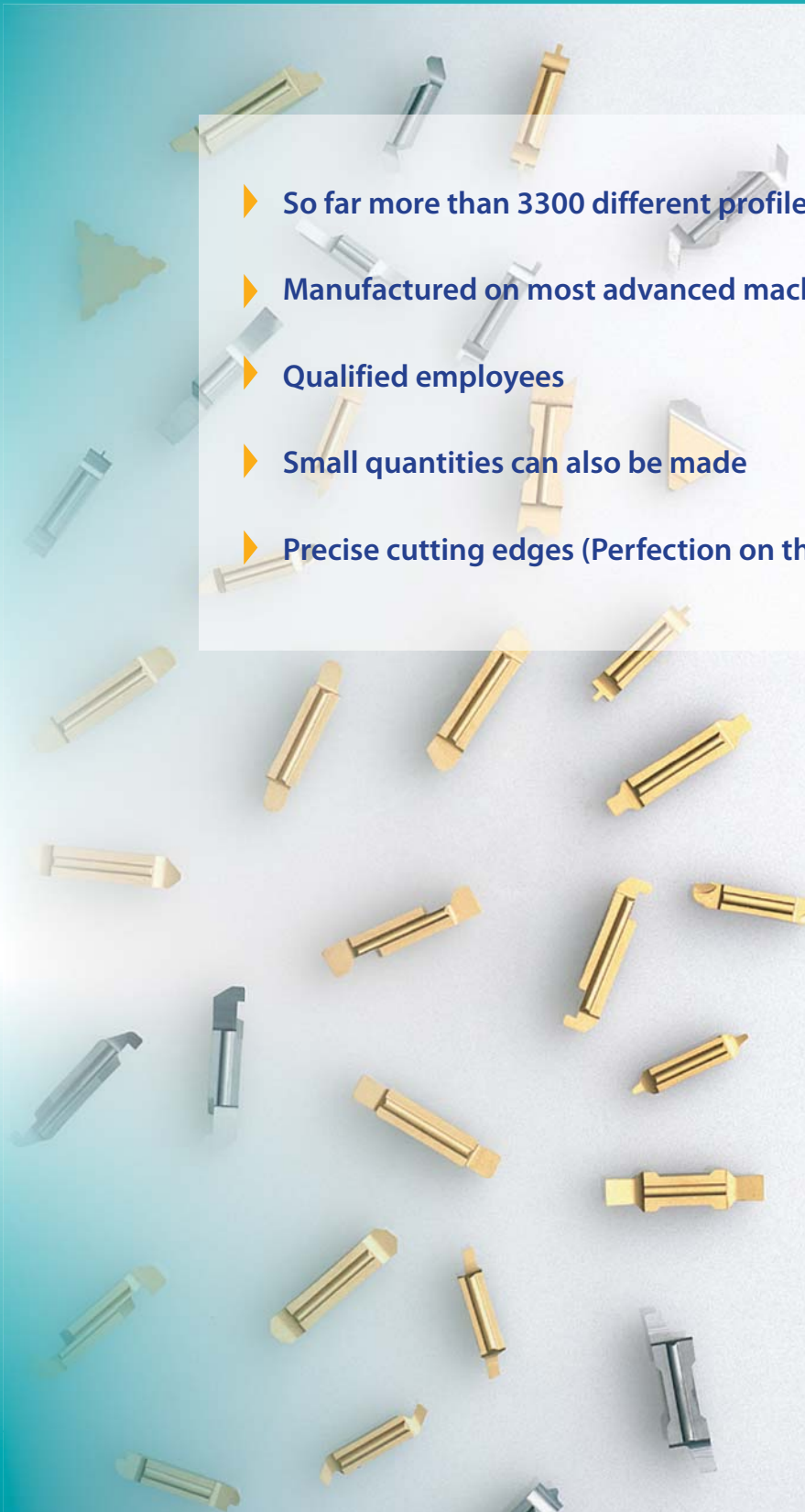

## Tailor made inserts with 2 edges based on P92 and P92-P System

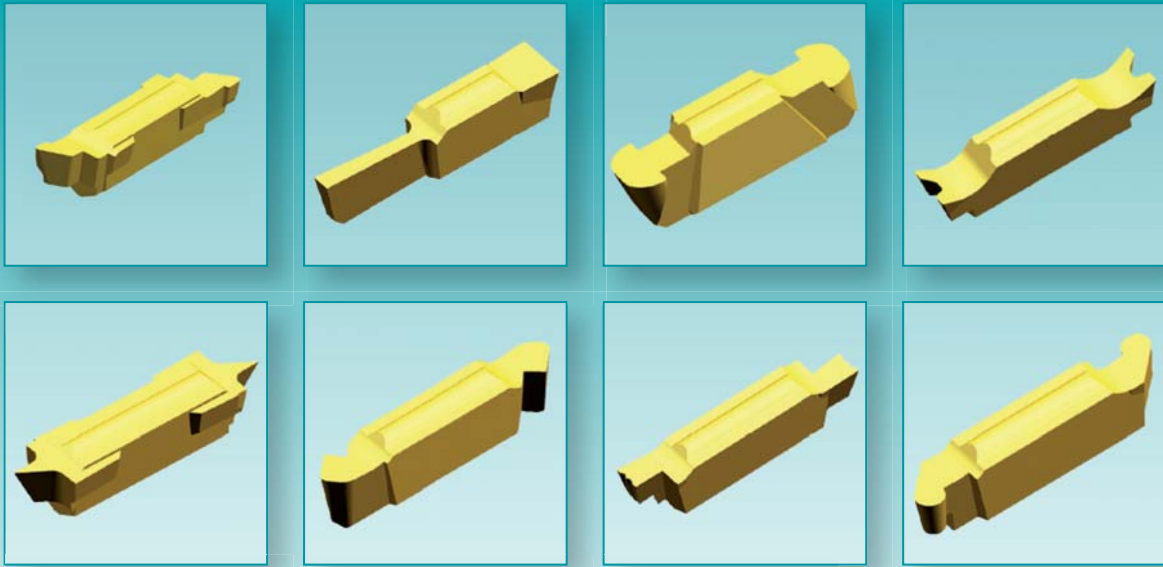

*Special requirements?  
We will fulfill them!*

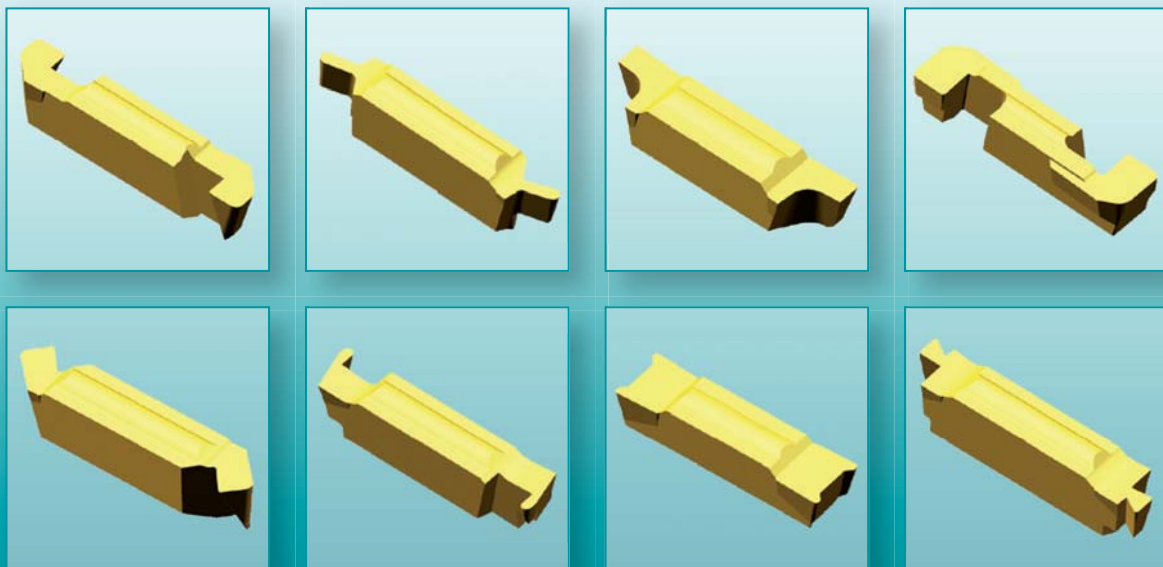

10

## Tailor made insert with 4 edges based on MC4 system

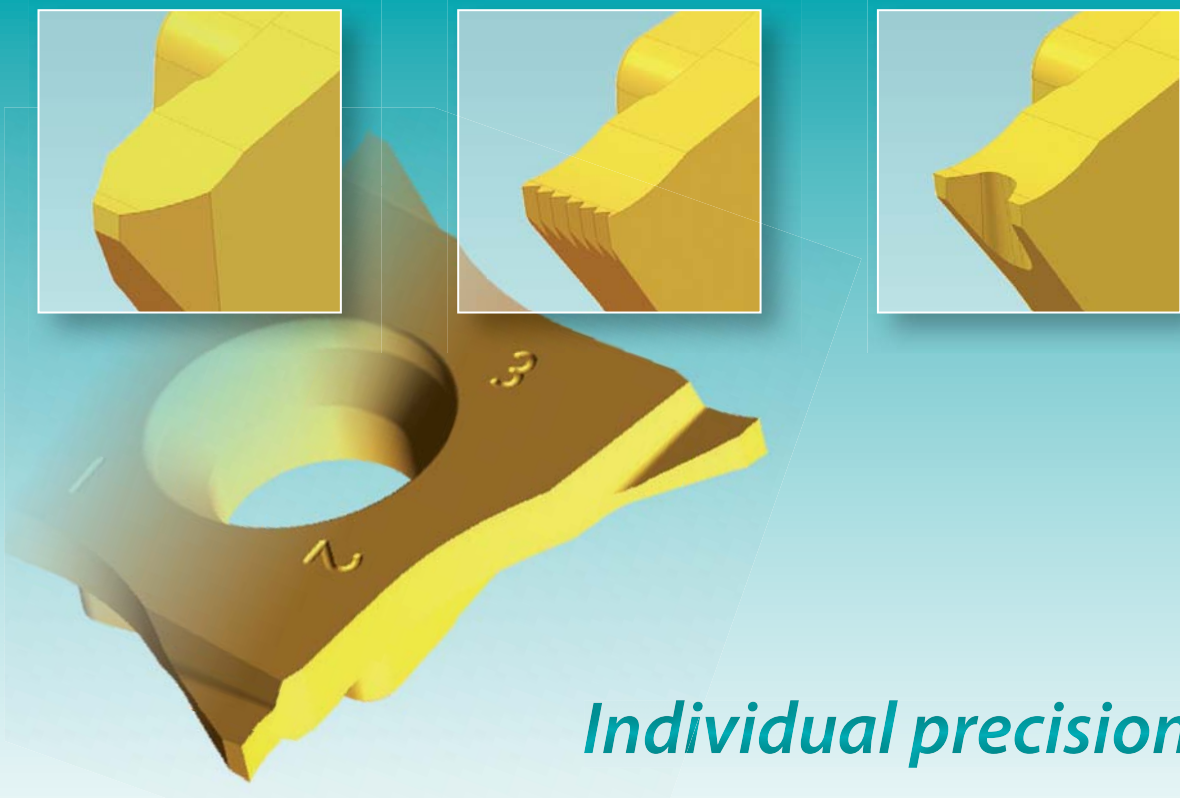

*Individual precision  
on each corner*

## Profile inserts based on F92 system

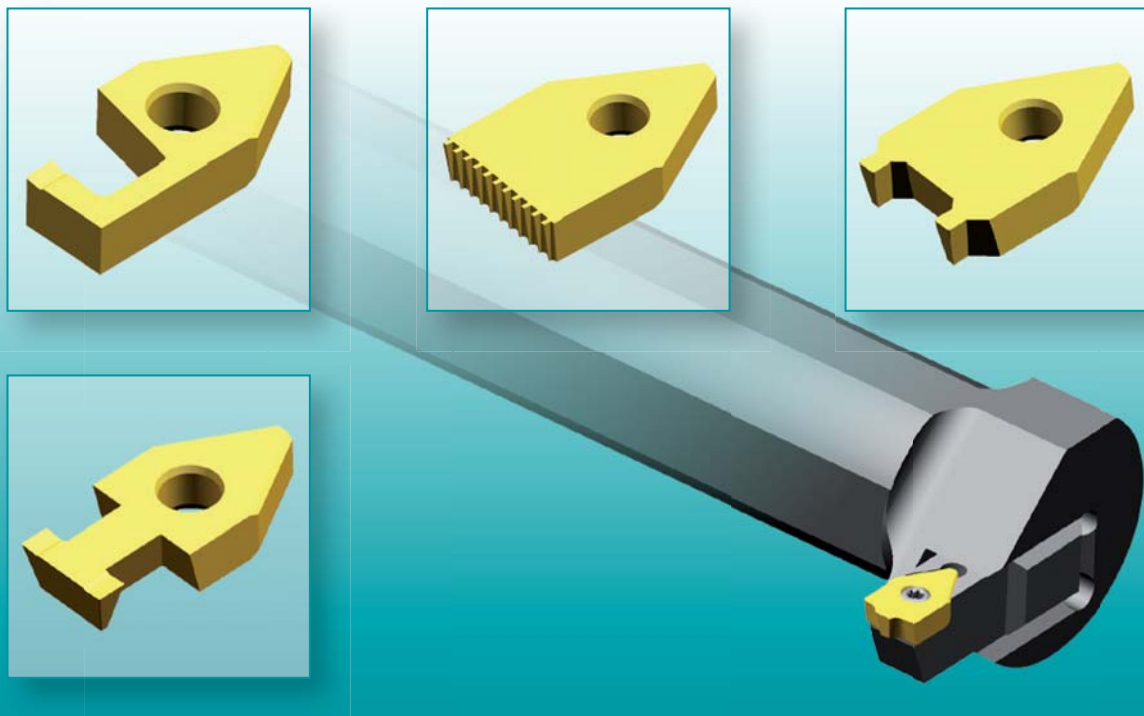

## Special tool holders with inserts



*Sophisticated solutions  
for your requirements*

